

FINAL PROGRAM

Creating Enviably Lives:

THE BUSINESS PLAN CONFERENCE

JUNE 9-12, 2009
NEW ORLEANS, LOUISIANA



American Association
on Intellectual and
Developmental Disabilities



Knowledge | Support | Empowerment

***Welcome to Creating Enviable Lives:
The Business Plan Conference***

Welcome to New Orleans and AAIDD's 133rd Annual Meeting. This is the first time AAIDD has been back to New Orleans since the devastation of Hurricane Katrina. I hope you take advantage of this opportunity to explore the city and see what has been accomplished, and what remains to be done.



Our program this year includes interactive cafes that have round-tables for discussions with leaders, poster presentations where there will be a chance for you to share research and practice ideas and expertise directly and resource areas to share materials you have developed. We are offering plenary sessions on: Employment; Leadership for Self Advocates by self-advocates; Emergency Preparedness; Managing creatively; and Succession Planning. They all promise to be stimulating and feature engaging presenters.

AAIDD has significant and ongoing roles in the field of intellectual and developmental disabilities. While we can all appreciate the tremendous progress our field has made in the recent past you only have to read the newspaper, watch the news or browse blogs to know that there are significant obstacles to an "Enviable Life" for far too many people with intellectual and developmental disabilities. Therefore, it is especially timely that the conference committee, led with distinction by Joanna Pierson, provides us with the opportunity to hear current thinking for successful researchers, practitioners and advocates in the areas where our association, and its members, can make an impact. We are also excited by the increased participation of the next generation of professional leaders in our field. They are AAIDD's and our field's futures, and we need to support their growth and nurture their development. We also need to listen to what they have to say and to learn when best to 'get out of the way!'"

AAIDD is proud to provide the leadership for professionals in our field, as it has for the past 133 years. Working collaboratively with other national organizations that share a focus on intellectual and developmental disabilities AAIDD helps facilitate efforts for meaningful change. Working together, especially in the first year of a new Presidential Administration, is especially important.

This conference brings together leaders in the field of intellectual and developmental disabilities and others eager to learn from them. Each of us has the opportunity to gain new insights, learn new information, meet new colleagues, and enhance the networks that support our professional growth. Thank you for coming. I look forward to meeting you.

A handwritten signature in black ink, which appears to read "S. M. Eidelman". The signature is fluid and cursive, with a long horizontal line extending to the right.

Steven M. Eidelman, FAAIDD
AAIDD President



Welcome to *Creating Enviable Lives: The Business Plan Conference*, and welcome to New Orleans! I am delighted that you have joined us here. I hope that you will find the next few days an exciting learning and networking experience.

Creating "Enviable Lives" is about listening to how people with intellectual and developmental disabilities want to live their lives and then providing the supports and services that people require for this to happen. We need a "Business Plan" in order to make this happen for each and every person rather than just for a small group of people. As part of this "Business Plan", we need research, practice, and policy models that move this forward. We need excellent research to help us figure out the myriad of ways to help this happen. We need excellent practitioner models to ensure that we can translate the research into action and develop numerous new and creative ways to continually get better at supporting people without neglecting to provide skill building and specialized services such as therapies that are needed. We also need to continually advance our techniques for skills learning and therapies. We need excellent policy that supports these efforts, recognizing that there are different types of expenses involved if these efforts are to happen for each and every person. And finally, to be successful, we must create this "Business Plan" so that we not only support people with intellectual and developmental disabilities, but their families and communities as well.

This conference is designed to jumpstart ongoing dialogue on creating Enviable Lives for people with intellectual and developmental disabilities. As the current generation of leaders retires and we move forward in the ways that we provide supports and services, it becomes even more important that we share programmatic knowledge.

The conference format has Interactive Cafés, Panel Presentations, and Plenary Sessions. The latter two are more traditional conference formats, so I will not waste your time explaining them here. The Interactive Cafés are a new format. These include both roundtables and posters. There are "Meet a Leader" roundtables where you can meet many of the current leaders in the field in a casual setting to ask them questions and learn about their work. At the other roundtables there are panels, a smaller, more casual way than traditional panel presentations for you to learn about the presenters' work and ask questions. You will find the posters, which may be traditional posters or short laptop computer presentations, a great way to interact with colleagues who share your interests in Assistive Technology, Communication, Employment, Emergency Preparedness, Families, Health, ID Definition and Support, Innovative Leadership Practices in Agencies, Leadership Training for Self-Advocates, Mental Health and Behavioral Supports, Positive Behavioral Support, Post Secondary Education, Quality, Self Determination, Social Inclusion, and Succession Planning.

I hope that you find the conference provides you a chance to develop relationships with new colleagues that continue into the future as we work together to create Enviable Lives.

Thank you for attending. I look forward to meeting you!

A handwritten signature in black ink that reads "Joanna Pierson". The signature is fluid and cursive, with a long horizontal line extending to the right.

Joanna Pierson, Ph.D., FAAIDD
President Elect and Program Chair

Welcome to New Orleans!

Welcome to one of the most exciting cities on the globe. The Crescent City, so named because it is nestled in a bend of the mighty Mississippi River, offers a unique urban adventure featuring a diversity of architecture, culture, and cuisine. The city offers an array of sights, sounds, and tastes guaranteed to enchant you.

New Orleans began in 1717 as a mere flicker in the eyes of the French. By the time she became an American citizen, she was quite famous, and she grew up to be the European Queen of the Mississippi.

Begin your free mornings with a steaming cup of café au lait. Sample a hot beignet and watch the artists begin to gather at Jackson Square. Meander through the French Quarter or stroll down Royal Street.

For an exciting afternoon, climb aboard the St. Charles Avenue Streetcar for a rollicking ramble to the garden District and Audubon Park and Zoo. Take a paddlewheel steamboat excursion on the muddy Mississippi or visit the Aquarium of the Americas and IMAX Theater.

Tour the Louisiana Superdome, the Louisiana Nature and Science Center, and the New Orleans Museum of Art in City Park. Try a jazzy New Orleans brunch that combines New Orleans' own unique cuisine such as crawfish etouffee, gumbo, and shrimp creole with cool blues and hot jazz.

Go gently into the night with a romantic horse-drawn carriage. Dine in fabulous restaurants. Dream along the River on a dinner-jazz steamboat cruise. Visit Bourbon Street and experience the intoxicating sounds of Dixieland Jazz and New Orleans Blues. See a show or a concert at one of the New Orleans' modern theatres.

In addition to the many opportunities to visit the city, be sure to join us on Tuesday night for a Welcome Reception and Wednesday night for Movie Night.

This very unique city and the State of Louisiana looks forward to Creating Envable Lives with AAIDD. If there is anything we can do to make your stay more enjoyable, please do not hesitate to let us know. Now sit back and get ready to Laissez Les Bon Temps Rouler (Let the Good Times Roll).



LOUISIANA LOCAL ARRANGEMENTS COMMITTEE

Sharon Gomez

Hilda Trahan

Yvonne Miller-Nixon

Chrys Vildibill

Sharon Delvisco

Elizabeth Kurfiss-Watts

Roni Jo Frazier

Creating Enviable Lives

Registration Schedule

Tuesday..... 11:30 am–4:30 pm
Wednesday 7:00 am–4:30 pm
Thursday 7:00 am–3:30 pm
Friday..... 8:00 am–1:30 pm

Exhibit Schedule

Wednesday 7:30 am–5:00 pm
Thursday 7:30 am–1:30 pm

AAIDD Open Annual Membership Meeting and Leadership Forum

Tuesday, June 9
10:00 am–12:00 noon
Salon I

THE BUSINESS PLAN CONFERENCE

2009 Award Recipients

INTERNATIONAL AWARDS

Erik W. Carter, PhD
Early Career Award

Yona J. Lunsky, PhD
Early Career Award

Mian Wang, PhD
Early Career Award

James R. Patton, EdD
Education Award

Peter J. Mittler, PhD
International Award

Wendy M. Nehring, RN, PhD
Leadership Award

Paul H. Brookes Publishing Company
Media Award

Marsha Mailick Seltzer, PhD
Research Award

John J. McGee, PhD
Service Award

Judith M. S. Gross
Student Award

Contents

- 4 Program-at-a-glance
- 5 Annual Meeting Sponsors
- 6 Meeting Space Floor Plans
- 7 Pre-Conference Professional Workshops
- 7 Annual Meeting Program
- 9 Opening Session
- 9 Presidential Address
- Plenary Sessions**
 - 9 Employment
 - 11 Leadership Training for Self-Advocates
 - 15 Emergency Preparedness
 - 19 Managing Agencies for Change
 - 20 Succession Planning
- 20 Religion and Spirituality Division Forum
- 21 Post-Conference Professional Workshops
- 22 Psychology Division & Mental Health SIG Seminar
- 25 Business Meetings
- 25 General Information
- 26 Guide to Exhibitors

PROGRAM-AT-A-GLANCE

Morning

TUESDAY, JUNE 9

**AAIDD
Open Annual
Membership Meeting
and Leadership Forum**
10:00 am–12:00 noon

Lunch on your own
12:00 pm–1:00 pm

WEDNESDAY, JUNE 10

New Attendees Meeting
7:00 am–7:30 am

Business Meetings
7:30 am–8:30 am

Continental Breakfast
7:00 am–8:30 am

**Meet a Leader
Roundtables**
7:30 am–8:30 am

**Presidential Address
and Opening Session**
8:30 am–10:00 am

**PLENARY 1:
Employment**
10:00 am–11:30 am

Break
11:30 am–11:45 am

**(2) Interactive Cafés
(1) Panel Presentation
The Academy Breakout**
11:45 am–1:15 pm

Lunch Provided
11:30 am

THURSDAY, JUNE 11

Business Meetings
7:30 am–8:30 am

Continental Breakfast
7:00 am–8:30 am

**Meet a Leader
Roundtables**
7:30 am–8:30 am

**PLENARY 3:
Emergency Preparedness**
8:30 am–10:00 am

Break
10:00 am–10:15 am

(3) Breakouts
10:20 am–12:00 noon

**(2) Interactive Cafés
(1) Panel Presentation
The Academy Breakout**
10:15 am–11:45 pm

Student Lunch Meeting
11:45 am–12:45 pm

Lunch on your own
12:00 pm–1:15 pm

FRIDAY, JUNE 12

Business Meetings
7:30 am–8:30 am

Morning Workshops
9:00 am–12:00 noon

Full Day Workshop
9:00 am–4:00 pm

**Religion & Spirituality
Forum**
9:00 am–12:00 noon

**Special Symposium on
Succession Planning**
9:00 am–12:00 noon

Afternoon

**The Assembly
The Conference**
1:15 pm–5:00 pm

**Pre-conference
Workshops**
1:00 pm–4:00 pm

**PLENARY 2:
Leadership Training
for Self-Advocates**
1:30 pm–3:00 pm

Break
3:00 pm–3:15 pm

**(2) Interactive Cafés
(1) Panel Presentation
The Academy Breakout**
3:15 pm–4:45 pm

Panel Presentations
4:45 pm–5:45 pm

**(2) Interactive Cafés
(1) Panel Presentation
The Academy Breakout**
12:45 pm–2:15 pm

Break
2:15 pm–2:30 pm

**PLENARY 4:
Managing Agencies
for Change**
2:45 pm–3:00 pm

**PLENARY SESSION
on Succession Planning**
4:15 pm–5:30 pm

**Afternoon
Workshops**
1:00 pm–4:00 pm

Evening

Welcome Reception
6:00 pm–7:30 pm

Movie Night
8:00 pm

**Religion and Spirituality
Division Dinner**
6:00 pm

registration schedule

Tuesday 11:30 am–4:30 pm
Wednesday 7:00 am–4:30 pm

Thursday 7:00 am–3:30 pm
Friday 8:00 am–1:30 pm

exhibit schedule

Wednesday 7:30 am–5:00 pm
Thursday 7:30 am–1:30 pm

Thank you to our generous sponsors...



PLATINUM SPONSOR:

Service Coordination

Service Coordination is a nonprofit agency in Maryland that assists individuals with intellectual and developmental disabilities in determining and meeting their needs in ways they prefer. Our mission is to help individuals become active members of their communities with equal rights and responsibilities and to help people develop and obtain high quality supports and services that are the least intrusive to meet their desires and needs and support their personal goals. Please visit us at www.servicecoordinationinc.org and follow us on Twitter: <http://twitter.com/SCInc>.

GOLD SPONSOR:

Sterling Pharmacy & Therapy Services

www.sterlingassoc.com

SILVER SPONSORS:

The MENTOR Network

www.thementornetwork.com

TASH

www.tash.org

BRONZE SPONSORS:

AAIDD Louisiana Chapter

AAIDD New Jersey Chapter

AAIDD Region 5

Chapters: Arkansas, Kansas, Louisiana, Missouri, Oklahoma, Texas

AAIDD Region 9

Chapters: Bermuda, Delaware, District of Columbia, Maryland, New Jersey, Pennsylvania, Virginia, West Virginia

St. Genevieve Health Care Services, Inc

www.sghealthcare.com

Human Service Connections

www.humanserviceconnections.com

Annual Meeting Bags Provided by:

Gulf Coast Teaching Family Services

www.gctfs.org

The Ritz-Carlton, New Orleans

921 Canal Street
 New Orleans, LA 70112
 Phone: 504-524-1331

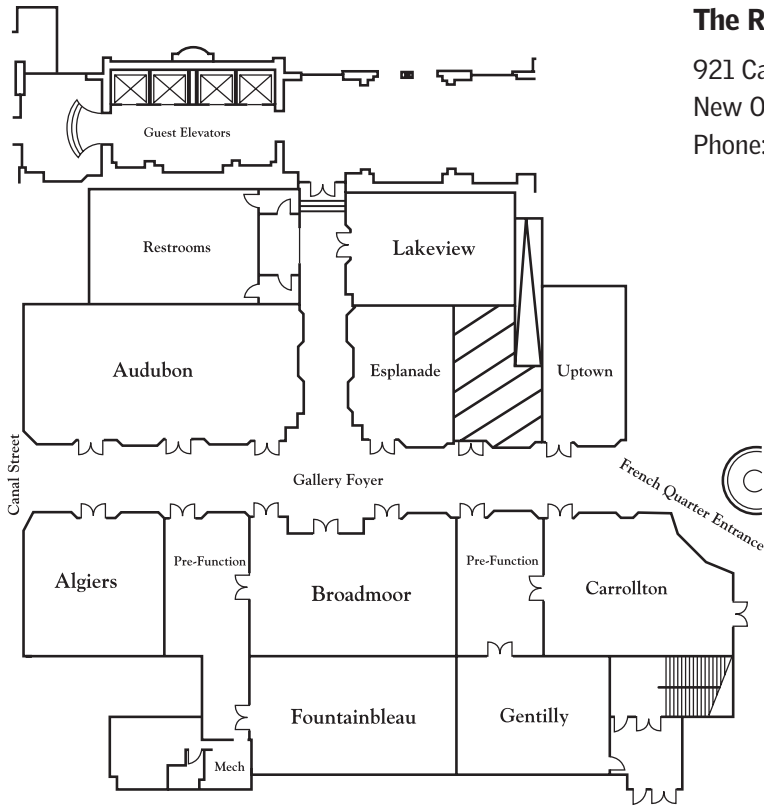

FIRST FLOOR, Level 1

SECOND FLOOR MEETING SPACE

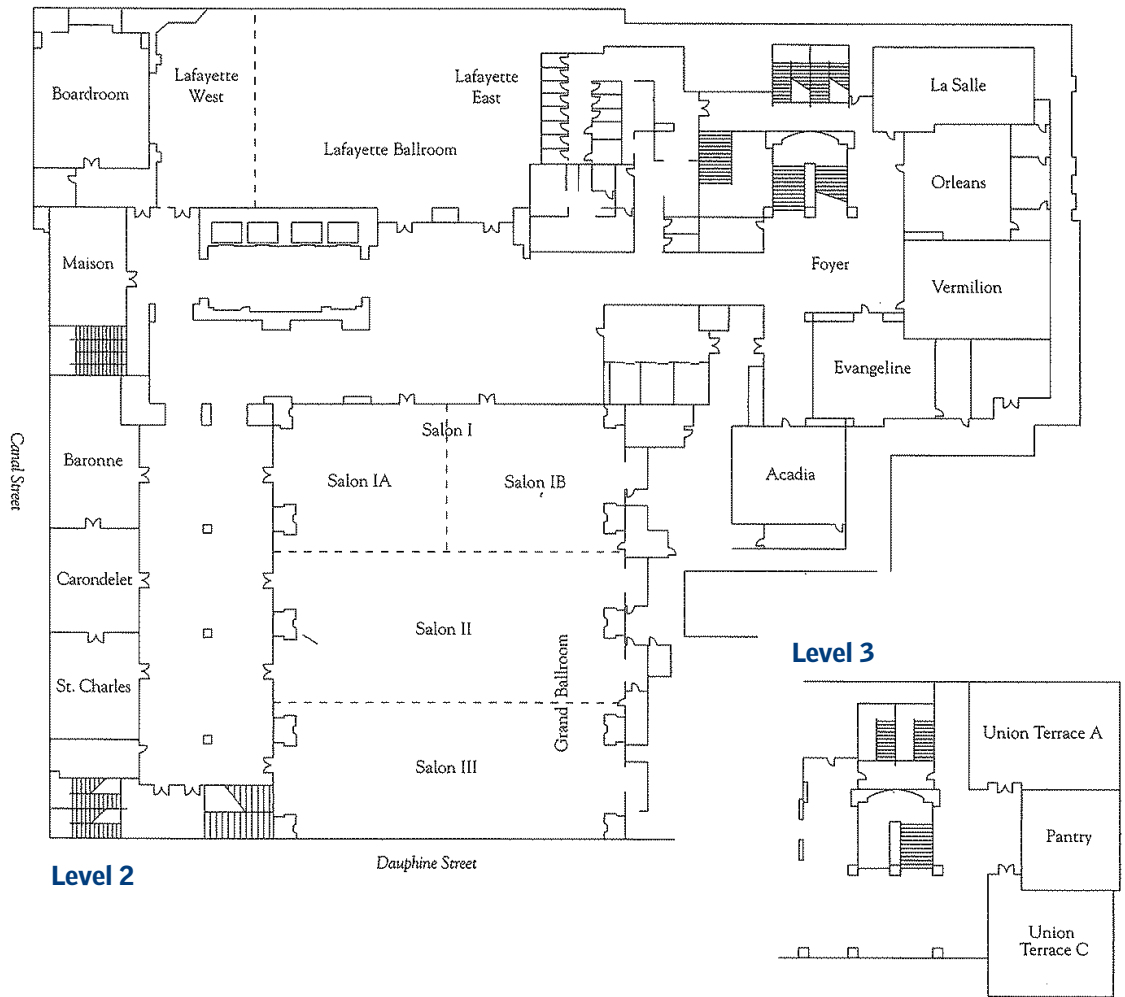

Level 2

Level 3

Monday, June 8

5:00 pm–8:00 pm

Board of Directors Meeting

Presiding: Steven Eidelman, FAAIDD, AAIDD President
Room: Vermilion

Tuesday, June 9

Registration
11:30 am–4:30 pm

10:00 am–12:00 noon

Annual Open Membership Meeting and Leadership Forum

Presiding: Steven Eidelman, FAAIDD, AAIDD President
Room: Salon I

12:00–1:00 pm

Lunch on Your Own

1:00–4:00 pm

WORKSHOP #1

Developing a Disaster Plan: Recovering From the Aftermath

Larry Weishaar, ResCare Inc; Sharon Gomez, Evergreen Presbyterian Ministries Inc, and Mark Yeager, PhD, MS Department of Mental Health

Three providers describe their agencies experiences during Gulf Hurricanes and elaborate lessons learned.

Room: Evangeline

1:00–4:00 pm

SIS Training Workshop Session

SIS: From Theory to Practice

Natalie Ihli

This 3-hour session is a review of the new Supplemental Guidelines in Scoring and Administering SIS. AAIDD trainer, Natalie Ihli, will explore lessons learned from the last four years of training. She will share discoveries on best practices to conduct an SIS interview more effectively and ways to use SIS information in planning.

Room: Vermilion

1:15–5:00 pm

The Assembly of Geographic Interests Meeting

Presiding: Joanna Pierson, PhD, AAIDD President-Elect
Room: La Salle

1:15–5:00 pm

The Conference of Professional Interests

Presiding: Michael Wehmeyer, PhD, AAIDD Vice President

Room: Orleans

Welcome Reception

Tuesday Evening • 6:00–7:30 pm

The AAIDD Leadership and the Local Arrangements Committee welcome you to the 133rd Annual Meeting.

Sponsored by Sterling Pharmacy & Therapy Services

Room: Lafayette

Students and Early Career Professionals Activities

AAIDD welcomes all students and early career professionals. We encourage you to look in your program to find highlighted activities and to read your brochures about the Student and Early Career Professionals Committee. Also, you will see individuals wearing tags which say, "I support early careers." These are AAIDD members committed to answering questions and sharing information with you."

Student/Early Career Reception

Tuesday • 8:30 pm

(Look for location/time posted at registration)

Happy Hour

Wednesday • 8:00 pm

(Look for location/time posted at registration)

Lunch Meeting

Thursday • 11:45 am

Tickets are required and they will be available at the registration desk

Student/EC friendly presentation:

Students and Early Career Professionals Session

Thursday morning • 7:30 am–8:30 am

Wednesday, June 10

Registration
7:00 am–4:30 pm

Tabletop Exhibit Hours
7:30 am–5:00 pm

7:00 –8:30 am

Complimentary Continental Breakfast

Sponsored by the AAIDD Region 5

7:00–7:30 am

New Attendees Meeting

Presiding: Joanna Pierson, President-Elect

Room: Vermilion

7:30–8:30 am

Editorial Advisory Committee

Presiding: Steven Warren

Room: Broadmoor

7:30–8:30 am

Gerontology Division

Presiding: Elizabeth Perkins

Room: Algiers

7:30–8:30 am

Social and Sexual Concerns Special Interest Group Meeting

Presiding: Leslie Walker-Hirsch

Room: Fountainbleau

7:30–8:30 am

ADAPTIVE BEHAVIOR PANEL

Adaptive Behavior and the Diagnosis of Intellectual Disability

- AAIDD Diagnostic Adaptive Behavior Scale
- History and Overview of Adaptive Behavior Assessment
- Current Issues and Concerns Regarding the Assessment of Adaptive Behavior
- Presentation of the AAIDD Diagnostic Adaptive Behavior Scale

Marc J. Tassé, University of South Florida; Robert L. Schalock, Bob Schalock & Associates; Giulia Balboni, Università Della Valle d'Aosta; Hank Alexander Bersani, Teaching Research Institute, Western Oregon University; Sharon A. Duffy, University of California at Riverside; Julia Scherba de Valenzuela, University of New Mexico; Scott Spreat, Woodland Center for Challenging Behaviors; David M. Thissen, University of North Carolina at Chapel Hill; Keith F. Widaman, University of California at Davis; Dalun Zhang, Texas A&M University

Room: Salon IA

7:30–8:30 am

MEET A LEADER EDUCATION ROUNDTABLE

Strategies for Building Successful Win-Win Partnerships Between Public Schools and Universities

Ruth Luckasson, JD, University of New Mexico

Room: Salon II & III Foyer

7:30–8:30 am

MEET A LEADER COMMUNITY CONNECTIONS ROUNDTABLE

Agency Factors Influencing Social Inclusion: Why Are Some Individuals More Included than Others?

Round Table Leader: Angela Novak Amado, PhD, University of Minnesota

Room: Salon IB

7:30–8:30 am

SELF DETERMINATION INTERACTIVE CAFÉ

Room: Salon III

Round Tables Panels:

Table #1

Supporting Enviable Lives through Great Direct Support: New Jersey's Career Path

Colleen McLaughlin and Bill Gaventa, The Elizabeth M. Boggs Center on Developmental Disabilities - UCEDD

Table #2

Challenging Behaviour, Fourcalt, and Disability Theorists

Ian McPhail Flaherty, Drug and Alcohol Multicultural Education Centre

Perceptions of Korean Students with Disabilities, Parents and Teachers on Self-Determination: Cultural Understanding and Application

Suk-Hyang Lee, Ewha Women's University

Poster #1

Emerging Technologies and their Applications to Professional Organizations and Supporting People with Intellectual Disability

Karrie Shogren, PhD, The University of Texas at Austin; David Angelow, Business Foundations

Poster #2

Person-Centered Planning and Life Coaching: A Comparison to Address the Challenges of Large Scale Delivery

Kevin Dierks, Center on Disability Studies

Poster #3

Promoting Self-Determination in Young Children as a School Readiness

Hyun-jeong Cho, Beach Center on Disability

Poster #4

Self Determination—A Multi-Pronged Approach

Renae Kosmides, Todd Wilson, Kari Borgealt, Irener Phillips, Service Coordination, Inc

Poster #5

Supporting Self Determination Through the Medicaid Waiver: Self Advocates as Decision-Makers

Zolinda Stoneman and Patty Cassidy, IHDD/UCEDD University of Georgia; Jenny Manders, Institute on Human Development University of Georgia

Poster #6

The Portfolio as a Self Determination Tool for Youth Transitioning from Institutions to Family Homes

Katy Gregg, Casey Childers, Zolinda Stoneman, Mary Rugg, IHDD/UCEDD University of Georgia

Poster #7

Identifying and Defining the Components and Indicators of Participant Direction of Supports and Services

Judith Gross, Beach Center on Disability, University of Kansas

Poster #8

Next Step to Equality—An Advocacy Perspective

Ethan Ellis, Next Step

Poster #9

How to Become a Self-Advocate

Patricia Harmon

Poster #10

The "Real World": An Innovative Approach to Learning to Live Independently

Jennifer Blakeslee and Matthew Campbell, The Arc of Frederick County

WEDNESDAY, JUNE 10

10:00–11:30 am

PLENARY SESSION ON EMPLOYMENT

Moderator: William E. Kiernan, PhD

Presentation of AAIDD Awards by J. Carolyn Graff, PhD

Early Career: Erik W. Carter, PhD; Yona J. Lunsy, PhD; Mian Wang, PhD

Student: Judith M.S. Gross

Employment First: Realities and Expectations

William E. Kiernan, PhD, Institute for Community Inclusion-University of Massachusetts Boston;

Charles Moseley, EdD, National Association of Directors of Developmental Disabilities Services

Kathy Kliebert, LCSW, Office for Citizens with Developmental Disabilities Department of Health & Hospitals, Eva M. Belcas, Access to Meaningful Employment (AcME)

Room: Salon I & II

WEDNESDAY, JUNE 10

Opening Session

8:30–9:15 am

Welcome: Steven Eidelman, FAAIDD President

Mayor's Welcome to New Orleans

Welcome from the Office of Citizens with Developmental Disabilities: Kathy Kliebert

Recognition of Terminology and Classification Committee Members

Recognition of the AAIDD Fellows and 30 year members

Presidential Award: Paul A. Marchand

Greetings: Joanna Pierson, PhD, FAAIDD President-Elect and Program Chair

Presentation of the student papers and scholarship winners:

Cameron L. Neece of UCLA Dept of Psychology
Sayed Ali Samadi of the University of Ulster at Jordonstown

Enviabl Lives Award:

Rud and Ann Turnbull in memory of Jay Turnbull

Room: Salon I & II

WEDNESDAY, JUNE 10

Presidential Address

9:15–10:00 am

Introduction by: K. Charlie Lakin, PhD

"Paying it Forward...What We Owe to Those Who Come After Us"

Steve Eidelman, FAAIDD, H. Rodney Sharp Professor of Human Services Policy and Leadership Department of Human Development and Family Studies College of Education and Public Policy Co-Director National Leadership Consortium on Developmental Disabilities University of Delaware

Room: Salon I & II

Wednesday *(continued)*

11:30–11:45 am

Break

Box lunches will be provided in the registration area (Take your lunch to a session)

11:45 am–1:15 pm

EMERGENCY PREPAREDNESS SESSION

Living in Emergency: People with Intellectual Disabilities and Daily Preparedness

Amir Azulay, Hamama; Dalia Nissim, Israel Ministry of Welfare

Individuals with Disabilities and Sheltering

Laura Stough, PhD, Texas A&M University, Center on Disability Development

Room: Salon II

11:45 am–1:15 pm

ACADEMY SESSION

Literacy-Related Barriers to Parental Involvement in the Development and Education of Children with Disabilities

Dolores Acevedo-Garcia, Harvard School of Public Health; Carmen Gomez Mandic, University of Wisconsin-Madison

Living a Healthy Lifestyle: Preliminary Results from a Study of a Health Promotion Program

Willi Horner-Johnson, Oregon Health & Science University

Relationships between parenting stress and child behavior among children with and without ID: An examination across time

Cameron Neece, UCLA

Room: Salon I

11:45 am–1:15 pm

EMPLOYMENT AND POST SECONDARY EDUCATION INTERACTIVE CAFÉ

Room: Salon III

EMPLOYMENT

Table #1:

Employment Meet a Leader RoundTable

William Kiernan, PhD, Institute for Community Inclusion, University of Massachusetts Boston

Poster#1

Empowerment Through Employment

Tova Berkley, Israel Elwyn

Poster #2

Accessing Community Transportation, Inc.: A Peer Travel Training Self-Directed Support Corporation

John Susa, Paul V. Sherlock Center on Disabilities, Rhode Island Hospital

Poster #3

Using Hope’s Ingredients

Aaron Stephens, The Arc of Frederick County

Poster #4

Young Women with Disabilities Take Charge through Self-Directed Employment

Denise Poston, PhD, University of Kansas Center on Developmental Disabilities

Poster #5

Micro Enterprise—Customized Self-Employment: Think Outside the Box!

David Taylor, Jr, RaceCAR Waterboy, LLC

Poster #6

Employment and Developmental Disabilities: Capacity Building through Training and Technical Assistance

Brenda Clark, Dale Dileo, Peter Gamache, & Marc Tassé, PhD

Poster #7

Small Business Ownership: Expanding Employment Options for Individuals with Disabilities

Tammy Jorgensen Smith, Debra Noel, & Marc Tassé, PhD

POST SECONDARY EDUCATION

Table #2

POST SECONDARY EDUCATION MEET A LEADER ROUNDTABLE: Debra Hart

THINK COLLEGE: New Developments in Post-secondary Education for People with Developmental/Intellectual Disabilities

Cate Weir and Debra Hart, Institute for Community Inclusion

Poster #1

Goal Setting for Students with Intellectual Disabilities

Susan Palmer, Nina Zuna, Shea Obremski, Beach Center—University of Kansas

Poster #2

Precursors Difficulties in Math Learning

Myung-sook Koh, Eastern Michigan University

Poster#3

Qualitative Analysis of a Community Literacy Program for Adults with Intellectual Disabilities

Tom Fish, Ohio State University Nisonger Center; Anke Gross, University of Cologne, Germany

Poster#4

THINK COLLEGE: Postsecondary Education for Students with Intellectual/Developmental Disabilities

Debra Hart and Cate Weir, Institute for Community Inclusion

Poster #5

Connecting Transition-Age Youth with Severe Disabilities to Employment and Community Experiences: Findings an Intervention Study

Erik Carter, PhD, University of Wisconsin-Madison

11:45 am–1:15 pm

QUALITY INTERACTIVE CAFÉ

Room: Salon II & III Foyer

Quality Meet the Leaders Roundtable:

*Charlie Lakin, PhD, University of Minnesota-ICI and
Amy Hewitt, PhD, Institute on Community Integration*

Poster #1

Internet-Based Networking—Opportunities for Enhancing Agency Effectiveness

Becky Brightwell, Jason Long, IHDD/UCEDD University of Georgia

Poster #2

Quality of Life and Supports. Results from studies within the Association Ghent University

Quality of life assessment; subjective and objective ratings on personal outcomes.

Claudia M Claes, University Ghent; Stijn Vandevelde, University College Ghent, Department of Social Work and Welfare Studies / Ghent University, Department of Orthopedagogics; Geert Van Hove, Ghent University, Department of Orthopedagogics; Jos van Loon, Arduin Foundation / Ghent University, Department of Orthopedagogics; Robert L. Schalock, Bob Schalock & Associates

Poster #3

Quality of Life and Supports. Results from studies within the Association Ghent University

Person-centered planning: a systematic review on effectiveness.

Claudia M Claes, University Ghent; Geert Van Hove, Ghent University, Department of Orthopedagogics; Stijn Vandevelde, University College Ghent, Department of Social Work and Welfare Studies / Ghent University, Department of Orthopedagogics; Jos van Loon, Arduin Foundation / Ghent University, Department of Orthopedagogics; Robert L. Schalock, Bob Schalock & Associates

Poster #4

Quality of Life and Supports. Results from studies within the Association Ghent University

Support strategies for siblings of persons with intellectual disabilities. Results from a qualitative study in Belgium.

Stijn Vandevelde, University College Ghent, Department of Social Work and Welfare Studies / Ghent University, Department of Orthopedagogics; Riet Steel, University College Ghent, Department of Social Work and Welfare Studies; Leen Poppe, University College Ghent, Department of Social Work and Welfare Studies.

Poster #5

Using Data to Measure State Performance: Applications of the National Core Indicators

Val Bradley, HSRI; Sarah Taub, Human Services Research Institute; Charles R Moseley, National Association of State Directors of Developmental Disabilities Services; Kathy Kliebert, Office for Citizens with Developmental Disabilities, Louisiana Department of Health & Hospitals

Poster #6

Validation of a Useful Tool for Assessing Quality of Life of People with Intellectual Disabilities

Miguel Angel Verdugo, INICO. University of Salamanca; Benito Arias, INICO. Universidad de Valladolid; Laura Inico, University of Valladolid

Poster #7

What is the Relationship Between Objective and Subjective Quality of Life?

Laura Gomez, INICO, University of Valladolid; Benito Arias, INICO. Universidad de Valladolid; Miguel Ángel Verdugo, INICO. University of Salamanca

WEDNESDAY, JUNE 10

1:30–3:00 pm

PLENARY SESSION ON LEADERSHIP TRAINING FOR SELF-ADVOCATES

Moderator: Joanna Pierson, AAIDD President-Elect

Presentation of AAIDD Awards by J. Carolyn Graff, PhD

Leadership Award: Wendy M. Nehring, RN, PhD

Research Award: Marsha Mailick Seltzer, PhD

Have You Sharpened Your Saw?

Tia Nelis, Institute on Disability and Human Development, University of Illinois at Chicago

An Arkansas Traveler Talks About the Importance of Self Advocacy

Julie Petty, Human Services Research Institute

Creating Leadership Experience

Ethan Ellis, Next Step

Room: Salon I & II

3:00–3:15 pm

Break

3:15–4:45 pm

ACADEMY SESSION

Connecting Transition-Age Youth with Severe Disabilities to Employment and Community Experiences: Findings an Intervention Study

Erik Carter, PhD, University of Wisconsin-Madison

From Community to Hospital and Back Again: Improving the Mental Health System for Adults With Developmental Disabilities in Ontario

Yona Lunsky, PhD, University of Toronto

Impact of Early Childhood Services on Family Outcomes: Enhancing Family Quality of Life through Partnerships

Mian Wang, PhD, University of California, Santa Barbara

Room: Salon I

Wednesday *(continued)*

3:15–4:45 pm

LIFE CONNECTIONS AND EMERGENCIES SESSION

Sexuality and Multiple Os: Multiple Orientations, Objectives, Obligations, and Opportunities

Rhonda Black, University of Hawaii at Manoa; Daniel Baker, Elizabeth M. Boggs Center on Developmental Disabilities, Robert Wood Johnson Medical School, UMDNJ; Michael Mayer, Community Resource Alliance

Emergency Preparedness in the Israel Negev

Israela Nevo

Room: Salon II

3:15–4:45 pm

FAMILIES INTERACTIVE CAFÉ

Room: Salon II & III Foyer

Families Meet a Leader Roundtable

Ann Turnbull, EdD, Beach Center-Kansas University

Poster #1

Additional Children in Families of Children with Disabilities: Using Demographic Data to Answer Clinical Questions

Meghan Burke, Robert Hodapp, Richard Urbano, Vanderbilt University

Poster #2

Building a Family Advisory Council

Helen Fantasia, Elisa Velardo, Angela Rizzolo, Madeline Contreras, Vinfen CT

Poster #3

Capturing the Pioneer Spirit: Family Perspectives on Creating Exceptional Lives for Family Members with Significant Intellectual Disability

Luchara Sayles Wallace, University of Kansas-Beach Center on Disability

Poster #4

Families of Young Children with ASD: An Empirical Analysis of Early Intervention Family Supports

Zolinda Stoneman, Mary Rugg, IHDD/UCEDD University of Georgia

Poster #5

Growing Up in Facilities: Children in Need of Our Policy Attention

Nancy Rosenau, EveryChild, Inc.

Poster #6

Futures Planning: A Great Concept... Now How Do We Make It Happen?

Mindy Morrell and Karla Robeson, The Arc of Frederick County; Chantel Charette, Service Coordination, Inc.

Poster #7

Literacy-Related Barriers to Parental Involvement in the Development and Education of Children with Disabilities

Dolores Acevedo-Garcia, Harvard School of Public Health; Carmen Gomez Mandic, University of Wisconsin-Madison

Poster #8

Parent-Sibling Evaluation of an Intervention for Siblings of Children with Developmental and Health Disorders

J. Carolyn Graff, University of Tennessee Health Science Center

Poster #9

Parents as Gateways to Change in Inclusive Education

Marina Dupasquier, Kim Shawna Daniel, Lynda Simone Rochester, Kim Cornish, McGill University

Poster #10

Predictability of Parent Perception of Child Impact upon the Global Self-Worth of Adolescents with IDD

Jennifer Lynn Jones, Oklahoma State University; Patricia Ann Self, Oklahoma State University

Poster #11 *Student scholarship winner*

Relationships Between Parenting Stress and Child Behavior Among Children With and Without ID: An Examination Across Time

Cameron Neece, UCLA

Poster #12

Special Needs Financial Planning—The Key to Creating and Sustaining an Enviable Life

John Nadworny, Cynthia Haddad, Bay Financial Associates LLC

Poster #13 *Student scholarship winner*

The impact on parents who have a son or daughter with intellectual disability in Iran

Sayyed Ali Samadi, University of Ulster at Jordanstown—The Faculty of Life and Health Science

3:15–4:45 pm

TECHNOLOGY AND COMMUNICATION INTERACTIVE CAFÉ

Room: Salon III

TECHNOLOGY

Table #1:

Technology Meet the Leaders Roundtable

Mike Wehmeyer, PhD, Kansas University Center on Developmental Disabilities and Dan Davies, Ablelink Technologies, Inc

Technology Use for People with Intellectual Disabilities: Results of Three Surveys

Susan Palmer, PhD, Beach Center, University of Kansas; Shea Obremski, Beach Center, University of Kansas; Mike Wehmeyer, PhD, University of Kansas-Beach Center

Poster #1

Analogical Reasoning and Working Memory in People With Intellectual Disabilities

Caroline Bruttin, University of Geneva

Poster #2

Using Computer Technology to Promote Functional Outcomes of people with Developmental Disabilities: A Literature Review

SathiyAprakash, Thoppae Ramdoss, Karrie Shogren, The University of Texas at Austin

Poster #3

Speaking Up: A Partnership for Creating Voices

Laura Whitlock and Gary Boucher, LSU-Shreveport; Robin Lin Harris, Northwest Supports and Services Center

COMMUNICATION

Table #2:

Communication Meet a Leader Roundtable

Len Abbeduto, PhD, University of Wisconsin-Waisman Center

Poster #1

Evidence-based Communication Interventions for Persons with Severe Disabilities

Lorraine Sylvester, University of Oklahoma

Poster #2

Promoting Peer Interactions for Students with Intellectual and Developmental Disabilities Who use Augmentative Alternative Communication (AAC) Systems: A Synthesis

Yun-Ching Chung, University of Wisconsin-Madison; Erik Carter, University of Wisconsin-Madison; Lynn G. Sisco, University of Wisconsin-Madison

4:45–5:45 pm

SUPPORTS SESSION

Measuring Your Success of Your Business Plan Using National and State-Level Performance Data

Val Bradley, Human Services Research Institute; Sarah Taub, Human Services Research Institute; Charles Moseley, National Association of State Directors of Developmental Disabilities Services; Kathy Kliebert, Office for Citizens with Developmental Disabilities, Louisiana Department of Health & Hospitals

Room: Broadmoor

4:45–5:45 pm

DEFINITION 11TH EDITION SESSION

Learn About the 11th Edition of the AAIDD Diagnosis, Classification and Systems of Supports Manual and Meet its authors

Robert Schalock, PhD; Sharon Borthwick-Duffy, PhD; Valerie Bradley, Wil Buntinx, PhD; David Coulter, MD; Ellis (Pat) Craig, PhD; Sharon Gomez; Yves Lachapelle, PhD; Ruth Luckasson, JD; Alya Reeve, MD; Karrie Shogren, PhD; Martha Snell, PhD; Scott Spreat, EdD; Marc Tasse, PhD; Jim Thompson, PhD; Miguel Verdugo-Alonso, PhD; Michael Wehmeyer, PhD; Mark Yeager, PhD

Room: Fontainebleau

4:45–5:45 pm

SUPPORTS FOR PEOPLE WITH AUTISM SESSION

A Comprehensive Cognitive Therapy for Autism and Developmental Disabilities: The LPDAC Therapy Program

Myung-sook Koh, Eastern Michigan University; Sunwoo Shin, Oakland University

The Family Business—the “Business Plan” for Supporting Our Son to Live his Best Life

Denise Poston, PhD, Univeristy of Kansas Center on Developmental Disabilities

Room: Algiers

4:45–6:15 pm

HEALTH IN THE ENVIRONMENT SESSION

Moderator: Joyce Martin, AAIDD Director of Health Policy

Introduction to Environmental Health & Intellectual and Developmental Disability

Laura Abulafia, MHS, AAIDD Environmental Health Initiative

Going Green: Why Organizations Need to Develop Green Plans For Environmental Health and Sustainability

Michael Bloom, HMEA

Healthy School Environments: Why Our Children May Be At Risk

Darryl Alexander, AFT Health, and Safety

Room: Lakeview

WEDNESDAY, JUNE 10

8:00 pm

WEDNESDAY NIGHT AT THE MOVIES

“Crossing Tahoe: A Swimmer’s Dream”



A documentary starring Karen Gaffney

With popcorn and cash bar

Sponsored by the AAIDD Louisiana Chapter

Room: Salon I

Are you:

- ✓ Looking for a way to bolster your Vita?
- ✓ Looking for a way to meet more students and early career professionals in your field?
- ✓ Looking to get to your work out there?
- ✓ Looking to learn more about AAIDD?
- ✓ Looking for a way to contribute, but only 2-3 hours per month?

✓ Then look no further!

We need student and early career professional authors for our quarterly newsletters. Topics include: updates about the organization, student research highlights, the AAIDD/AUCD sponsored teleconferences, post-doc or post-graduations activities, common questions of students and early career professionals, and book reviews.

To join us, contact Camie Neece (cneece@ucla.edu) or Loui Lord Nelson (lordnelson@raiseinc.com)



American Association
on Intellectual and
Developmental Disabilities



Thursday, June 11

Registration
7 am–3:30 pm

Tabletop Exhibit Hours
7:30 am–1:30 pm

7:00–8:30 am

Complimentary Continental Breakfast

7:30–8:30 am

Journal Editors Meeting

Presiding: Bruce Appelgren

Room: Broadmoor

7:30–8:30 am

Region 9 Meeting

Presiding: Paul Spangler

Room: Algiers

7:30–8:30 am

Multicultural Special Interest Group Meeting

Presiding: Geronimo Robinson

Room: Fountainbleau

7:30–8:30 am

Psychology Division Meeting

Presiding: Marc Tassé

Room: Lakeview

7:30–8:30 am

SELF-DETERMINATION ROUNDTABLE

Supporting the Promise of Freedom

Tom Nerney, Center for Self-Determination

Room: Salon III

7:30–8:30 am

MEET A LEADER SESSION

How to Comport Ourselves in an Era of Shrinking Resources

Wolf Wolfensberger, PhD, Syracuse University Training Institute for Human Service Planning, Leadership & Change Agency

Room: Salon II

7:30–8:30 am

STUDENTS AND EARLY CAREER PROFESSIONALS SESSION

Students and Early Career Professionals in the Field of Intellectual and Developmental Disabilities: Research, Policy, and Practice

Karrie Shogren, PhD, The University of Texas at Austin

Room: Salon IA

7:30–8:30 am

CHILDREN'S SIS SESSION

Update on the Children's Supports Intensity Scale

Jim Thompson, PhD, Illinois State University; Mike Wehmeyer, PhD, Kansas University Center on Developmental Disabilities

Room: LaSalle

THURSDAY, JUNE 11

8:30–10:00 am

PLENARY SESSION ON EMERGENCY PREPAREDNESS

Moderator: J. Carolyn Graff, PhD, University of Tennessee Health Science Center

Presentation of AAIDD Awards

by J. Carolyn Graff, PhD

Media Award: Paul H. Brookes Publishing Company

International Award: Peter J. Mittler, PhD

Addressing a Flu Pandemic: Assisting People With Intellectual and Developmental Disabilities

Alan Levine, Secretary of the Department of Health and Hospitals for the State of Louisiana

Keeping People Safe: Mercaz Cochav Association of Ma'a lot Tarshiha's Experience in the Israel—Lebanon War

Ruty Goffer, Mercaz Cochav Association of Ma'alot Tarshiha

Room: Salon I & II

10:00–10:15 am

Break

10:15–11:45 am

ACADEMY SESSION

Substance Abuse in Persons With Intellectual Disabilities. Recent Findings From Research and Practice.

Quality of Life (QoL): A Generic or Specific Concept? A Comparison Between Individuals With Substance Abuse Problems and Disabilities

Wouter Vanderplasschen, Ghent University, Department of Orthopedagogics; Jessica De Maeyer, Ghent University, Department of Orthopedagogics; Eric Broekaert, Ghent University, Department of Orthopedagogics

Substance (ab)use in Persons With ID. Results of a Specific Program Developed at Arduin Foundation.

Marije Delfsma, Arduin Foundation / Ghent University, Department of Orthopedagogics; Stijn Vandevelde,

Thursday (continued)

University College Ghent, Department of Social Work and Welfare Studies / Ghent University, Department of Orthopedagogics; Veerle Soyez, Ghent University, Department of Orthopedagogics; Wouter Vanderplasschen, Ghent University, Department of Orthopedagogics; Eric Broekaert, Ghent University, Department of Orthopedagogics

Substance (ab)use in Persons With Intellectual Disabilities. Integrating Findings From Substance Abuse and Disability Research.

Stijn Vandeveld, University College Ghent, Department of Social Work and Welfare Studies / Ghent University, Department of Orthopedagogics; Marije Delfsma, Arduin Foundation / Ghent University, Department of Orthopedagogics; Veerle Soyez, Ghent University, Department of Orthopedagogics; Wouter Vanderplasschen, Ghent University, Department of Orthopedagogics; Eric Broekaert, Ghent University, Department of Orthopedagogics

Room: Salon I

10:15–11:45 am

PANEL SESSION ON AGING

Aging Caregivers: The Impact of Multiple Caregiving Roles on Quality of Life

Elizabeth Perkins, University of South Florida

Healthcare Decision Making and Care at End of Life: Lessons, Issues and Next Steps

Leigh Ann Kingsbury, InLeadS Consulting and Training

Assessing Dementia In Adults With Down Syndrome

Wayne Silverman, PhD, Warren Zigman PhD, NYS Inst for Basic Research DD; Nicole Schupf, PhD, Columbia Univ.-Dept. of Epidemiology, and Sharon Krinsky-McHale, PhD, NYS IBR, Dept. of Psychology

Room: Salon II

10:15–11:45 am

HEALTH AND DIAGNOSIS INTERACTIVE CAFÉ

Room: Salon III

Health RoundTables Panels

Table #1

Healthcare Parity: Three Approaches to Providing Disability Training to Healthcare Providers

Yona Lunsky, Centre for Addiction and Mental Health; Susan Havercamp, Florida Ctr for Inclusive Communities

Table #2

Health and Wellness Action Group Symposium

Richard Rader, MD, Joseph Putnam, Joseph O’Grady Jr, MD, Medical College of Wisconsin/Phoenix Care Systems; Carl Tyler, MD, Cleveland Clinic-Family Medicine Clinic

Poster #1

An innovative program to improve medical care for individuals with intellectual and developmental disabilities

Sarah Ailey, Rush University College of Nursing

Poster #2

By Word Of Mouth...Pennsylvania’s approach to increase access to Quality Dental Care.

Melissa Evers, Philadelphia Coordinated Health Care (PCHC)

Poster #3

Going Green at HMEA, A Provider Agency’s Journey

Michael Bloom, HMEA

Poster #4

Growth Measurements, Dietary Intakes, and Mealtime Behaviors In Children with Autism

Shirley Ekvall, PhD, University of Cincinnati

Poster #5

Health and Wellness Issues Facing Adolescents and Adults with Lifelong Disabilities: A Lifespan Perspective

Lorraine Sylvester, University of Oklahoma

Poster #6

Healthcare Decision Making and Care at End of Life: Lessons, Issues and Next Steps

Leigh Ann Kingsbury, InLeadS Consulting and Training

Poster #7

Living a Healthy Lifestyle: Preliminary Results from a Study of a Health Promotion Program

Willi Horner-Johnson, Oregon Health & Science University

Poster #8

BASC Parent Ratings of ID: Less Adaptive Than ASD

Laura Murphy, Univ of Tennessee, Memphis; Colby Butzon, UT-BCDD; Christina Warner, UT-BCDD; Crystal Schrum, UT-BCDD

Poster #9

SCQ Screener: Over-Identification of Autism in ID

Laura Murphy, Univ of Tennessee, Memphis; Colby Butzon, UT-BCDD; Crystal Schrum, UT-BCDD; Christina Warner, UT-BCDD

Poster #10

The Evaluation of two Methods of Measuring Pain Expression in Individuals With Intellectual and Developmental Disabilities

Satomi K. Shinde, University of Wisconsin River Falls; Frank J. Symons, University of Minnesota; Stacy Danov, University of Minnesota; Chin Chih Chen, University of Minnesota; Jamie Clary, J. Iverson Riddle Developmental Center; Vicki Harper, J. Iverson Riddle Developmental Center; James Bodfish, University of North Carolina at Chapel Hill

Poster #11

Thinking Ahead, My Way, My Choice, My Life at the End

Suzanne Richards, California Coalition for Compassionate Change; Tammy Evrard and Mark Starford, Board Resource Center

Poster #12

Adaptation and Validation Process of the AAIDD's Diagnostic Adaptive Scale (DABS): Preliminary Study

Patricia Navas, Benito Arias, Laura Sanchez and Miguel Angel Verdugo, University of Salamanca, Spain

10:15-11:45 am

EMERGENCY PREPAREDNESS INTERACTIVE CAFÉ

Room: Salon II & III Foyer

Meet the Leaders RoundTable:

Self Advocates and Direct Support Staff from Volunteers of America Who Experienced Hurricane Katrina

Poster #1

Louisiana Office for Citizens with Developmental Disabilities

Take and Go Booklet

Poster #2

How Planning Really Makes a Difference

Larry Weishaar, ResCare Inc.

Poster #3

Effective Disaster Planning: Covering All the Bases

Sharon Gomez and Yvonne Miller-Nixon, Evergreen Presb Ministries

Poster #4

The Mississippi Experience

Mark Yeager, PhD, MS Department of Mental Health

11:45-12:45 pm

STUDENT AND EARLY CAREER PROFESSIONAL LUNCH MEETING

Emerging Issues in Disability: Challenges and Opportunities for early career professionals

Glen T. Fujiura, PhD, Department of Disability and Human Development, University of Illinois at Chicago

Seating is limited. Please pick up your ticket at the registration desk!

Sponsored by the MENTOR Network

Room: Broadmoor

11:45-12:45 pm

Social Work Division Lunch Meeting

Presiding: Barbara Hanley

Room: Orleans

11:45-12:45 pm

Intentional Community Meeting

The Intentional Community Meeting is open to any person who is interested in issues related to persons of color with disabilities including how to increase and maintain their participation in AAIDD. Persons of color with disabilities are disproportionately affected by the social economic ills of the society thus contributing to the disparities that exist between the majority and minority populations. The focus of the meeting is to identify factors that contribute to the lack of participation of persons of color with disabilities and will help to increase their advocacy and leadership skills.

Room: Vermilion

12:45-2:15 pm

THE ACADEMY SESSION

The Academy on Intellectual and Developmental Disabilities Award and Business Meeting

Leonard Abbeduto, PhD, Waisman Center, University of Wisconsin, Madison

(1) Introduction and overview of Dr. Marsha Seltzer's contributions to the IDD field in acknowledgement of her receiving AAIDD's 2009 Research Award

(2) Presentation: **Autism in Adolescence and Adulthood: Developmental Trajectories and Family Well-Being**, Gael Orsmond, PhD, Department of Occupational Therapy, College of Health and Rehabilitation Sciences, Boston University

(3) The Academy Business Meeting

Room: LaSalle

12:45-2:15 pm

SELF DETERMINATION SESSION

Implementation of Consumer-Directed Services: A National Study

Pam Walker and Matthew Bogenschutz, Center on Human Policy, Syracuse University

Knowledge is Power in Choosing Supports!

Celia Feinstein, Institute on Disabilities, Temple University; James Lemanowicz, Institute on Disabilities at Temple University; Mary Kay Cunningham, Institute on Disabilities at Temple University; Edward Piccharini, Western PA Provider Alliance

Room: Salon I

Thursday (continued)

12:45–2:15 pm

**BEHAVIORAL AND MENTAL HEALTH NEEDS
INTERACTIVE CAFÉ**

Room: Salon III

BEHAVIORAL NEEDS

Table #1

Meet the Leaders Roundtable

Dennis Reid, PhD, Carolina Behavior Analysis and Support Center and David Rotholz, PhD, Center for Disability Resources University of South Carolina School of Medicine -Pediatrics

Creating a More Responsive Community Behavioral Health System: Pennsylvania's Commitment

Dina McFalls, Philadelphia Coordinated Health Care

MENTAL HEALTH

Roundtables Panels:

Table #2

Crisis Intervention: A Key to Closing Institutions while Opening the Door to Expanded Community-Based Supports

James Wiltz, AWS/Columbus Crisis Management Services of Indiana; Timothy Alan Stultz, AWS/Columbus; Deceil Moore, Meridian Services

Ethical Issues in Providing Services to Persons with Cognitive Disabilities

Andrew W. Griffin, Department of Aging & disability Services; Lisa Shelby, Austin Travis County MHMR; Nedra Francis, Prairie View A&M University; Charlotte Kimmel, Texas Department of Aging & Disability Services

Poster #1

A Continuing Trend: Dual Diagnosis Clients With Forensic Involvement

Poonam Raina, Centre for Addiction and Mental Health; Yona Lunsky, Centre for Addiction and Mental Health

Poster #2

Connecting the Dots: From Effective Behavior Intervention Plans to Maximizing Implementation to Client Outcomes

Bruce Williams, South Central Los Angeles Regional Center

Poster #3

Follow-up in Adolescence of Five Children Previously Diagnosed as Having a Multiple Complex Developmental Disorder

Howard Demb, Albert Einstein College of Medicine; Abigail Navarro-Lim, MD AND Tammy Fried, MSW, Rose F. Kennedy Center University Center of Excellence in DD

Poster #4

Gender Differences in Risk Factors of Aggressive Behaviour Among Adults with Intellectual Disabilities

Melissa Clark, Université du Quebec a Montreal; Diane Morin, Université du Québec à Montréal; Anne Crocker, Université Mcgill

Poster #5

Mental Health and Behavioral Issues in Adults with Intellectual and Developmental Disabilities

Whitney Taylor Brooks, The Ohio State University—Nisonger Center

Poster #6

Staff Recall of Treatment Information

Rebecca Mandal-Blasio, PhD, Resource Center on Psychiatric & Behavioral Supports; Karen Sheridan, Resource Center on Psychiatric & Behavioral Supports

Poster #7

Substance Abuse In Persons With Intellectual Disabilities. Recent Findings From Research and Practice.

Quality of Life (QoL): A Generic or Specific Concept? A Comparison Between Individuals With Substance Abuse Problems and Disabilities

Wouter Vanderplasschen, Ghent University, Department of Orthopedagogics; Jessica De Maeyer, Ghent University, Department of Orthopedagogics; Eric Broekaert, Ghent University, Department of Orthopedagogics

Poster #8

Substance Abuse in Persons With Intellectual Disabilities. Recent findings From Research and Practice.

Substance (ab)use in Persons With ID. Results of a Specific Program Developed at Arduin Foundation.

Marije Delfsma, Arduin Foundation / Ghent University, Department of Orthopedagogics; Stijn Vandeveld, University College Ghent, Department of Social Work and Welfare Studies / Ghent University, Department of Orthopedagogics; Veerle Soyez, Ghent University, Department of Orthopedagogics; Wouter Vanderplasschen, Ghent University, Department of Orthopedagogics; Eric Broekaert, Ghent University, Department of Orthopedagogics

Poster #9

Substance Abuse in Persons With Intellectual Disabilities. Recent Findings From Research and Practice.

Substance (ab)use in Persons With Intellectual Disabilities. Integrating Findings From Substance Abuse and Disability Research.

Stijn Vandeveld, University College Ghent, Department of Social Work and Welfare Studies / Ghent University, Department of Orthopedagogics; Marije Delfsma, Arduin Foundation / Ghent University, Department of Orthopedagogics; Veerle Soyez, Ghent University, Department of Orthopedagogics; Wouter Vanderplasschen, Ghent University, Department of Orthopedagogics; Eric Broekaert, Ghent University, Department of Orthopedagogics

12:45–2:15 pm

LIFE CONNECTIONS INTERACTIVE CAFÉ

Room: Salon II & III Foyer

Meet the Leader RoundTable: *Bill Gaventa, MDiv, The Elizabeth M. Boggs Center on Developmental Disabilities UMDNJ-Robert Wood Johnson Medical School*

Poster #1

A Comprehensive Cognitive Therapy for Autism and Developmental Disabilities: The LPDAC Therapy Program

Myung-sook Koh, Eastern Michigan University; Sunwoo Shin, Oakland University

Posters # 2 and 3

Attitudes and Beliefs of the General Population With Regards to Intellectual Disability.

Rebecca Beaulieu Bergeron, Diane Morin, Anne Crocker, Jean Caron and Denise Normand-Guerette, UQAM

Poster #4

Dreams, Choices, and Self-Advocacy: A Recipe for an Envable Life

Krescene Beck, Illinois Voices

Poster #5

Enhancing Individualized Support Plans by Using Person Centered Planning and the SIS

Jim Thompson, PhD, Illinois State University; Cathy Ficker Terrill, Ray Graham Association

Poster #6

E-N-V-I-A-B-L-E: Creating Envable Lives for People with Developmental Disabilities

Amy Susan Walker, Illinois Voices/Macon Resources, Inc.

Poster #7

Choice And Preference—A Foundation of a Living and Working Model

Amir Azulay, Hamama; Izhak Hamama

Poster #8

Experiences of Social Victimization Among Individuals With Specific Genetic and Developmental Disabilities

Marisa Fisher, Vanderbilt University

Poster #9

Inverse-Inclusion in An Israeli Village Designed for People With Special Needs

Israela Nevo, Israeli

Poster #10

Magic of Creating Change in Individual's Lives

Fredrick Erlich, Living Resources

Poster #11

Perceived Stressors of Individuals with Intellectual Disability

Yona Lunsky, Centre for Addiction and Mental Health; Michelle Antoinette Vecili, Centre for Addiction and Mental Health; Carol Strike, Centre for Addiction and Mental Health

Poster #12

Social Interactions and Leisure Activity Involvement of Adolescents With and Without Intellectual Disabilities

Julia Burbidge, Helene Ouellette-Kuntz, Patricia Minnes, Queen's University

Poster #13

The Family Business—The "Business Plan" for Supporting Our Son to Live His Best Life

Denise Poston, PhD, University of Kansas Center on Developmental Disabilities

Poster #14

The Jambalaya Project: Inclusive Recreation Program through Community Agency Collaboration

Jennifer Whisenhunt, OCDD Resource Center on Psychiatric and Behavior Supports

Poster #15

The Perspectives of Young Adults with Intellectual Disabilities on Their Social Inclusion

Sarah Anne Hall, University of Nebraska-Lincoln

2:15–2:30 pm

Break

THURSDAY, JUNE 11

2:30–4:15 pm

PLENARY SESSION ON MANAGING AGENCIES FOR CHANGE

Moderator: Cathy Ficker Terrill

Presentation of AAIDD Awards by J. Carolyn Graff, PhD

Education Award: James R. Patton, EdD

Service Award: John J. McGee, PhD

Changing Vision Into Action: Cathy Ficker Terrill, Ray Graham Association

"Changing Minds, Changing Lives: The Arc of Northern Virginia Embraces "A Life Like Yours" by Instituting a Groundbreaking Co-Executive Director Experiment": Jill Egle and Nancy Mercer, The Arc of Northern Virginia

4:00 pm

AAIDD Closing Ceremony

Room: Salon I & II

THURSDAY, JUNE 11

4:15–5:30 pm

**SPECIAL PLENARY SESSION
ON SUCCESSION PLANNING**

**Change is Coming:
The Challenges of Succession Planning
and Leadership Transitions**

The largest study of non-profit executive directors to date determined that fully two-thirds of them anticipate remaining in their positions for five years or fewer (Annie E. Casey Foundation: *Change Ahead: The 2004 nonprofit executive leadership and transitions survey.*) What will the impact be on the intellectual disability field and on our organizations as leaders retire? How can we work to assure leadership transitions will enhance rather than threaten our future?

This lively session will discuss the impact of multiple leadership transitions on the ID/DD field and the degree to which national, state and local organizations are prepared for changes in leadership. Val Bradley of Human Services Research Institute will present the results of a recent study that surveyed the concerns and preparedness of the executive directors and CEOs of national ID/DD organizations, DD Councils, P&As, UCEDDs, state departments, and provider agencies nationally. Lois Simpson, the Executive Director of Louisiana’s Protection & Advocacy Center, Nancy Thaler, the Executive Director of The National Association of State Directors of Developmental Disabilities Services and Steve Hall, the Director of the Georgia Office of Developmental Disabilities will discuss the ways they and their organizations have prepared for their eventual successions to assure continued, positive organizational growth, quality and success.

This session will be facilitated by Suzanne Maas of Leadership Transitions, a consulting group dedicated to building the capacity of nonprofit organizations before, during, and after a leadership change.

Room: Salon I & II



**RELIGION AND SPIRITUALITY
DIVISION PROGRAM**

Annual Division Dinner

Thursday, June 11 • 6pm

Cost \$30

- A time of sharing your local work and ministries
Tickets available at the registration desk

Religion and Spirituality Division Forum

Friday, June 12 • 9am–12 Noon

Cost \$25.00—supports division activities

Schedule

- 9 am **Business meeting**
 - Report on Activities of the Division—
Bill Gaventa, Secretary
 - Report on Spiritual SIS project—
submitted by Erik Carter
 - Report on Financials of Division—
Michael Hoggatt, Treasurer
- 9:45 am **Engaging Residential Providers
as Partners**
 - Michael Hoggatt is the presenter. He will
share from the provider’s point of view.
 - Bill Gaventa and Nella Uitvlugt will present
anecdotal stories from the faith communities’
perspective.
 - Come with your stories and insights to share
with those attending the Forum

Room: LaSalle

Friday, June 12

7:30–8:30 am

Business Meetings

9:00 am–12:00 pm
Cost \$60

SPECIAL SYMPOSIUM on Succession Planning and Preparing for the Challenges of Leadership Transition

Suzanne Maas, Leadership Transitions, a Consulting group dedicated to building the capacity of nonprofit organizations before, during, and after a leadership change.

A shared discussion and hands-on workshop for leaders at all levels to consider and prepare for leadership transitions in a safe and confidential environment. Tools will be provided for executive directors, board members, advocates, and organizational leaders at all levels to assess their organization's readiness for an anticipated or unanticipated change in leadership, consider the complex implications of leadership transitions, and prepare for continued organizational growth and quality.

This symposium is Co-Sponsored by: The American Network of Community Options and Resources (ANCOR), The Association of University Centers on Disabilities (AUCD), Human Services Research Institute (HSRI), the National Association of Councils on Developmental Disabilities (NACDD), The National Disability Rights Network (NDRN), and The National Leadership Consortium on Developmental Disabilities at the University of Delaware.

#4 Room: *Evangeline*



PROFESSIONAL WORKSHOPS

9:00 am–12:00 pm
Cost \$60

A Comprehensive Cognitive Therapy for Autism and Developmental Disabilities: The LPDAC Therapy Program

Myung-sook Koh, Eastern Michigan University; Sunwoo Shin, Oakland University

The comprehensive cognitive therapy is a scientifically structured therapy to treat the cognitive deficits of children with ASD. The 12 structured therapy stages are developed based on cognitive learning theory. This workshop will demonstrate 168 therapy activities in 12 therapy stages and how to implement those with video clips and hands-on activities. The theoretical flow displays in therapy stages and therapy activities are focused on each learning theme of the therapy stages.

Workshop #2 Room: *Orleans*

9:00 am–12:00 pm
Cost \$60

Dreams, Choices, and Self-Advocacy: A Recipe for An Envable Life

Krescene H. Beck, Illinois Voices

This interactive workshop provides participants with a recipe for success in developing person-centered quality and self-determination supports: start with a base of self-advocacy, add one helping of dreams, sprinkle in a heaping cup of choices, mix with lots of support, add a dash of humor to taste, and enjoy the delicious outcome! Award winning recipes will be shared as well as tips that that can be used immediately to help create other successful recipes.

Workshop #3 Room: *Carondelet*

9:00 am–12:00 pm
Cost \$60

Healthcare Decision Making and Care at End of Life: Lessons, Issues and Next Steps

Leigh Ann Kingsbury, InLeadS Consulting and Training

This presentation is an overview of current issues in healthcare decision making and care at end of life for people with ID/DD. Attendees will receive an introduction to key issues, topics and lessons learned thus far through planning with people with ID/DD around healthcare decision making and care at end of life; and based on those issues and lessons the presentation will examine some of the next steps in this continuing steep learning curve.

Workshop #9 Room: *Baronne*

Friday (continued)

12:00–1:00 pm

Lunch on Your Own

FULL DAY WORKSHOP

9 am–4 pm

Cost \$99

A Brief Overview of Social Role Valorization

*Wolf Wolfensberger, PhD, Syracuse University
Training Institute for Human Service Planning,
Leadership & Change Agency and Elizabeth Neville,
Keystone Institute*

Social Role Valorization (SVR), the successor to the principle of normalization, is a high-level theoretical schema for addressing the processes of social devaluation in society by crafting valued social roles for people who are already devalued for any reason, or are at high risk of being cast into a devalued status. SRV is foundational for any human service for such people, but is also highly relevant to social interactions with them outside the service structures.

People relate to each other primarily via their social roles. Therefore, people who encountered in roles that are devalued by perceives will generally have bad things done to them, but all sorts of opportunities are likely to be opened to people encountered in roles that perceivers value. SRV lays out strategies for valorizing people’s social roles. Failure to take account of role theory realities leads to all sorts of suboptimal-or even disastrous-human service and social practices.

Workshop #8 *Room: Salon I*



FRIDAY, JUNE 12

POST-CONFERENCE SEMINAR

**AAIDD Psychology Division
& Mental Health Services SIG invite
their members and all students
to a seminar entitled:**

**Practical Applications of
Functional Assessment Technology
for Challenging Behavior**

Friday, June 12th, 2009 • 9:00 am–12:00 pm

Room: Vermilion

This seminar is restricted to members of the AAIDD Psychology Division, AAIDD Mental Health Services SIG, and AAIDD student members only. There is NO COST for participants to attend this seminar.

Presenter:

Dennis H. Reid, Ph.D., BCBA

Carolina Behavior Analysis and Support Center, Ltd.

This seminar will present practical considerations in conducting functional assessments to identify the motivating variables associated with challenging behavior. The focus will be on selecting functional assessment strategies that are most practical given the setting in which an individual engages in challenging behavior and the existing resources. Different ways to conduct functional assessments will be described (e.g., analogue analyses, descriptive assessments, in-vivo functional analyses) in light of the time and resources typically required for respective assessments. Research on the various assessment strategies will be summarized regarding the expected utility for accurately identifying controlling variables, and subsequent utility for leading to function-based treatment programs.

3 hours of Continuing Education credits for psychologists will be provided by the University of Tennessee Boling Center for Developmental Disabilities.



AMERICAN
PSYCHOLOGICAL
ASSOCIATION

The University of Tennessee Boling Center for Developmental Disabilities (BCDD) is approved by the American

Psychological Association to sponsor continuing education for psychologists. The BCDD maintains responsibility for this program and its contents. The BCDD agrees to adhere to the *APA Ethical Principles of Psychologists*.

Carolina Behavior Analysis and Support Center is an approved provider of the Behavior Analyst Certification Board (BACB) and has approved this session for **3 Type II BACB Continuing Education Units for Board Certified Behavior Analysts and Board Certified Assistant Behavior Analysts.**

The AAIDD Board of Directors wishes to thank the

AAIDD AD HOC COMMITTEE ON TERMINOLOGY AND CLASSIFICATION

for their service to the Association and to the field
in preparing the 11th Edition of our manual;

Intellectual Disability: Definition, Classification and Systems of Supports!

Thank You!

Robert L. Schalock, Ph.D., Chair
Sharon A. Borthwick-Duffy, PhD
Valerie J. Bradley
Wil H.E. Buntinx
David L. Coulter, M.D.
Ellis M. (Pat) Craig, Ph.D.
Sharon C. Gomez
Yves Lachapelle, PhD
Ruth Luckasson, J.D.

Alya Reeve, MD
Karrie A. Shogren, Ph.D.
Martha E. Snell, Ph.D.
Scott Spreat, Ed.D.
Marc J. Tassé, Ph.D.
James R. Thompson, Ph.D.
Miguel A. Verdugo-Alonso, PhD
Michael L. Wehmeyer, PhD
Mark H. Yeager, PhD

We also appreciate the technical support given to the committee by Yvette Taylor and Darlene Bushchow.

Intellectual Disability: Definition, Classification, and Systems of Supports, 11th Edition

Authors: Robert L. Schalock, PhD; Sharon A. Borthwick-Duffy, PhD; Valerie J. Bradley; Wil H.E. Buntinx; David L. Coulter, MD; Ellis M. (Pat) Craig, PhD; Sharon C. Gomez; Yves Lachapelle, PhD; Ruth Luckasson, JD; Alya Reeve, MD; Karrie A. Shogren, PhD; Martha E. Snell, PhD; Scott Spreat, EdD; Marc J. Tassé, PhD; James R. Thompson, PhD; Miguel A. Verdugo-Alonso, PhD; Michael L. Wehmeyer, PhD; and Mark H. Yeager, PhD

**Watch for our
special pre-publication offer,
COMING SOON!**

**The new definition will be
available in Fall 2009.**

This manual contains the world's most current and authoritative information and knowledge on the condition known as intellectual disability, including best practice guidelines on diagnosing and classifying intellectual disability and planning life-long supports for people living with this condition. Written by a committee of 18 experts, *Intellectual Disability: Definition, Classification, and Systems of Supports* (11th edition) is based on seven years of work on:

- (1) An analysis of US-based definitions of at least 50 years;
- (2) Numerous reviews and critiques of the 10th edition of the AAIDD definition manual; and
- (3) Feedback on a series of articles published in peer-reviewed journals. This is the first official AAIDD definition manual to use the term "intellectual disability".

The one definitive reference no disability professional should do without...

The State of the States in Developmental Disabilities

(Seventh edition) by *David L. Braddock*

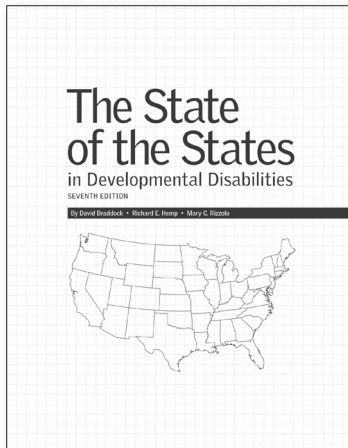

No: 243. \$59.95
2008 Hardback 8 1/2 x 11
309 pages
ISBN: 978-1-935304-00-5

*"I have always found copies of the **State of the States** report to be the most used (even dog-eared) documents in the offices of service providers, state leaders, and advocacy organizations."*

—**ELLEN B. GILLESPIE**

Executive Director,
Alabama Disabilities Advocacy Program

American Association
on Intellectual and
Developmental Disabilities

Access the single source of rich, objective, and hard-to-obtain data on intellectual and developmental disability spending in every U.S. state. Get a 4-page national report card on each state! Includes trends in revenues, spending, residential services, and individual and family support. Plus over 100 pages of statistics, graphs, and analyses on these issues and more:

- » National trends in spending on institutional versus community services
- » People with intellectual disabilities living in nursing facilities per state
- » Analysis of ICF/MR, HCBS Waiver, and local/county funding sources
- » Recent federal initiatives, including the Deficit Reduction Act of 2005 and Medicaid Commission recommendations
- » Waiting lists and litigations in each state
- » Rise in aging caregivers and increased longevity of people with intellectual disability and state services

- Plan budgets or programs
- Advocate for policy reform and increase in waivers
- Create benchmarks and comparisons across states
- Educate legislators about needs and trends

QUESTIONS?

Email: books@aaidd.org

TO ORDER:

Phone: 301-604-1340

Fax: 301-206-9789

Web: <http://bookstore.aaidd.org>

Mail: AAIDD Publications,
9050 Junction Drive,
Annapolis Junction, MD 20701-1150

Business Meetings

MONDAY, JUNE 8

5:00 pm–8:00 pm

Board of Directors Meeting

Presiding: Steven Eidelman, FAAIDD, AAIDD President

Room: Vermilion

TUESDAY, JUNE 9

9:00 am–5:00 pm

DABS Meeting

Presiding: Marc Tassé

Room: tbd

10:00 am–12:00 noon

Annual Open Membership Meeting and Leadership Forum

Presiding: Steven Eidelman, AAIDD President

Room: Salon I

1:15–5:00 pm

The Assembly of Geographic Interests Meeting

Presiding: Joanna Pierson, AAIDD President-Elect

Room: La Salle

The Conference of Professional Interests Meeting

Presiding: Michael Wehmeyer, AAIDD Vice President

Room: Orleans

WEDNESDAY, JUNE 10

7:30–8:30 am

Editorial Advisory Committee Meeting

Presiding: Steven Warren

Room: Broadmoor

Gerontology Division Meeting

Presiding: Elizabeth Perkins

Room: Algiers

Social and Sexual Concerns Special Interest Group Meeting

Presiding: Leslie Walker-Hirsch

Room: Fountainbleau

THURSDAY, JUNE 11

7:30–8:30 am

Journal Editors Meeting

Presiding: Bruce Appelgren

Room: Broadmoor

Region 9 Meeting

Presiding: Paul Spangler

Room: Algiers

Multicultural Special Interest Group Meeting

Presiding: Geronimo Robinson

Room: Fountainbleau

Psychology Division Meeting

Presiding: Marc Tassé

Room: Lakeview

11:45–12:45 pm

Social Work Division Lunch Meeting

Presiding: Barbara Hanley

Room: Orleans

Registration Schedule

Registration will take place at the Salon I Foyer.

The Registration area will open as follows:

Tuesday	11:30 am–4:30 pm
Wednesday	7:00 am–4:30 pm
Thursday	7:00 am–3:30 pm
Friday	8:00 am–1:30 pm

Admittance to the Annual Meeting Activities

Registrants are required to wear their badges for all meetings, exhibits, and other events. Admittance to all professional meetings as well as other Annual meeting activities will be with a badge only.

Door monitors will be instructed not to admit non-registered attendees.

AAIDD Market Place

Information on AAIDD membership and publications will be on display in the Exhibit Area during the regular exhibit hours.

Silent Auction

A silent auction will be held at the AAIDD Market Place in the Exhibit Area during regular exhibit hours. Be sure to bid on items of your choice! Biddings close at 12:45 pm on Thursday, June 11, 2009. *All Items must be picked up by 2:15 pm on Thursday.*

Message Center

The message center will be in the Hall by the Registration Area on Level One. Volunteers will assist you in locating friends and colleagues.

Lost Tickets

There will be NO replacements for lost event tickets. Anyone losing a ticket will have to purchase a new one.

The Exhibit Hours

The exhibits are an integral part of the educational program; we invite you to visit them. A listing of exhibitors and the products they are displaying are listed on pages 24 and 25 of this program.

(Acceptance of exhibits by AAIDD does not imply an endorsement.)

Table Top Exhibits

We invite you to visit our exhibitors and contact those companies whose products or services interest you. The exhibits are located in Baronne/Carondelet/St. Charles.

AAIDD thanks all of our exhibitors.

Come support AAIDD's Exhibitors and see the newest and the best products and services in the field!

AAIDD Religion and Spirituality Division

2215 29th Street # B6, Grand Rapids, MI 49506
 Contact: Bill Gaventa/Nella Uitvlugt
 Phone: 732-235-9304
 Fax: 732-235-9300
 E-mail: bill.gaventa@umdnj.edu or friendship@friendship.org
 Web: <http://www.aaiddreligion.org>

The Religion and Spirituality Division of AAIDD is an inter-faith, inter disciplinary association of professional ordained and lay people who journey with persons with developmental disabilities and their families. The exhibit contains recent publications & opportunities for networking.

Brookes Publishing Co.

Brookes Publishing Co., P.O. Box 10624, Baltimore, MD 21285
 Contact: Melanie Allred, Marketing Manager
 Phone: 410-337-9580
 Fax: 443-279-0016
 E-mail: mallred@brookespublishing.com
 Web: www.brookespublishing.com

For 30 years, Brookes Publishing has been a leading provider of resources on disabilities, autism, education, child development, early intervention, communication, language, behavior, and mental health. An independent company, Brookes Publishing is headquartered in Baltimore, Maryland.

CLC Network

4340 Burlingame SW, Wyoming, MI 49509
 Contact: Bev VanNoord, Development Director
 Phone: 616-245-8388
 Fax: 616-243-3662
 E-mail: qlue@clcnetwork.org
 Web: www.clcnetwork.org

CLC Network—Resource Christian School and churches to include people with disabilities. Books, products, services and information are available.

SILENT AUCTION

A silent auction will be held in the exhibit area during regular exhibit hours. Be sure to bid on items of your choice! Bidding closes at 12:45 pm on Thursday, June 11, 2009.

All Items must be picked up by 2:15 pm on Thursday.

College Internship Program

17 Main Street; Suite 1, Lee, MA 01238
 Contact: Maggi Sanderson, National Admissions Coordinator
 Phone: 413-243-0710
 Fax: 413-243-2517
 E-mail: msanderson@berkshirecenter.org
 Web: www.berkshirecenter.org

The College Internship Program provides comprehensive, individualized academic, internship and independent living experiences for young adults, ages 18-25, identified with learning differences, Asperger's Syndrome, high-functioning Autism, NVLD, ADHD, Dyslexia and POD-NOS.

Deyta LLC

7400 New LaGrange Road, Suite 200, Louisville, KY 40222
 Contact: Jenn Bauer, National Director of Business Development
 Phone: 502-896-8438
 Fax: 502-896-0718
 E-mail: jbauer@deyta.com

Deyta specializes in Performance Manager Systems for ID/DD providers, providing extensive analysis and reporting services for Consumer, Family/Guardian, and Employee Satisfaction. The ultimate goal of the ID/DD Performance Manager is to identify performance improvement opportunities through continuous measurement of satisfaction through reports to assess performance and satisfaction both internally and relative to other agencies.

Essential Learning

10755- F Scripps Poway Parkway # 587, San Diego, CA 93131
 Contact: Gina Brust, Business Development Specialist
 Phone: 800-729-9198 x 274
 Fax: 866-289-5988
 E-mail: gbrust@essentiallearning.com
 Web: www.essentiallearning.com

Essential Learning (EL) is the largest provider of e-learning services for the human service industry serving more than 500 agencies. EL will reduce your training costs and insure compliance with training mandates. We offer an extensive online course library on developmental disabilities, mental health, workforce development and compliance topic.

Friendship Ministries

2215 29th St. SE Ste B6, Grand Rapids, MI 49506
 Contact: LaVonne Carlson
 Phone: 616-301-7729
 E-mail: carlsonl@friendship.org
 Web: www.friendship.org

Friendship Ministries provides a one-on-one mentoring model for nurturing spirituality in people who have cognitive impairments, encouraging them to become active members of their faith communities. Training, consulting, and curriculum are available.

Habilitation Software Inc.

204 N. Sterling St., Morgantown, NC 28655
 Contact: Randy Hersom
 Phone: 828-438-9455
 Fax: 828-438-9488
 E-mail: randy@habsoft.com
 Web: www.habsoft.com

The Personal Planning System is the result of 25 years of creating software for agencies serving people with developmental disabilities. HBI assists in creating person-centered yearly support plans, monthly reviews and progress notes and keeping daily service attendance and billing information.

Human Service Connections

P O 272, Palos Park, IL 60464
 Contact: Anne McFerron, Executive Search Specialist
 Phone: 866-646-7762
 Fax: 708-671-1533
 E-mail: amcferron@humanserviceconnections.com
 Web: www.humanserviceconnections.com

Human Service Connections provides executive leadership recruitment and development services exclusively for the developmental disability field. HSC is staffed with experienced professionals to help you find leaders outside your organization or develop those within.

Quantum Solutions Corporation

533 W. S Heridan LN, Petersburg, IL 62675
 Contact: Ann Worthington Acct. Exec.
 Phone: 217-632-3066
 E-mail: annw@qscorpio.com
 Web: www.essentiallearning.com

Quantum Solutions Corporation is a software development company serving DD, MH, and other human service provider agencies. We automate every process of the enterprise – treatment plans, medication management, residential facility management and virtually every function on operations.

Routledge

2 Park Square, Milton Park, Abingdon, Oxon, OX14URN, UK
 Contact: Katie Gilbert – Exhibitions Manager
 Phone: 004(0) 207 017 0310
 Fax: E-mail: katie.gilbert@bandt.co.uk
 Web: www.taylorandfrancisgroup.com

Routledge publishes a wide variety of books and journals in the field of behavioral science. Pick up free copies of our outstanding journals in mental health and intellectual and developmental disabilities.

Scioto

5970 Wilcox Pl, Suite H, Dublin, OH 43016
 Contact: Kate McNulty
 Phone: 614-889-5191
 Fax: 614-889-5202
 E-mail: mcnulty@scioto.com
 Web: www.scioto.com

Scioto is the number one national provider of housing solutions for people with disabilities. Scioto specializes in the following services: property acquisition; financing; design& build; property management; real estate project development. Scioto's primary focus is helping providers deliver services to the people they support.

Service Coordination

5303 Spectrum Drive, Suite I, Frederick, MD 21703-8619
 Phone: 301-663-8044
 Fax: 301-663-9609
 Web: www.servicecoordinationinc.org

Service Coordination is a nonprofit agency in Maryland that assists individuals with intellectual and developmental disabilities in determining and meeting their needs in ways they prefer. Our mission is to help individuals become active members of their communities with equal rights and responsibilities and to help people develop and obtain high quality supports and services that are the least intrusive to meet their desires and needs and support their personal goals.

Sterling Pharmacy (A Division Of Sterling Assoc. Inc.)

205 Reynolds Drive Suite C, Ruston, LA 71270
 Contact: Mandy Bolling, Marketing
 Phone: 318-513-1688
 Fax: 318-513-1677
 E-mail: mbolling@sterlingassoc.com
 Web: sterlingassoc.com

Sterling Associates, Inc. began with a simple idea; to provide the highest quality, professional pharmaceutical and therapy services to the healthcare industry. Our name signifies our values. "Sterling" stands for the highest quality. The inclusion of "Associates" in our name represents our belief that teamwork is vital to our way of doing business.

Therap Services

562 Watertown Ave., Waterbury, CT 06708
 Contact: Kara Candelori, TI Specialist
 Phone: 203-596-7553
 Fax: 203-757-5116
 E-mail: kara@therapservices.net
 Web: www.therapservices.net

Therap Services, LLC. is a web-based service organization that provides an integrated solution for documentation and communication needs of agencies providing support to people with disabilities, especially developmental disabilities. It offers an easy and efficient alternative to the immense amount of paper work that is done manually by the care providers.

2008-09 AAIDD Leadership

BOARD OF DIRECTORS

Steven M. Eidelman, *President*

Joanna L. Pierson, PhD
President-Elect

Michael L. Wehmeyer, PhD
Vice President

James F. Gardner, PhD
Secretary/Treasurer

David A. Rotholz, PhD
Immediate Past President

Members-at-Large

Sharon C. Gomez
Karrie A. Shogren, PhD
Marc J. Tassé, PhD

Nancy Ward
Presidential Advisor

M. Doreen Croser
Executive Director

EDITORS

Steven J. Taylor, PhD
Leonard J. Abbeduto, PhD

AAIDD PERSONNEL

Laura Abulafia
Paul D. Aitken
Maria A. Alfaro
Bruce A. Appलगren
Stephanie Dean
Saihanjula He
Betty C. Margallo
Joyce Martin
Ana M. Montoulieu
Anna Prabhala
Yvette Taylor
Ajith Mathew

NEW 30-YEAR AAIDD MEMBERS

Norberto Alvarez, MD
Ansley Bacon, PhD
Pamela C. Baker, PhD
William J. Bates, MD
Marna L. Beatty
Sidney W. Blanchard
Bruce D. Boyd, PhD
Richard D. Boyd, PhD
David L. Braddock, PhD
Vincent A. Campbell, PhD
Debra M. Capener
Paul Cesana
Terry I. Cooper
Joan S. Cooper, PhD
Paul D. Cotten, PhD
Joseph M. Davidson
Deborah Davies, PhD
Celia S. Feinstein
Jerome H. Feldstein, PhD

Willard B. Fernald, MD
Elizabeth M. Fitzgerald, EdD
Charles S. Holburn, PhD
Nancy H. Huguenin, PhD
Robert T. Ireland, PhD
Irene Jakab, PhD, MD
Charlotte M. Kimmel, PhD
Marty W. Krauss, PhD
Gregory L. LaForme, PhD
Suzie M. Lassiter, PhD
Donna H. Lehr, PhD
Roman W. Lemega, PhD
Michael E. Maus, PhD
Kevin P. McLaren, PhD
Sadie F. Miller
Stephen H. Morgan
Nevalyn A. Nevil
Patricia H. Nichols
Barbara R. Nurenberg

John H. O'Neill, PhD
Allita H. Paine
Mary I. Pearlman, MD
Inge A. Pelzer, PhD
Donna L. Ree
Steven Reiss, PhD
Johannes R. Rojahn, PhD
Mary Ann Ronski, PhD
David C. Ruppell
Robert H. Schram, PhD
Nirbhay N. Singh, PhD
Carolyn J. Smith,
Alphonso L. Sorhaindo, PhD
Donna K. Spiker, PhD
Samuel J. Thios, PhD
Steven Vernikoff
Donald R. Whipker
John H. Whiteley, PhD
C.T. "Dickie" Yu, PhD

2008 NEW LEADERSHIP BOARD OF DIRECTORS

Sharon C. Gomez
Vice President

Denis W. Keyes, PhD
Member-at-Large

2009 AAIDD FELLOW

Susan L. Parish, PhD

CONFERENCE PLANNING COMMITTEE

Joanna Pierson
Chair

Sharon Gomez
Mike Wehmeyer
Cameron Neece
Wayne Silverman
Sidney Blanchard
Valerie Bradley
Joe Caldwell
Patricia Harmon
Sidney Katz
David Rotholz

THANK YOU TO OUR LOCAL ARRANGEMENTS COMMITTEE

Sharon Gomez
Roni Jo Frazier
Hilda Trahan
Yvonne Miller-Nixon
Chrys Vildibill
Sharon Delvisco
Elizabeth Kurfiss-Watts





PAST PRESIDENTS

The history of the AAIDD is long and distinguished.
Our tradition, professional standing, and leadership in the area of intellectual and
Developmental disabilities are exemplified in the persons of our Presidents.

Our former Presidents are:

1876-1877	Edouard Sequin, MD	1921-1922	Joseph H. Ladd, MD	1965-1966	I. Ignacy Goldberg, EdD
1877-1878	Hervey B. Wilbur, MD	1922-1923	C. Banks McNairy, MD	1966-1967	Marguerite J. Hastings
1878-1879	G. A. Doren, MD	1923-1924	Walter E. Fernald, MD	1967-1968	Harvey F. Dingman, PhD
1879-1880	H. M. Knight, MD	1924-1925	Groves B. Smith, MD	1968-1969	Richard Koch, MD
1880-1881	Charles T. Wilbur, MD	1925-1926	Arthur R.T. Wylie, MD	1969-1970	Wesley D. White, EdD
1881-1882	George W. Brown, MD	1926-1927	Benjamin W. Baker, MD	1970-1971	Horace Mann, PhD
1882-1884	J.Q.A. Stewart, MD	1927-1928	Edward R. Johnstone	1971-1972	Robert L. Erdman, EdD
1884-1885	A.H. Beaton, MD	1928-1929	George E. McPherson, MD	1972-1973	Michael J. Begab, PhD
1885-1886	F.M. Powell, MD	1929-1930	George L. Wallace, MD	1973-1974	David Rosen, MS
1886-1887	William B. Fish, MD	1930-1931	H.H. Ramsey, MD	1974-1975	James D. Clements, MD
1887-1888	George H. Knight, MD	1931-1932	Harvey M. Watkins, MD	1975-1976	Sue Allen Warren, PhD
1888-1889	J. C. Carson, MD	1932-1933	Howard W. Potter, MD	1976-1977	Burton Blatt, EdD
1889-1890	A.C. Rogers, MD	1933-1934	Ransom A. Greene, MD	1977-1978	Margaret J. Giannini, MD
1890-1891	J. T. Armstrong, MD	1934-1935	Mary M. Wolfe, MD	1978-1979	Richard C. Scheerenberger, PhD
1891-1892	Isaac N. Kerlin, MD	1935-1936	Edgar A. Doll, PhD	1979-1980	Marjorie H. Kirkland, MSSW
1892-1893	Walter E. Fernald, MD	1936-1937	Benjamin O. Whitten, MD	1980-1981	H. Carl Haywood, PhD
1893-1894	A.E. Osborne, MD	1937-1938	Harry C. Storrs, MD	1981-1982	Frank A. Borreca, EdD
1894-1895	A.W. Wilmarth, MD	1938-1939	Neil A. Dayton, MD	1982-1983	A. Gail O'Connor, PhD
1895-1896	Samuel J. Fort, MD	1939-1940	Frederick Kuhlmann, PhD	1983-1984	Herbert J. Grossman, MD
1896-1897	Martin W. Barr, MD	1940-1941	Meta L. Anderson, PhD	1984-1985	B.R. (Bill) Walker, PhD
1897-1898	George A. Brown, MD	1941-1942	Fred O. Butler, MD	1985-1986	H. Rutherford Turnbull III, LLB, LLM
1898-1899	Mary J. Dunlap, MD	1942-1943	Horatio M. Pollock, PhD	1986-1987	Harold Michal-Smith, PhD
1899-1900	Alexander Johnson	1943-1944	C. Stanley Raymond, MD	1987-1988	Valaida S. Walker, EdD
1900-1901	W.A. Polglase, MD	1944-1945	E. Arthur Witney, MD	1988-1989	Robert G. Griffith, EdD
1901-1902	F.W. Keating, MD	1945-1946	Mabel A. Matthews	1989-1990	James W. Ellis, JD
1902-1903	J.M. Murdoch, MD	1946-1947	Warren G. Murray, MD	1990-1991	Robert R. Bruininks, PhD
1903-1904	Edward R. Johnstone	1947-1948	Lloyd N. Yepsen, PhD	1991-1992	Jack A. Stark, PhD
1904-1905	A.H. Beaton, MD	1948-1949	Edward J. Humphreys, MD	1992-1993	Michael R. Dillon, EdD
1905-1906	George Mogridge, MD	1949-1950	Mildred Thomson	1993-1994	David L. Braddock, PhD
1906-1907	W.H.C. Smith, MD	1950-1951	Richard H. Hungerford	1994-1995	Karen L. Middendorf
1907-1908	Charles Bernstein, MD	1951-1952	Edward J. Engberg, MD	1995-1996	William E. Kiernan, PhD
1908-1909	W.N. Bullard, MD	1952-1953	Bertha M. Luckey, PhD	1996-1997	Pamela C. Baker, PhD
1909-1910	Miss Mattie Gundry	1953-1954	Arthur T. Hopwood, MD	1997-1998	Robert L. Schalock, PhD
1910-1911	Arthur R.T. Wylie, MD	1954-1955	Gale H. Walker, MD	1998-1999	Stanley S. Herr, J.D., DPhil
1911-1912	H.G. Hardt, MD	1955-1956	Arthur E. Westwell, DMD	1999-2000	Bernard R. Wagner, PhD
1912-1913	Allan E. Carrol, MD	1956-1957	Thomas L. McCulloch, PhD	2000-2001	Cathy Ficker Terrill, MS
1913-1914	J.K. Kutnewsky, MD	1957-1958	Chris J. DeProspro, EdD	2001-2002	Steven F. Warren, PhD
1914-1915	H.H. Goddard, PhD	1958-1959	George Tarjan, MD	2002-2003	Ruth A. Luckasson, JD
1915-1916	Charles Bernstein, MD	1959-1960	Frances M. Coakley	2003-2004	Ann P. Turnbull, EdD
1916-1917	E.J. Emerick, MD	1960-1961	Edward L. Johnstone	2004-2005	David L. Coulter, MD
1917-1918	George L. Wallace, MD	1961-1962	Herschel W. Nisonger	2005-2006	Valerie J. Bradley, MA
1918-1919	Charles S. Little, MD	1962-1963	William Sloan, PhD	2006-2007	Henry "Hank" A. Bersani, PhD
1919-1920	George S. Bliss, MD	1963-1964	George L. Wadsworth, MD	2007-2008	David A. Rotholz, PhD
1920-1921	H. A. Haynes, MD	1964-1965	Harvey A. Stevens		

New Titles From AAIDD!

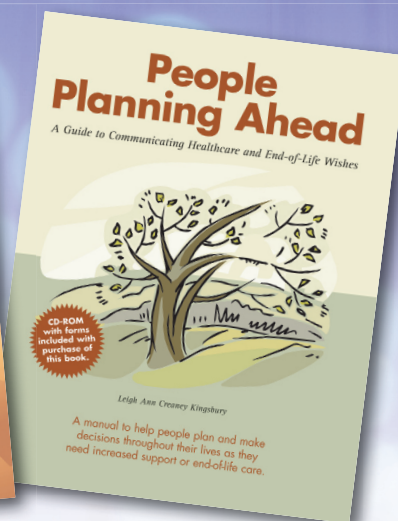
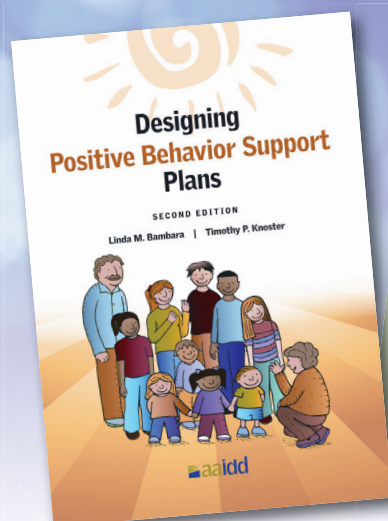

Designing Positive Behavior Support Plans (Second edition)

Linda M. Bambara and Timothy P. Knoster

This practical and easy-to-read reference helps school teams understand, design, and evaluate positive behavior support plans for students with developmental disabilities.

- » Valuable reference for teachers, parents, providers, and students in psychology and special education!
- » Strategies help create respectful and caring environment for children
- » Replete with examples, tips, forms, and checklists
- » Includes clear directions for using assessments to design individualized PBS plans
- » Describes abridged process for students with less intensive problem behavior
- » Contains updated case study, sample support plans, progress evaluation summary, and frequently asked questions
- » New edition includes twice the subject matter with several updates and new chapter on implementing support plans successfully

Item No: 270. . . . \$24.95

2009 Paperback 7X10

115 pages

ISBN: 978-1-935304-03-6

"This text is a gem because it addresses the concepts of Positive Behavior Support without compromising on scientific integrity or overloading the reader with obscure behavioral terms."

—WILL OVERFELT, MAT, BCaBa

Autism Outreach Services, Buncombe County Schools

People Planning Ahead: Communicating Healthcare and End-of-Life Wishes

AAIDD Training Available!

Leigh Ann Creaney Kingsbury

People Planning Ahead provides a comprehensive and structured way to ensure that loved ones receive care respecting their wishes and conforming to their personal, cultural, and religious beliefs during times of chronic and terminal illness, or severe disability.

- » Provides a structured way for planners to gather and organize information on a person's values, goals, and life and turn it into a detailed life plan
- » Ensures that the clearest and most detailed portfolio of the individual is available for families and professionals
- » Contains detailed planning forms on CD-ROM to store and archive information
- » Based on the principles of Person-Centered Thinking skills
- » Author-led AAIDD training workshops available for organizations providing end-of-life care

Item No: 390. . . . \$19.95

2009 Paperback with CD-ROM 8.5 X 11

62 pages

ISBN: 978-0-940898-98-1

"As a practicing physician, I consider this manual to be an invaluable resource for assessing an individual's quality of life and preserving true continuity of person-centered aspects of care across a variety of settings."

—IRA BYOCK, MD

Director of Palliative Care,
Dartmouth-Hitchcock Medical Center



TO ORDER:

Mail: AAIDD Publications, P.O. Box 25 Annapolis Junction, MD 20701-0025
Ph: 301-604-1340 Fax: 301-206-9789 Web: <http://bookstore.aidd.org>

QUESTIONS?

Email: books@aidd.org

AAIDD MEMBERS GET A 15% DISCOUNT ON ALL PURCHASES