

FINAL PROGRAM

Race to Catch the Future

AAIDD 137th Annual Conference

June 3–6, 2013 • Pittsburgh, Pennsylvania

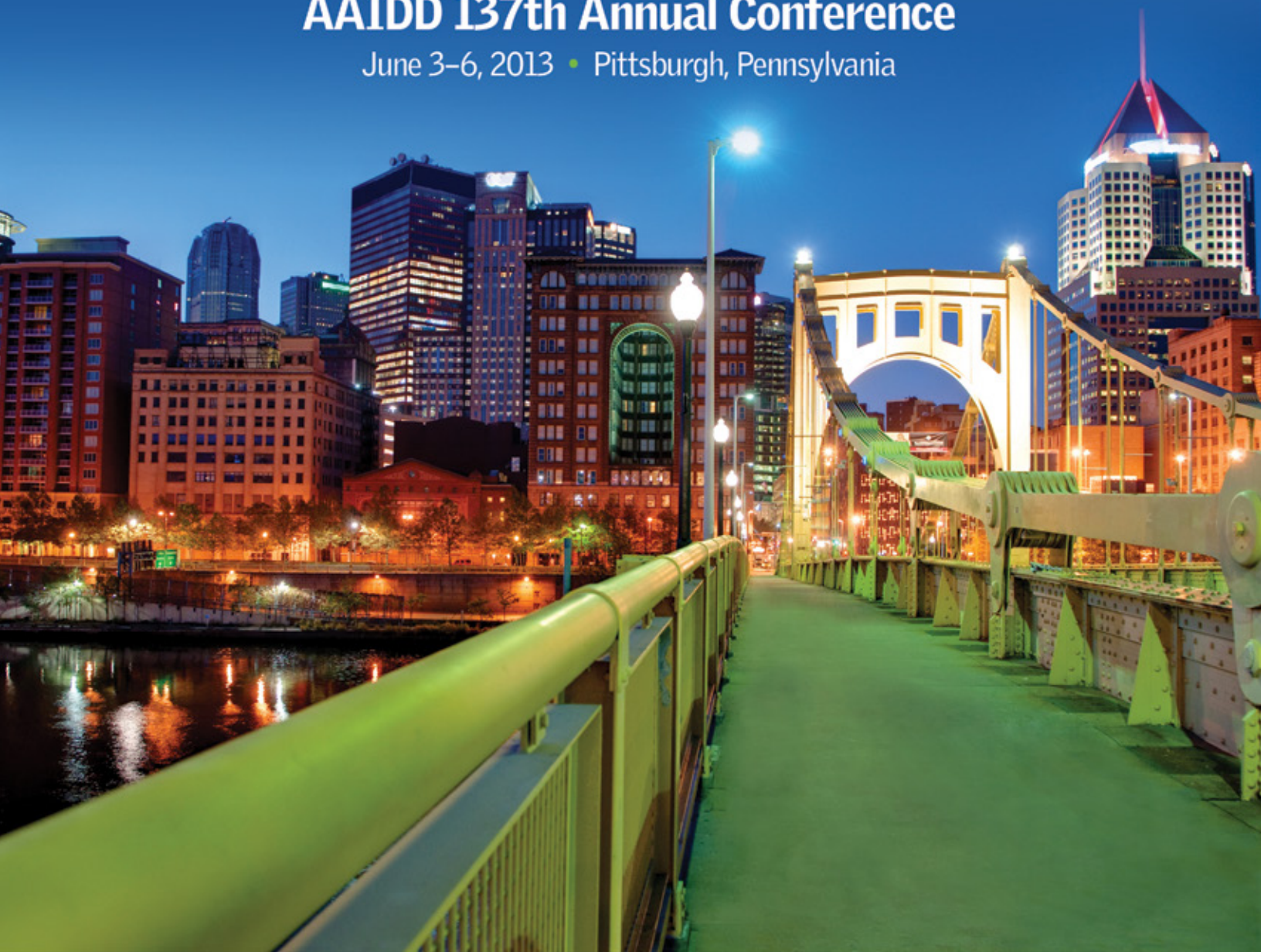

 **aaidd**

American Association
on Intellectual and
Developmental Disabilities



Knowledge | Support | Empowerment



Welcome to the Steel City and AAIDD's 137th annual meeting! We have an exciting program for *Race to Catch the Future*. This year's conference program reflects the impressive diversity and high caliber of researchers, clinicians, educators and policy professionals that make up AAIDD, the premiere interdisciplinary professional association in the field of intellectual and developmental disabilities.

I want to take this opportunity to thank my fellow AAIDD Board members who have worked diligently this past year to ensure the continued growth and relevance of our organization. None of this would be possible without Margaret Nygren, EdD, our Executive Director/CEO, who has continued to direct our association and its staff in her usual masterful way, and the AAIDD has thrived and continued to grow its outreach under her skillful leadership. Of course, all our great work could not happen without the dedication and efforts of our national office staff. We truly have a committed and highly qualified staff that understands the field of intellectual and developmental disabilities and ensures the delivery of our products, activities, and services.

One important activity of any professional society is its annual meeting. The annual meeting provides our membership with an invaluable opportunity to learn and share about cutting-edge research, evidence-based practices, and relevant policies, while providing networking opportunities for and with students, early career professionals, and seasoned colleagues from across the country and around the world. The success of an annual professional meeting requires vision and leadership and for that, we are fortunate to have James R. Thompson, PhD, AAIDD President-Elect and Chairperson of this year's annual meeting. One of Jim's first actions was to assemble an impressive group of colleagues who agreed to serve on the Conference Planning Committee and volunteered their time and expertise to assist with the conference planning and reviewed the many high quality proposals. His second masterful decision was to bring together a dynamic group of AAIDD members to serve as the Local Arrangement Committee, who helped with local planning, finding volunteers, organize the silent auction, and ensure that the magic of the Steel City and the wonderful state of Pennsylvania are present at our annual meeting.

I hope you will enjoy the rich conference program but I also hope you will kick back and enjoy this beautiful city, chat with new and known colleagues, take the time to get to know one of the many bright graduate students presenting at this year's conference, mingle during one of our social events, engage presenters at the poster session, get CEUs, and have some fun in the process.

I hope I have a chance to personally greet you and chat about our great Association.

A handwritten signature in black ink that reads "Marc J. Tassé, PhD".

Marc J. Tassé, PhD, FAAIDD
President, AAIDD Board of Directors



On behalf of the Conference Planning Committee, the Local Arrangements Committee (co-chaired by Celia Feinstein and Guy Caruso), and the AAIDD staff who have worked tirelessly to put together this year's outstanding conference program, I am delighted to welcome you to AAIDD's 137th Annual Meeting, *Race to Catch the Future*.

I also have the great pleasure of welcoming you to the wonderful city of Pittsburgh. Although it is best known as the "Steel City" due its legendary steel industry, Pittsburgh is also known as the "City of Bridges" because of the 446 bridges within its city limits. I'm confident that the 15 pre- and post-conference sessions, 78 concurrent sessions, over 150 poster sessions, and the multiple networking opportunities will serve as bridges of knowledge for all who attend this year's conference. Such bridges are essential infrastructure as we create a future where people with intellectual and related developmental disabilities experience enhanced opportunities to meaningfully contribute to, and fully participate in, tomorrow's schools and society.

The pre-conference activities begin on Monday with a variety of professional workshops and leadership meetings throughout the day. The social-media presentation in the late afternoon is intended for those who aspire to Tweet are curious about the basics of today's social networking services and how they can be used to further communication in the modern world. You mustn't miss the boat on Monday night—and I mean this literally! The Gateway Clipper is docked just minutes from our hotel and we will begin boarding at 7:00 pm. Come and enjoy a nighttime cruise through the sparkling city under the twinkling stars. Not only will there be complementary deserts, but this voyage will serve as the official launch of AAIDD's newest journal, *Inclusion*.

On Tuesday the conference officially begins. I'm very excited about the opening plenary session, *A Glance Back, A Look Ahead*, with Michael Wehmeyer, Dave Edyburn, and Marty Ford, which creates context for the conference. The concurrent sessions that follow deliver a diverse array of topics and presenter disciplines. The leadership group meetings during the lunch hour offer you an opportunity to explore ways to become more involved with AAIDD and to network with kindred spirits over common interests. Personally, my favorite part of each year's conference is the poster session and reception. Every year I am struck by the collective knowledge on display and the sheer amount of hard work in the research and demonstration projects highlighted by the poster sessions. The poster session provides us all the opportunity to experience the joy that comes with being both a learner and teacher, and this year's event is not one to be missed.

Wednesday starts with the Awards Breakfast celebrating the extraordinary contributions of an impressive group of honorees. The Wednesday morning plenary session, *Looking Across the Lifespan*, with Cate McClain, Erik Cater, and John Agosta, provides a framework for reflecting on knowledge shared at the conference. Once again, the concurrent sessions that follow deliver a diverse array of topics and presenter disciplines. The closing plenary, *Envisioning and Planning*, will expand on the conference theme—*Race to Catch the Future*. However, the conference will be far from over! Attendees have the option of three complementary post-conference sessions on Wednesday afternoon, and there is a full day of valuable post-conference sessions on Thursday. Robert Kennedy once said,

"The future is not a gift: it is an achievement. Every generation helps make its own future. This is the essential challenge of the present. The future does not belong to those who are content with today, apathetic toward common problems and their fellow man alike, timid and fearful in the face of bold projects and new ideas. Rather, it will belong to those who can blend passion, reason, and courage."

My sincere hope is that each of us gains just a little bit more passion, reason, and courage as a result of coming together for AAIDD's 137th Annual Meeting. Your *Race to Catch the Future* has begun—may this conference put the wind at your back and friends by your side!

A handwritten signature in dark ink that reads "James R. Thompson". The signature is written in a cursive, slightly slanted style.

James R. Thompson, PhD, FAIDD; President-Elect and Conference Chairman

Conference Planning Committee

Lynn Ahlgrim-Delzell
Giulia Balboni
Stacey Bock
Britt Butler
Yun Chung
Susan Copeland
Ellis Craig
Rothholz David
Karen Douglas
Keri Edwards
Ann Esbenson
Yvette Evans
Nathalie Garcin
Judith Gross
Susan Havercamp
Amy Hewitt
Loui Lord Nelson
Ruth Luckasson
Laura Lee McIntyre
Joanna Pierson
Ed Polloway
Holly Riddle
Geronimo Robinson
Amy Rosentein
David Rothholz
Haleigh Scott
Katie Smith

Local Arrangements Committee

Guy Caruso (Co-chair)
Celia Feinstein (Co-chair)
Brittany M. Butler
Melissa A. DiSipio
Anna J. Esbensen
Sarah Hall
Nancy Murray
Cindy Potter
Stephanie Weber

Welcome to Pittsburgh, Pennsylvania

Founded at the confluence of three rivers and steeped in history, Pittsburgh has reinvented itself with one of the most dramatic environmental transformations in the world. Over the past half-century, this one-time poster child for industrial pollution has emerged a clean and green city. In fact, this former "Smoky City" now ranks among the top 10 cities in the United States for certified green building space.

Pittsburgh has eliminated its infamous smoke problem and has invested in restoring its rivers and trails, nursing its beloved rivers back to health and creating some of the most popular outdoor recreational areas in the eastern United States. It's fitting that Pittsburgh, the birthplace of renowned environmentalist Rachel Carson, is today a national leader in the environmental movement and a green model for cities all over the globe. Pittsburgh is proud to be home to more than 30 certified green buildings.

Downtown Pittsburgh's Cultural District is also part of the city's inspiring story of renewal. Once a blighted part of the city, the Cultural District now includes several theaters, numerous galleries, and scores of eateries.

Whether jogging the tree-lined riverfront trails; taking in the action of the Steelers, Penguins or Pirates; discovering a world-class art scene; or exploring the city's jazz legacies, there is something to entertain everyone!



PITTSBURGH



Registration Schedule

Monday	8:00 am–5:30 pm
Tuesday	7:00 am–5:00 pm
Wednesday	7:00 am–3:00 pm
Thursday	8:00 am–12:30 pm

Exhibit Schedule

Tuesday	7:30 am–4:00 pm
Wednesday	7:30 am–12:00 pm

Come visit our exhibitors and see the latest products and services!

Complimentary continental breakfast available on Tuesday from 7:30 am–8:30 am.

Room: Ballroom Foyer

CONTENTS

Special Events	6
Annual Meeting Sponsors.....	7
Program-at-a-Glance.....	8
Annual Meeting Program.....	9
Annual Membership Meeting and Leadership Forum.....	9
Pre-Conference Meetings.....	9
Plenary Sessions.....	13, 17, 20
Concurrent Sessions.....	13, 14, 15, 18, 19
Poster Sessions.....	26
Post Conference Meetings.....	23
Students and Early Career Professional Program	11
Sibling Leadership Network Conference	23
Leadership Groups Business Meetings.....	34
General Information	25
Guide to Exhibitors.....	35
Floor Plans	39



Silent Auction

A silent auction will be held in the Exhibit Area during regular exhibit hours. Be sure to bid on items of your choice! Bidding closes at 12:00 noon on Wednesday, June 5th.

The auction's proceeds will benefit **Self-Advocates United as 1 (SAU1)**.

Monday, June 2 | 9:00–10:00 am

**AAIDD Open Annual
Membership Meeting
and Leadership Forum**

Room: Ballroom 3

Sunday, June 2

8:00 – 9:00 pm

PRESIDENT'S RECEPTION

Open to all conference attendees at no additional cost

Marc J. Tassé, FAAIDD, President, AAIDD Board of Directors, invites attendees to join the Board at this informal reception.

Room: Kings North

Monday, June 3

5:00 – 6:30 pm

SOCIAL MEDIA FOR SOCIAL GOOD

Open to all conference attendees at no additional cost.

Join us to learn about how to effectively engage audiences through Facebook, Twitter, LinkedIn, YouTube, and Pinterest.

Room: Ballroom 3

7:30 – 8:30 pm

THREE RIVERS RECEPTION

(Ticket required, cost \$10)

All attendees are invited to join co-editors Michael Wehmeyer, PhD, FAAIDD, and Karrie Shogren, PhD, FAAIDD, at a reception on Pittsburgh's three rivers celebrating the launch of the Association's newest journal, *Inclusion*.

Limited number of tickets available at the registration desk.

Offsite location

Tuesday, June 4

7:00 – 8:30 pm

AAIDD JOURNAL RECEPTION

Open to all conference attendees at no additional cost.

AAIDD is pleased to host a reception featuring its journals and their editors. Meet your favorite editors in a cocktail party atmosphere.

Room: Ballroom 3

8:30 – 9:30 pm

STUDENT AND EARLY CAREER PROFESSIONAL NETWORKING RECEPTION

Open to Student and Early Career Professionals at no additional cost.

Collegial networking event.

Room: Ballroom 4

Wednesday, June 5

8:00 – 9:00 am

AWARDS BREAKFAST

Open to all conference attendees at no additional cost.

AAIDD is pleased to recognize its members and others for their service to the field with awards. Join us in honoring their accomplishments at this year's Awards Breakfast

Room: Ballroom

4:00 – 5:00 pm

SCREENING OF 2013 AAIDD MEDIA AWARD: VECTORS OF AUTISM

Open to all conference attendees at no additional cost.

Room: Ballroom 3

Congratulations

to the 2013 AAIDD Award Recipients

Dybwad Humanitarian Award.....	Geert Van Hove, PhD
Early Career Award.....	Zachary E. Warren, PhD
Education Award.....	Melanie H. Johnston, MA
Full Community Inclusion Award.....	Tangram
International Award.....	Jos van Loon, PhD
Leadership Award.....	Ann Cutler, MD
Media Award.....	Vectors of Autism
Research Award.....	Paul Yoder, PhD
Special Award.....	Barbara Roos Brennan
Student Award.....	Grace Francis, MA

Join us to congratulate them at the **Awards Breakfast** on Wednesday, June 5 at 8:00 am

Thank you

to our Annual Meeting Generous Sponsors:



NHS Human Services
<http://www.nhsonline.org/>



Coleman Institute for Cognitive Disabilities
 UNIVERSITY OF COLORADO

**The Coleman Institute
 for Cognitive Disabilities**
<http://www.colemaninstitute.org/>

Research & Training
 Center on Community Living



**Research & Training Center on
 Community Living, Univ. of Minnesota**
www.ici.umn.edu



The Mentor Network
<http://www.thementornetwork.com/>



Institute on Disabilities
 TEMPLE UNIVERSITY*

**Institute on Disabilities,
 Temple University**
<http://www.temple.edu/instituteondisabilities/>



Nisonger Center

**Nisonger Center,
 The Ohio State University**
<http://nisonger.osu.edu/>



AAIDD Louisiana Chapter
<http://www.aaidla.com/>



**The National Leadership Consortium
 on Developmental Disabilities**
<http://www.nlccd.org/>



**Indiana Institute on Disability and
 Community, Indiana University**
<http://www.iidc.indiana.edu/>



**Paul V. Sherlock Center on Disabilities,
 Rhode Island College**
<http://www.ric.edu/Sherlockcenter/>



**Institute for Community Inclusion,
 U Mass Boston**
<http://www.communityinclusion.org/>



**Westchester Institute
 for Human Development**
 Creating Better Futures

**Westchester Institute
 for Human Development**
<https://www.wihd.org/>



**Department of Disability and
 Human Development,
 University of Illinois at Chicago**
<http://www.ahs.uic.edu/dhd/>



**Institute for Human Development,
 University of Missouri-Kansas City**
<http://www.ihd.umkc.edu/>



Achieva
<http://www.achieva.info/>



Passavant Memorial Homes
<http://www.passavant.org/>



Health Risk Screening
<http://www.hrstonline.com>



**Institute on Public Policy
 for People with Disabilities**
<http://instituteonline.net/>

Program-at-a-Glance

Morning

MONDAY	TUESDAY	WEDNESDAY	THURSDAY
<p>Continental Breakfast 7:30–9:00 am</p> <p>Open Membership Meeting and Leadership Forum 9:00–10:00 am</p> <p>The Assembly The Conference 10:15–11:30 am</p>	<p>Continental Breakfast 7:00–8:30 am</p> <p>Leadership Groups Business Meetings 8:00–9:00 am</p> <p>Exhibits Open 7:30 am–4:00 pm</p> <p>New Attendees Meeting 8:00–8:30 am</p> <p>Opening Plenary Session 9:00–10:30 am</p> <p>Break 10:30–10:45 pm</p> <p>Concurrent Sessions A 10:45–12:15 pm</p>	<p>Leadership Groups Business Meetings 7:00–8:00 am</p> <p>Exhibits Open 7:30 am–12:00 pm</p> <p>Awards Breakfast 8:00–9:00 am</p> <p>Plenary Session 9:00–10:30 am</p> <p>Break 10:30–10:45 am</p> <p>Concurrent Sessions D 10:45 am–11:45 pm</p>	<p>Continental Breakfast 7:30–9:00 am</p> <p>Religion & Spirituality Division Forum 9:00 am–12:00 noon</p> <p>Post-Conference Sessions 9:00 am–12:00 pm and 9:00 am–5:00 pm</p>
<p>Leadership Group Meetings Lunch 11:30 am–1:00 pm</p>	<p>Leadership Group Meetings Lunch 12:15–1:45 pm</p>	<p>Lunch on your own 11:45 am–1:00 pm</p>	<p>Lunch Provided 12:00–1:00 pm</p>

Afternoon

<p>Pre-Conference Sessions 1:00–4:00 pm</p>	<p>Concurrent Sessions B 1:45–3:15 pm</p> <p>Break 3:15–3:30 pm</p> <p>Concurrent Sessions C 3:30–5:00 pm</p>	<p>Concurrent Sessions E 1:00–2:00 pm</p> <p>Break 2:00–2:15 pm</p> <p>Closing Plenary Session 2:15–3:45 pm</p>	<p>Post-Conference Sessions Continue</p>
--	--	--	---

Evening

<p>Social Media for Social Good 5:30–6:30 pm</p> <p>Three Rivers Reception 7:30–8:30 pm</p> <p>Local Arrangements Committee Reception 8:45–9:45 pm</p>	<p>Poster Sessions and Reception 5:00–7:00 pm</p> <p>Journals Reception 7:00–8:30 pm</p> <p>Student and Early Career Professionals Networking Reception 8:30–9:30 pm</p>	<p>Screening of the 2013 Media Award: Vectors of Autism 4:00–5:00 pm</p> <p>Post Conference Sessions 4:00–6:00 pm</p>	
---	---	---	--

Sunday, June 2

5:00 pm – 8:00 pm

Board of Directors Meeting

Presiding: Marc. J. Tasse, PhD,
President, AAIDD Board of Directors

8:00 pm – 9:00 pm

President's Reception

Open to all conference attendees
at no additional cost.

Room: Kings North

Monday, June 3

Registration

8:00 am–5:30 pm

7:30 – 9:00 am

Complimentary Continental Breakfast

Room: Ballroom 3

9:00 – 10:00 am

Annual Open Membership Meeting and Leadership Forum

Presiding: Marc J. Tassé, PhD, FAAIDD,
President, AAIDD Board of Directors

Room: Ballroom 3

10:15 – 11:30 am

The Assembly of Geographic Interests

Presiding: James R. Thompson, PhD, FAAIDD,
President-Elect, AAIDD Board of Directors

Room: Brigade

10:15 – 11:30 am

The Conference of Professional Interests

Presiding: Amy Hewitt, PhD, FAAIDD,
Vice-President, AAIDD Board of Directors

Room: Rivers

11:30 am – 1:00 pm

Lunch

Business meetings **and** general seating with ticket—
purchase your lunch ticket at the registration desk.

Fee \$20

Room: Ballroom 3

PRE-CONFERENCE MEETINGS

1:00 – 4:00 pm

The Supports Intensity Scale®: The Intersection of Training and Data Quality, Integrity, and Utility

APPROVED FOR 3 NASW SOCIAL WORK CE, 3 APA CE UNITS

Moderator:

Ravita Maharaj, PhD, AAIDD

Presenters:

Wil Buntix, PhD, FAAIDD, Maastricht University, Buntinx
Training & Consultancy

Jon Fortune, EdD, FAAIDD, Human Services Research Institute

Michael Chapman, MEd, AAIDD SIS Trainer

Ruth Pellman, Government of Ontario, AAIDD SIS Trainer

This workshop focuses on lessons learned about the integrity and utility of SIS data at the individual, program, and jurisdictional levels. Facilitators will use examples from North America and the Netherlands to discuss the impact of SIS (Adult and Child versions), and how quality data influences a strong program foundation. This workshop will assist participants recognize the significance of quality SIS data and its impact on the individual's life; utilize strategies to assure SIS data integrity at the individual, program, and jurisdictional level; and describe key factors that influence the quality enhancement process including the Interviewer Reliability Qualifications Review.

Fee \$45

Room: Benedum

1:00 – 4:00 pm

NADD Symposium: Mental Health Aspects in Persons With Autism

APPROVED FOR 3 NASW SOCIAL WORK CE, 3 APA CE UNITS

Moderator:

Robert Fletcher, DSW, National Association for the Dually
Diagnosed

Presenters:

John McGonigle, PhD, Western Pennsylvania Region Autism
Center, Western Psychiatric Institute and Clinic, University
of Pittsburgh School of Medicine

Martin Lubetsky, MD, Western Psychiatric Institute,
Children's Hospital of Pittsburgh, University of Pittsburgh
School of Medicine

The workshop will focus on understanding the behavioral health concerns of individuals with Autism Spectrum Disorders. The presentation will address issues regarding diagnosing ASD across the lifespan and co-occurring psychiatric diagnoses, utilizing Functional Behavior Assessments in differentiating problem behavior from psychiatric syndromes, designing best practice approaches for intervention planning including medications and assessing response to medications, and presenting mental health information to psychiatrists.

Fee \$45

Room: Allegheny

Monday, June 3 *(continued)*

1:00 – 4:00 pm

IASSIDD Symposium: Research and Practice in Aging and Positive Psychology Across the World

APPROVED FOR 3 NASW SOCIAL WORK CE, 3 APA CE UNITS

Moderator:

Jos van Loon, PhD, Ghent University

Presenters:

Tamar Heller, PhD, University of Illinois-Chicago

Michael L. Wehmeyer, PhD, FAAIDD, University of Kansas, IASSIDD Vice President for the Americas

This session will provide an overview of research to practice issues in two areas—aging with intellectual and developmental disabilities and self-determination—that are receiving considerable attention across the world. Tamar Heller will provide a comprehensive examination of the research knowledge base in aging and intellectual and developmental disabilities and discuss international efforts to implement practices to improve the quality of life of aging people with intellectual and developmental disabilities. Michael Wehmeyer will, similarly, provide a comprehensive examination of the application of positive psychology to intellectual and developmental disabilities, drawing from the *International Handbook of Positive Psychology and Disability* and focusing on the application of concepts such as hope, optimism, self-determination, and other positive psychological constructs to practice in intellectual and developmental disabilities.

FEE: \$45

Room: Heinz

1:00 – 4:00 pm

Practical Concerns for Integration and Promoting the Use of the Health Care Guidelines for Individuals With Intellectual and Developmental Disabilities

APPROVED FOR 3 NASW SOCIAL WORK CE, APA CE UNITS

Moderator:

Joseph P. O’Grady, MD, FAAIDD, Medical College of Wisconsin

Presenters:

Peter J. Smith, MD, MA, FAAIDD, University of Chicago

Carl Tyler, MD, Cleveland Clinic

Yona Lunsky, PhD, FAAIDD, University of Toronto

Susan Havercamp, PhD, FAAIDD, The Ohio State University

Larry Gray, MD, University of Chicago

David O’Hara, PhD, Westchester Institute for Human Development

This session will describe the (a) process of implementation of the AAIDD health care guidelines at one of the premier health care systems in the USA; (b) process of implementation of the Canadian health care guidelines within a country that has universal health care; (c) creation of multi-site (and multi-state) patient

registries, highlighting their usefulness as tools for advocacy, research, and education; (d) creation of mobile applications (e.g., for the iPad) for both clinicians and families/individuals; (e) framework that colleagues have created to help clinicians navigate difficult conversations; and (f) structures and oversight organizations involved in the training of doctors. The model, its applications, and difficulties in convincing medical schools to include training about the health guidelines for individuals with intellectual and developmental disabilities will also be discussed.

FEE: \$45

Room: Forbes

5:00 – 6:30 pm

Social Media Session

Open to all conference attendees at no additional cost.

Moderator:

Jason Epstein, AAIDD

Presenters:

Danielle Webber, MSW, AAIDD

Michelle Hart, AAIDD

Luke Q. Stafford, Mondo Mediaworks



Join us to learn about how to effectively engage audiences through Facebook, Twitter, LinkedIn, YouTube, and Pinterest. During this session you will learn more about several useful resources and pick up strategies for maximizing your content whether you are new to social media or an active user already.

During this session, one lucky attendee who successfully completed our “social media challenge” in the weeks leading up to the conference will win their very own 32 GB Google Nexus 7 e-reader tablet!

Room: Ballroom 3

Three Rivers Reception on the Gateway Clipper

7:30 – 8:30 pm

(Embarking time: 7:00 – 7:30 pm)

Limited tickets available at the registration desk, Fee: \$10.

Co-editors Michael Wehmeyer, PhD, FAAIDD and Karrie Shogren, PhD, FAAIDD, invite all attendees to join them at a reception

on Pittsburgh’s three rivers to celebrate the launch of the Association’s newest journal, *Inclusion*.



8:45–9:45 pm

**Local Arrangements
Committee Reception**

Room: President's Suite

**Student and Early Career
Professionals Activities**

If you are a Student or an Early Career Professional, you are particularly invited to join us for the following events:

Sunday, June 2

President's Reception

8:00 – 9:00 pm

Room: Kings North

Monday, June 3

Three River's Reception

7:30 – 8:30 pm

Ticket required—limited tickets available at registration

Tuesday, June 4

**Student and Early Career Professionals
Networking Reception**

8:30 – 9:30 pm

Room: Ballroom 4

Wednesday, June 5

**Students and Early Career Professionals
Lunch Meeting**

11:45 – 1:00 pm

Lunch tickets required—limited capacity
Tickets available at registration

Room: Ballroom 3



Please be aware that we are recording some sessions and there will be a video camera in the room. The camera will be fixed on the presenters, and we do not expect that any participants will be filmed.

*The Religion & Spirituality Division
is pleased to present the*

**2013 Henri J.M. Nouwen
Leadership Award**

to Sister Gabrielle Kowalski, OSF, PhD

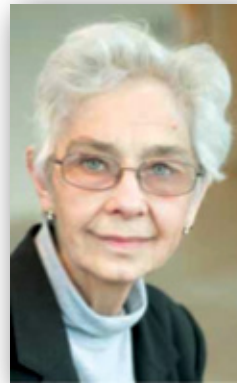

For over 40 years, Sr. Gabrielle Kowalski has been a powerful and effective advocate for people with intellectual and developmental disabilities, particularly with regard to understanding, respecting, and supporting their spiritual lives.

She began her career as a special education teacher in 1963 and went on to become Professor of Special Education and Associate Dean for Teacher Education at Cardinal Stritch University.

Sister Gabrielle has had a direct impact on students with disabilities, and has helped shape the careers of other professionals and the perspectives of professional organizations. She served as editor of the newsletter of the National Apostolate for Inclusion Ministry (NAfIM); president and past president of the AAIDD Religion and Spirituality Division; and member of the Division's Work Group on Certification for Spiritual Support Professionals.

Her work has been published in numerous journals, including those of AAIDD. In addition, she is a sought-after presenter at state and national conferences and has used those opportunities to raise the level of thinking among religious professionals.

Highly regarded among her professional and academic colleagues, Sister Gabrielle was named Professor Emeritus by Cardinal Stritch University in 2012. The Religion and Spirituality Division is pleased to recognize Sister Gabrielle's good work.

137th AAIDD Annual Meeting Continuing Education Requirements

AAIDD is pleased to be providing continuing education units in both social work and psychology to interested participants during the pre- and post- conference sessions at this year's Annual Meeting. If you pre-registered for CEU's you should have received an attendance card upon check-in along with your registration materials. If you did not receive this card in your envelope or registered for CEU's onsite please be sure to pick one up at registration.

To receive continuing education credits you must have a room monitor sign off on your attendance card at the end of each pre- and post- conference session you attend. You must also complete an evaluation which is to be handed in at registration. Failure to complete both of these requirements will result in no continuing education award for that session. To receive credit for any session you must participate in the session in its entirety. Partial credit will not be awarded to participants who choose to float between sessions.

National Association of Social Workers (Social Work)

Up to 13 CE units for Social Workers

This program is approved by the National Association of Social Workers (Approval #886593756-1755) for up to 13 contact hours of Continuing Education Credits.

American Psychological Association (Psychology)

The University of Tennessee Boling Center for Developmental Disabilities (BCDD) is approved by the American Psychological Association to sponsor continuing education for psychologists. The University of Tennessee BCDD maintains responsibility for this program and its content. The BCDD is offering these activities for as many as 12 continuing education credits.

AAIDD adheres to the *APA Ethical Principles of Psychologists*.

A grievance procedure is available to all participants and may be located on the conference website at www.aidd.org.

A participant fee statement and refund policy is also available to all participants and may be located on the conference website at www.aidd.org.

Congratulations to our Student Scholarship Winners:

Student & Early Career Professional SIG

- Mathew Brock, Vanderbilt University
- Scott Kupferman, Utah State University

Psychology Division

- Haleigh Scott, The Ohio State University
- Margaret Mehling, The Ohio State University

Mental Health Division

- Whitney Brooks, The Ohio State University

Gerontology Division

- Scott Landers, University of Florida

Please stop by the

AAIDD Bookstore

located in the Ballroom Foyer
to examine our new AAIDD
books and journals!



Career Center

Do you have a job to fill in the field of
intellectual or developmental disabilities?
AAIDD's Career Center can help.

For more information, visit www.aidd.org

Join AAIDD

AAIDD is the definitive membership organization
and the authoritative source of information for
those in the intellectual disability profession.

To explore membership options,
visit us at www.aidd.org

Knowledge | Support | Empowerment

Tuesday, June 4

Registration
7:00 am – 5:00 pm

7:30 am – 8:30 am
Complimentary Continental Breakfast

7:30 am – 4:00 pm

Exhibit Time

For a complete list of Exhibitors see pages 35–38.

Room: Ballroom Foyer

Breakfast Sponsored by: NHS Human Services

LEADERSHIP GROUPS BUSINESS MEETINGS

7:00 am – 9:00 am

Health and Wellness Action Group

Presiding: Joseph O’Grady, Jr, MD, FAAIDD

Room: Traders

8:00 am – 9:00 am

Gerontology Division

Presiding: Nancy Jokinen, MSW, PhD

Room: Boardroom

8:00 am – 9:00 am

Legal Process and Advocacy Division

Presiding: Caroline Everington, PhD

Room: Stanwix

8:00 am – 9:00 am

Mental Health Services Special Interest Group

Presiding: Vincent M. Chesney, MS, FAAIDD

Room: Chartiers

8:00 am – 9:00 am

Region V Meeting

Presiding: Ellis (Pat) Craig, PhD, FAAIDD

Room: Heinz

8:00 am – 9:00 am

Region IX/NJ Chapter

Presiding: Sidney Blanchard, FAAIDD

Room: Allegheny

OPENING PLENARY SESSION

9:00 am–10:30 am

OPENING SESSION

Welcome: Marc J. Tassé, PhD, FAAIDD, President, AAIDD Board of Directors

OPENING PLENARY

Race to Catch the Future:

A Glance Back, A Look Ahead

*Michael L. Wehmeyer, PhD, FAAIDD
Professor, Department of Special Education
Director, Kansas University Center on
Developmental Disabilities
University of Kansas*

*Dave Edyburn, PhD
Professor, Department of Exceptional Education
University of Wisconsin–Milwaukee*

*Marty Ford, JD
Chief Public Policy Officer, The Arc*

Room: Ballroom 1 & 2

8:00 – 8:30 am

Orientation for First Time Annual Meeting Attendees

If this is your first AAIDD Annual Meeting, please join us for an orientation.

Presiding: Marc J. Tassé, PhD, FAAIDD, President, AAIDD Board of Directors

Room: Rivers

10:30 am – 10:45 am

Break

CONCURRENT SESSIONS A

10:45 am – 12:15 pm

DOWN SYNDROME AND DEMENTIA



Moderator: Tamar Heller, PhD, University of Illinois at Chicago

Down Syndrome and Alzheimer’s Disease

*Wayne Silverman, PhD, FAAIDD, Kennedy Krieger Institute
Warren Zigman, PhD, FAAIDD, New York State Institute for Basic Research in Developmental Disabilities*

Joseph Lee, PhD, Columbia University

Nicole Schupf, PhD, Columbia University

Room: Benedum

Tuesday, June 4 *(continued)*

DSM-5 AND AUTISM SPECTRUM DISORDER

Moderator: *Nathalie Garcin, PhD, Gold Learning Centre*

DSM-5 and ICD-11: Possible Implications for Intellectual Disability and Autism Spectrum Disorder

Jarrett Barnhill, MD, University of North Carolina at Chapel Hill

Marc J. Tassé, PhD, FAAIDD, The Ohio State University

Ruth Luckasson, JD, FAAIDD, University of New Mexico

Room: Brigade

SEXUALITY

Moderator: *Melissa DiSipio, MS, FAAIDD, Philadelphia Coordinated Care*

The ID Project

Leslie Walker-Hirsch, MEd, FAAIDD, Social Development and Sexuality Consultant

Room: Duquesne

PARENTS AND INCLUSIVE EDUCATION

Moderator: *Judith Gross, PhD, University of Kansas*

"Eye on the Prize:" Parents' Beliefs About the Benefits of Inclusive Education

Priya Lalvani, PhD, Montclair State University

In the Hands of Parents: The Key to Future Success of Inclusive Education

Marina Dupasquier, MA, McGill University

Tara Flanagan, PhD, McGill University

Hailey Sobel, MA, McGill University

Parent Involvement in the IEP Process. What Might Parents who do not Attend Tell us?

Andria Young PhD, University of Houston-Victoria

Room: Birmingham

RESTRAINT REDUCTION

Moderator: *Vincent M. Chesney, MS, FAAIDD, Commonwealth of Pennsylvania*

Restraint Reduction Practices: Analyses of Individual Program and Organizational Contingencies

Terry Page, PhD, AdvoServ

Zachary Houston, MS, QBS, Inc.

David Lennox, PhD, QBS, Inc.

Room: Smithfield

HEALTH CARE ETHICS

Moderator: *J. Carolyn Graff, PhD, RN, FAAIDD, University of Tennessee*

For a Future: The "Deathmaking" of People who are Vulnerable Needs to Stop

Guy Caruso, PhD, Temple University

Integrated Multidisciplinary Primary Healthcare: Tailoring Healthcare to the Needs and Experiences of Individuals With Intellectual and Developmental Disabilities

David Ervin, MBA, The Resource Exchange

Ashley Williams, PhD, The Resource Exchange

Ethics and Intellectual Disability: A Conversation

Peter J. Smith, MD, MA, FAAIDD, University of Chicago

Room: Fort Pitt

12:15 – 1:45 pm

Lunch

Business meetings and general seating with ticket—purchase your lunch ticket at the registration desk

Fee \$20

Room: Ballroom 3

12:15 pm – 1:45 pm

LEADERSHIP GROUPS LUNCH MEETINGS

Ticket required (lunch fee \$20)

Education Lunch Meeting

Presiding: Amy Rosenstein, PhD

Psychology Division Lunch Meeting

Presiding: Deborah Fisher PsyD, and Rozemarijijn Staal, PsyM

International Special Interest Group

Presiding: Maria de les Salines Carbó and

Marco Lombardi, MS

Room: Ballroom 3

CONCURRENT SESSIONS B

1:45 pm – 3:15 pm

HEALTH CARE OUTCOMES

Moderator: *Lynne Tomasa, PhD, University of Arizona*

Examining the Organization of Healthcare for Adults Aging With Intellectual Disability

Nancy Jokinen, PhD, University of Northern British Columbia

Partnering With People With Developmental Disabilities to Address Health and Violence: A Community-Based Participatory Research Project

Dora Raymaker, MS, Portland State University

Katherine McDonald, PhD, Syracuse University

Older Women With Intellectual Disability's Experiences of Accessing Gynecological Care

Genevieve Breau, University of British Columbia

Jennifer Baumbush, University of British Columbia

Room: Duquesne

SELF DETERMINATION OUTCOMES

Moderator: Anna Esbensen, PhD, FAAIDD, Cincinnati Children's Hospital

Supports, Self-Determination, and Transition

Karrie Shogren, PhD, FAAIDD, University of Kansas

Carolyn Hughes, PhD, FAAIDD, Queens College, City University of New York

Erik Carter, PhD, Vanderbilt University

Angela Huntington, EdD, Lockport Township High School

Debbie Shelden, PhD, Illinois State University

Room: Brigade

POSTSECONDARY EDUCATION AND EMPLOYMENT

Moderator: Ruth Luckasson, JD, FAAIDD, University of New Mexico



Expanding Postsecondary Education for Students With Intellectual Disability: The Viability of Distance Education

Scott Kupferman, MS, Utah State University

Self-Directed Futures: Advancing Employment and Cognitive Accessibility for Students With Intellectual and Developmental Disabilities

Emily Shea Tanis, MEd, University of Colorado

Jeffery Hoehl, MS, University of Colorado

Similarities and Differences Between Postsecondary Education Programs for Students With Intellectual Disability

Colleen Thoma, PhD, Virginia Commonwealth University

Room: Benedum

PARENTS AND AUTISM SPECTRUM DISORDER

Moderator: Stacey Jones-Bock, PhD, Illinois State University

"I Can do Things Normal People Can't." Parent Influence on Self-concept for Adolescents With ASD

Kacey Vierling, Oklahoma State University

Emily Popplewell, Oklahoma State University

Jennifer Jones, PhD, Oklahoma State University

Diagnostic Differences in Caregiver Burden Among Adolescents and Young Adults With Autism Spectrum Disorder

Vanessa Vogan, Centre for Addiction and Mental Health

Johanna Lake, PhD, Centre for Addiction and Mental Health

Suzanne Robinson, MA, Centre for Addiction and Mental Health

Ami Tint, MA, Centre for Addiction and Mental Health

Examining the Relationship Between Perceived Burden and Social Support in Parents of Individuals With Autism Spectrum Disorders

Suzanne Robinson, York University

Jonathan Weiss, PhD, York University

Yona Lunsky, PhD, FAAIDD, Centre for Addiction and Mental Health

Ashleigh Blinkhorn, Queen's University

Room: Birmingham

ORGANIZATIONAL CHANGE

Moderator: Robert Schalock, PhD, FAAIDD, Schalock & Associates

Using Outcome Measures for Organizational Change

Cathy Ficker Terrill, MS, FAAIDD, The Council (CQL)

How Organizations are Overcoming The Challenges of Today: An International Perspective

Patty van Belle, MBA, Arduin

Dale Peterson, MA Alberta Catholic Social Services

Tim Lee, PhD, MBA, Taipei Vocational Training Center

Vince Scott, PhD, AZTEC

Room: Smithfield

PERSON-CENTERED SYSTEMS CHANGE

Moderator: Susan Palmer, PhD, FAAIDD, University of Kansas

A View from the Field: Innovative Programming Toward Community Inclusion

Al Condeluci, PhD, UCP/CLASS

Dori Ortman, UCP/CLASS

Mary Jo Alimena Caruso, MEd, The Watson Institute

Implementing Uniform Waiver Assessments

Nancy Shanley, Ascend Management Innovations

Room: Fort Pitt

3:15 pm – 3:30 pm

Break

CONCURRENT SESSIONS C

3:30 pm – 5:00 pm

GRIEF AND LOSS



Moderator: William Gaventa, MDiv, FAAIDD, University of Medicine & Dentistry of New Jersey

Grief and Loss in Individuals With Intellectual and Developmental Disabilities: Clinical Implications, Practical Approaches

Lara Palay, MSW, Ohio Center for Autism and Low Incidence

Room: Benedum

DIAGNOSTIC ADAPTIVE BEHAVIOR SCALE (DABS)

Moderator: Ellis (Pat) Craig, FAAIDD, Consultant

Introduction to the Diagnostic Adaptive Behavior Scale

Robert Schalock, PhD, FAAIDD, Schalock & Associates

How Item Response Theory Contributed to the Development of DABS

Marc J. Tassé, PhD, FAAIDD, The Ohio State University

Psychometric Qualities of the DABS

Giulia Balboni, PhD, FAAIDD, Università di Pisa

Room: Duquesne

Tuesday, June 4 *(continued)*

TRANSITIONING TO POST SECONDARY EDUCATION

Moderator: Amy Rosenstein, PhD, Eastern Illinois State University

A New Focus for the Future: Identifying and Creating Enabling Environments for Transition Age Youth With Intellectual and Developmental Disabilities

Jessica Kramer, PhD, Boston University

Erik Carter, PhD, Vanderbilt University

Matthew Brock, PhD, Vanderbilt University

Carolyn Hughes PhD, FAAIDD, Queens College, City University of NY

James R. Thompson, Illinois State University

Room: Birmingham

COMMUNITY INCLUSION

Moderator: Sharon Gomez, FAAIDD, Evergreen Life Services

Building Inclusive Communities through Community Members: Effective Approaches to Enlisting Community Members in Inclusion Efforts

Angela Amado, PhD, University of Minnesota

Eric Jacobson, MA, Georgia Department of Human Services

Sandra Amador Dusek, State of Pennsylvania Developmental Disabilities Council

Room: Brigade

COLLABORATION FOR IMPROVEMENT

Moderator: Joanna Pierson, PhD, FAAIDD, The Arc of Frederick County

Services in the Community: How Interagency Collaboration Can Improve Communication Supports for Adults With Intellectual and Developmental Disabilities

Carrie Leonhart, MS, Temple University

Celia Feinstein, MA, FAAIDD, Temple University

Amy Goldman, MA, MS, Temple University

Larry Pace, MA, Philadelphia Department of Behavioral Health

Room: Smithfield

EMPLOYMENT

Moderator: Laura Owens, PhD, APSE

The Social Security Administration's Youth Transition Demonstration: Program Model, Technical Assistance, and One-Year Impacts

Kelli Crane, PhD, TransCen, Inc.

Richard Luecking, EdD, TransCen, Inc.

Thomas Fraker, PhD, Mathematica Policy Research

Taylor Runner, West Virginia Human Resource Development Foundation

Room: Fort Pitt

Poster Session and Reception

5:00 pm – 7:00 pm



Refreshments provided. For a list of poster sessions please go to pages 26–33.

Room: Kings Garden Ballroom

AAIDD Journal Reception

7:00 pm – 8:30 pm

Open to all conference attendees at no additional cost.

Meet your favorite editors and in a cocktail party atmosphere. The April 2013 special issue of *IDD* on the demarcation of intellectual disability, a special limited print edition of the inaugural issue of *Inclusion*, and the November 2012 special issue of *AJIDD* on aging and end of life will be available.

Room: Ballroom 3



Student and Early Career Networking Reception

8:30 pm – 9:30 pm



Collegial networking event for students and early career professionals

Room: Ballroom 4

Sponsored by the Nisonger Center, The Ohio State University

Wednesday, June 5

Registration

7:00 am–3:00 pm

Exhibits Open

7:30 am–12:00 noon

For a list of exhibitors see pages 35–38.

Complimentary refreshments available in the exhibit area from 10:30 am.

Location: Ballroom Foyer

LEADERSHIP GROUPS BUSINESS MEETINGS

7:00 – 8:00 am

Humanist Action Group

Presiding: James Mullin, MEd

Room: Traders

7:00 – 8:00 am

Research Division

Presiding: Yona Lunsky, PhD, FAAIDD

Room: Chartiers

8:00 – 9:00 am

AWARDS BREAKFAST

Open to all conference attendees at no additional cost.

AAIDD is pleased to recognize its members and others for their service. Join us in honoring their accomplishments at this year's Awards Breakfast.

*Presiding: Nikki Murdick, PhD, FAAIDD
Awards and Fellowship Committee Chair*

Room: Ballroom 1 & 2



PLENARY SESSION

9:00 am–10:30 am

Race to Catch the Future: Looking Across the Lifespan

*Catherine McClain, MD, PT
Director, Center for Development and Disability
University of New Mexico*

*Erik Carter, PhD
Associate Professor, Department of Special Education
Vanderbilt University*

*John M. Agosta, PhD
Vice President
Human Services Research Institute*

Room: Ballroom 1 & 2

10:30 am – 10:45 am

Break

Refreshments available at the Exhibit Area

Meet our newly elected members of the Board of Directors



Susan Palmer, PhD
Vice President

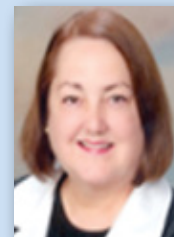

Patti Martin, MEd
Secretary-Treasurer



Susan Parish, PhD
Member-at-Large

CONGRATULATIONS TO OUR NEWEST FELLOWS

Giulia Balboni, PhD

Vincent M. Chesney, MS

Melissa DiSipio, MS

David Ferleger, JD

Climent Giné Giné, PhD

David T. Helm, PhD

Carolyn Hughes, PhD

James Lemanowicz

Barbara A. Mazzella, MS

Katherine McDonald, PhD

Joseph P. O'Grady, Jr, MD

Edward A. Polloway, PhD

Maria Quintero-Conk, PhD

J. David Smith, EdD

Miguel Ángel Verdugo Alonso, PhD

Wednesday, June 5 *(continued)*

CONCURRENT D SESSIONS

10:45 am – 11:45 am

IMPACT OF SELF-DETERMINATION

Moderator: Ann C. Williams, PhD, The Arc

The Future: Catch and Create It!

Marian Frattarola-Saulino, Pennsylvania Values Into Action

Visionary Voices: Interpreting Pennsylvania's Intellectual Disability Movement Through Oral History, Archival Preservation, and Public Performance

Celia Feinstein, MA, FAAIDD, Temple University

Lisa Sonneborn, MFA, Temple University

Room: Brigade

STATE AND NATIONAL POLICY TRENDS

Moderator: George Jesien, PhD, Association of University Centers on Disabilities

National Survey of State Policies and Practices in Behavior Support

David Rotholz, PhD, FAAIDD, University of South Carolina

Charles Moseley, EdD, National Association of State Directors of Developmental Disabilities Services

Kinsey Carlson, MPH, MSW, University of South Carolina

The Changing Face of Family Care-Giving: Age, Income and Other Factors Among Families With Adult Family Members With Intellectual and Developmental Disabilities

Julie Bershinsky, PhD, Human Services Research Institute

Valerie Bradley, MA, FAAIDD, Human Services Research Institute

Charles Moseley, EdD, National Association of State Directors of Developmental Disabilities Services

Mary Lee Fay, National Association of State Directors of Developmental Disabilities Services

Room: Benedum

RELATIONSHIPS

Moderator: James R. Mullin, MEd, Wrentham Developmental Center

Tackling the Pursuit Of Healthy Relationships

Jennifer Bohne MS, Macomb-Oakland Regional Center

Sexual Health Promotion for Young Adults With Intellectual Disability

Donna Bernert, PhD, Kent State University

Amber Walker, Kent State University

Cynthia Kenyon, MEd, Kent State University

Room: Duquesne

HOME AND COMMUNITY-BASED SERVICES PERSONNEL PREPARATION

Moderator: H. Rutherford Turnbull, III, LLB, LLM, FAAIDD, University of Kansas

National Frontline Supervisor Competency Online Toolkit: An Innovative Approach to Strengthening the Frontline Supervisor Workforce

Lori Sedlezky, MSW, University of Minnesota

Jennifer Reinke, MA, University of Minnesota

Amy Hewitt PhD, FAAIDD, University of Minnesota

Sheryl Larson, PhD, FAAIDD, University of Minnesota

Online Continuing Education: Maximizing Adult Learning Outcomes for a New Generation of Intellectual and Developmental Disabilities Professionals

Danielle Webber, MSW, AAIDD

Room: Birmingham

COMMUNICATION

Moderator: Julia B. Stoner, EdD, University of Oklahoma

Effectiveness of Proloquo2Go in Enhancing Communication for Children With Autism and Complex Communication Needs

Taylor Krcek, MSW, University of Tennessee-Knoxville

Don McMahon, MA, University of Tennessee

Effects of Augmentative and Alternative Communication on Challenging Behavior: A Meta-Analysis

Virginia Walker, MS, University of Virginia

Martha Snell, PhD, University of Virginia

Room: Smithfield

SPIRITUALITY

Moderator: Katie Arnold, MS, Sibling Leadership Network

Spirituality and Congregational Participation with Christian and Jewish Narratives of Challenge and Hope

Anne Masters, MA, RCAN

Shelly Thomas Christensen, MA, Inclusion Innovations

Spirituality, Strengths, and Well-Being of Adolescents and Young Adults With Significant Disabilities and Their Families

Erik Carter, PhD, Vanderbilt University

Thomas Boehm, MDiv, Vanderbilt University

Room: Fort Pitt

11:45 – 1:00 pm

Lunch on Your Own

11:45 am – 1:00 pm

Social Work Division Working Lunch

No cost for Social Work Division Members; tickets required.

11:45 am – 1:00 pm

Past Presidents' Lunch

By invitation only

12:15 – 1:45 pm

STUDENTS AND EARLY CAREER PROFESSIONALS LUNCHEON MEETING

The Power and Potency of Social Capital

Al Condeluci, MSW, PhD, UCP/CLASS

Please get your complementary ticket at the registration desk by Wednesday at 9:00 am.

Seating is limited; tickets distributed on first come, first served basis.

Room: Ballroom 3

Sponsored by:
The MENTOR Network

Exhibits and Silent Auction Close at Noon

Pick up Silent Auction items by 1:30 pm.

Location: Ballroom Foyer

CONCURRENT SESSIONS

1:00 – 2:00 pm

PERSON-CENTERED SERVICES

Moderator: A. Michael Bloom, MA, MS, FAAIDD, Bloom Coaching and Performance

A Journey Towards Person Centered Services

Angie Conrad, New Directions

Leanne Kennedy, New Directions

Carolyn Peters, PhD, New Directions

Charmayne Dube, PhD, New Directions

Individuals with Disabilities in Their Communities: a Flexible Model for Community Assessment and Planning

Kevin Aldridge, MA, Ohio Center for Autism and Low Incidence

Room: Brigade

CROSS-CULTURAL ASSESSMENT

Moderator: Yona Lunsky, PhD, FAAIDD, Centre for Addiction and Mental Health

Crossing Boundaries; QOL Assessment in Six Countries Using the Personal Outcomes Scale

Claudia Claes, PhD, University College & Ghent University

Jos van Loon, PhD, Ghent University

Stijn Vandeveld, PhD, University College & Ghent University

Robert Schalock, PhD, FAAID, Schalock & Associates

Assessing the Transition Needs of Youth With Intellectual and Developmental Disabilities in Korea

Youngsun Lee, PhD, Inha University, South Korea

Youjin Seong, University of Kansas

Hwan-Hee Kim, Inha University, South Korea

Ik-dong Lee, MA, Inha University, South Korea

Jeong Yun Jang, Inha University, South Korea

Room: Benedum

UNIVERSAL DESIGN IN LEARNING

Moderator: Michael L. Wehmeyer, PhD, FAAIDD, University of Kansas

Increasing Reading Scores Through the use of Universal Design for Learning and Learning by Design

Loui Lord Nelson, PhD, FAAIDD, CAST & Boston College

Peggy Coyne, EdD, CAST

iPad or iPod Touch: Managing Tasks in Classroom or Recreational Settings for Students With Intellectual Disability

Nicole Uphold, PhD, Illinois State University

Karen Douglas, PhD, Illinois State University

Room: Duquesne

SPECIAL EDUCATION ASSESSMENT AND EVALUATION

Moderator: Sarah Hall, PhD, Ashland University

Developing Test Items to Assess Students With Significant Cognitive Disabilities in the Alternate Assessment

Judith Gross, PhD, University of Kansas

Michelle Shipman, University of Kansas

Equipping Special Education Paraprofessionals to Implement Effective Practices: A Randomized-Control Trial

Matthew Brock, MA, Vanderbilt University

Erik Carter, PhD, Vanderbilt University

Room: Birmingham

Wednesday, June 5 (continued)

QUALITY OF LIFE

Moderator: Barbara Mazzella, MS, FAAIDD, Massachusetts Department of Developmental Services

Comparison of Turkish Disability Policy With United Nations Convention on Rights of Persons with Disabilities and Core Concepts of Disability Policy

H. Rutherford Turnbull, III, LLB, LLM, FAAIDD, University of Kansas

Bekir Fatih Meral, PhD, University of Kansas

The Significant Variables for Promoting Quality of Life Outcomes in a Service Provider Organization

Luigi Croce MD, Catholic University Brescia & ANFFAS
Marco Lombardi MS, Catholic University Brescia & La Nuvola
Roberto Cavagnola, PsyD, ANFFAS Breca

Room: Smithfield

POST SECONDARY EDUCATION

Moderator: David Rotholz, PhD, FAAIDD, University of South Carolina

Advancing Postsecondary Opportunities for Individuals With Intellectual and Developmental Disabilities

Tom Thompson, MA, Higher Education Consultant
Karen Pettus, PhD, University of South Carolina

Room: Fort Pitt

2:00 - 2:15 pm

Break

MARKETING PUBLIC RELATIONS VIDEO PRODUCTION CONTENT DEVELOPMENT SOCIAL MEDIA MANAGEMENT MONDO MEDIAWORKS WWW.MONDOMEDIAWORKS.COM

CLOSING PLENARY SESSION 2:15 - 3:45 pm Race to Catch the Future: Envisioning and Planning James R. Thompson, PhD, FAAIDD Margaret A. Nygren, EdD Room: Ballroom 1 & 2

SPECIAL SCREENING OF MEDIA AWARD WINNER Open to all conference attendees at no additional cost. Moderator: Elizabeth Perkins, PhD Vectors Of Autism Wednesday, June 5 | 4:00 - 5:00 pm Room: Ballroom 3

Stay on Top of Trends in Services and Funding



Stop by the AAIDD booth or visit aaidd.org to pick up your copy today!

The ninth edition (2013) of the well-known State of the States in Developmental Disabilities is a thorough and one-of-a-kind report on public spending, revenues, and programmatic trends in intellectual and developmental services within the United States.

Published in Partnership with Coleman Institute for Cognitive Disabilities

COMPLIMENTARY POST CONFERENCE SESSIONS

4:00 – 6:00 pm

Fee: \$0

Writing for Publication

APPROVED FOR 2 NASW SOCIAL WORK,
2 APA PSYCHOLOGY CE UNITS

Moderator:

Karen Douglas, PhD, Illinois State University

Presenters:

Lisa M. O'Hearn, MA, AAIDD

Glenn Fujiura, PhD, University of Illinois at Chicago

Leonard Abbeduto, PhD, FAAIDD, University of California-Davis

Michael L. Wehmeyer, PhD, FAAIDD, University of Kansas

Karrie Shogren, PhD, FAAIDD, University of Kansas

The session will address elements research reporting and examine and explain policies and issues involved in publication in scholarly journals in both print and electronic formats.

Room: Benedum

Transformational Lessons Learned from States Using the SIS® and State Experiences With Managed Care

APPROVED FOR 2 NASW SOCIAL WORK,
APA PSYCHOLOGY CE UNITS

Moderator:

Ravita Maharaj, PhD, AAIDD

Presenters:

Jon Fortune, EdD, FAAIDD, Human Services Research Institute

Lilia Teninty, MPA, Human Services Research Institute

John Agosta, PhD, Human Services Research Institute

Currently half of the states are using the SIS statewide or in various regions, pilot studies or special applications. In this session, states will share their experiences using the SIS to transform their statewide systems and experiences with managed care. Specific lessons and achievements from the experiences of a half a dozen states will be shared, along with states presenting their own analysis of what they have accomplished using the SIS. The SIS has advanced efforts in informing person centered planning, helping states deal with managed care initiatives, shaping resource allocation, and most importantly helping to transform their community systems by using the assessment of support needs to enhance quality, efficiency, and effectiveness.

Room: Duquesne

SOCIAL MEDIA

KEEPING UP WITH AAIDD

CHECK OUT AAIDD ON FACEBOOK!



Like us on Facebook to connect with AAIDD and network with other disability professionals.

CHECK OUT AAIDD ON YOUTUBE!



You will find a wide variety of videos on topics ranging from the justice system and intellectual

disability to special education best practices to classification and intellectual disability.

CHECK OUT AAIDD ON TWITTER!



Twitter is a great way to stay connected to AAIDD. We regularly post information about upcoming events and publications in addition to keeping you updated on the

latest in national disability news.

CHECK OUT AAIDD ON LINKEDIN!



LinkedIn has the world's largest professional network on the internet with 161 million members. Joining our LinkedIn group is a great way to connect

with professionals in the field you may not come into contact with otherwise.

CHECK OUT AAIDD ON PINTEREST!



One of the newer social media platforms, Pinterest provides a space for users to organize and share images. We are continually building up content on our

pinboards so you can share our images with others and spread the word about AAIDD news, events, and resources.

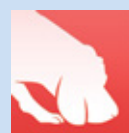

ANNUAL MEETING APP

aidd.bloodhound.com



We believe our students can live independent, self-sufficient, whole lives.

Having learned the skills to open doors previously closed to them, the futures of our students are limitless.

Minnesota Life College (MLC) is a work readiness and life skills training program for young adults with learning differences and autism spectrum disorders. Since 1996, MLC has remained dedicated to helping students make successful transitions towards independent living and financial self-sufficiency. Emphasizing *Real Skills for Real Life*®, our students learn in real world environments where real life skills are taught.

We are not simply a three-year experience; we are a lifelong partner to an individual who learns differently.



Socrates:
"NOT LIFE, BUT
GOOD LIFE
IS TO BE CHIEFLY
VALUED."



7501 Logan Avenue South Suite 2A
Richfield, Minnesota 55423
Phone 612-869-4008 • Fax: 612-869-0443

www.MinnesotaLifeCollege.org



Minnesota Life College is registered as a non-profit organization under Section 501(c)(3) of the Internal Revenue Code.

Thursday, June 6

**AAIDD is delighted to welcome
the SLN's 2013 Conference**



ALL DAY SESSION

Time: 9:00 am - 5:00 pm

Fee: \$75

**The National Sibling Leadership
Network Conference:
Catching the Future**

**APPROVED FOR 7 NASW SOCIAL WORK,
7 APA PSYCHOLOGY CE UNITS**

The National Sibling Leadership Network (SLN) conference will provide adult siblings of people with disabilities, individuals with disabilities, families, and professionals in the disability field information about best practices and cutting edge research in the disability field. In addition, participants will learn about resources and share experiences with a network of siblings. Siblings often share the longest lasting relationships. As their parents age, siblings frequently fulfill the primary caregiving roles in supporting their brothers and sisters with disabilities. Yet these siblings often lack adequate information and support which their parents have gained through a lifetime of advocacy and system navigation.

The SLN is a national nonprofit with state chapters dedicated to providing siblings of people with disabilities information and support throughout the lifespan to advocate with their brothers and sisters to promote issues important to them and their entire families. Come help grow the sibling movement and participate in this conference!

Room: Duquesne

Registration

8:00 am-12:30 noon

POST CONFERENCE MEETINGS

All Post Conference Meetings

Require an Additional Fee

Breakfast and Lunch are Included

MORNING SESSIONS

9:00 am - 12:00 pm

Fee: \$30

The Religion and Spirituality Division Forum

**How do we Assess Spirituality and Provide
Appropriate Supports for Individuals With
Intellectual and Developmental Disabilities?**

**APPROVED FOR 3 NASW SOCIAL WORK,
3 APA PSYCHOLOGY CE UNITS**

Part of the challenge can be language differences between service providers and ministers (ordained and lay). This will be a working session discussing this question, which will also include education about language comfortable and useful for service providers.

Room: Boardroom

9:00 am - 12:00 noon

Fee: \$45

**Ethical Issues in Intellectual and Developmental
Disabilities Services**

**APPROVED FOR 3 NASW SOCIAL WORK,
3 APA PSYCHOLOGY CE UNITS**

Presenter:

Ellis (Pat) Craig, PhD, FAAIDD

This workshop will address key ethical issues in services for people with intellectual and developmental disabilities. An overview will be provided of several codes of ethics, including NASW, APA, AAIDD guidelines to Professional Conduct, the Board for Certification of Behavior Analysts, and the National Alliance for Direct Support Professionals. Key areas in which ethical issues arise will be highlighted, such as consent, service eligibility, and loving relationships. The perspective of advocacy organizations, as well as self-advocates, will be presented. Finally, there will be open discussion of the key ethical issues being faced currently by professionals in the field, as identified by the participants.

Room: Heinz

9:00 am - 12:00 pm

Fee: \$45

Strategies for Including Adults With Developmental Disabilities in Research

APPROVED FOR 3 NASW SOCIAL WORK,
3 APA PSYCHOLOGY CE UNITS

Presenters:

Katherine McDonald, PhD, FAAIDD, Syracuse University

Dora Raymaker, MS, Portland State University

Do you want to learn more about how to effectively, safely, and respectfully include adults with developmental disabilities in your research? Join us for this hands-on, half-day session to learn more about key issues and effective strategies to promote the direct inclusion of adults with developmental disabilities in research. We will address topics covering all aspects of research participation (from research questions to consent to dissemination), including community-based participatory research.

Room: Forbes

GET STARTED WITH E-LEARNING

from AAIDD!

- More than 300 CE-approved courses
- Organizational and individual access to courses
- Convenient 24/7 access
- Discounted pricing for AAIDD members
- Free course for all AAIDD Annual Meeting attendees through 8/13/13 with promo code "AAIDDEL2013": *Supervision and the Principles of Positive Behavior Support*



GET CONNECTED TODAY!
aaidd.cequick.com

SAVE THE DATE



138th AAIDD Annual Meeting

June 23–26, 2014 | Orlando, Florida



Registration Schedule

The Registration area will open as follows:

Monday, June 3	8:00 am – 5:30 pm
Tuesday, June 4	7:00 am – 5:00 pm
Wednesday, June 5	7:00 am – 3:00 pm
Thursday, June 6	8:00 am – 12:30 pm

Admittance to the Annual Meeting

Registrants are required to wear their badges for all meeting, exhibits, and other events. Admittance to all sessions will be with a badge only. Door monitors will be instructed not to admit non-registrant attendees. Pre- and post-conference meetings also require tickets.

Silent Auction

A silent auction will be held in the Exhibit area during the regular exhibit hours. Bid on items of your choice! Bidding closes at 12:00 noon on Wednesday, June 5. All items must be picked up by 1:30 pm on June 5.

Exhibit Hours

The exhibits are an integral part of the educational program; we invite you to visit them. A listing of exhibitors and the products they are displaying are listed on pages 35–38 of this program. Acceptance of exhibits by AAIDD does not imply an endorsement.

Bookstore Hours

The AAIDD Bookstore will be open during regular exhibit hours. Publications will be for sale. Stop by to examine our new books and journals. The Bookstore is located in the Ballroom Foyer.

Message Center

The message board is by the registration desk.



AAIDD Corporate Members

THANK YOU FOR YOUR SUPPORT!

- Ability Beyond Disability**
- Alexander Milne Home for Women**
- California HHS-Department of Developmental Services**
- Christian Horizons**
- Community Access Unlimited**
- CRDI Gabrielle-Major**
- Evergreen Life Services**
- Human Services Research Institute**
- Indiana Professional Management Group, Inc.**
- Institute for Community Inclusion, U Mass Boston**
- MORC, Inc.**
- Protestant Guild Learning Center**
- Road To Responsibility, Inc.**
- Services for the Underserved, Inc.**
- Smoky Mountain Center**
- South Carolina Department of Disability and Special Needs**
- South Carolina MENTOR, Inc.**
- Spectrum Community Services**
- St. John’s Community Services**
- Whole Life, Inc.**
- Wildwood Programs Inc.**

Please stop by the

AAIDD Bookstore

located in the Ballroom Foyer to examine our new AAIDD books and journals!



Tuesday, June 4 | 5:00 – 7:00 pm

TECHNOLOGY

Board 1

Technology for People With Intellectual Disability: A Model for Organizational Support

Martin Caouette, PhD, Université du Québec à Trois-Rivières

Dany Lussier-Desrochers, PhD, Université du Québec à Trois-Rivières

Board 2

Group-Delivered Video Modeling to Teach Pretend Play Skills to Young Children With Autism

Kimberly Kroeger-Geoppinger, PsyD, Cincinnati Children's Hospital Medical Center

Stephanie Weber, PsyD, Cincinnati Children's Hospital Medical Center

Emily Johnson, MA, Cincinnati Children's Hospital Medical Center

Board 3

Use of Online, Face-to-Face Videoconferencing Technology to Provide Psychotherapy to Couples With Children With ASD

Julie Ramisch, PhD, Northern Illinois University

Vednidhi Teeruthroy, Northern Illinois University

SOCIAL INCLUSION

Board 4

Social Inclusion Through Acts of Good Citizenship

Roy Scheller, PhD, Hope Community Resources, Inc.

Board 5

Housing-The Need to Separate Housing From Services to Increase Quality of Life

Karen Driver, MSW, Driver Contracting and Installations, Inc.

Board 6

Individual-, Classroom-, and School-level Factors that Predict Social Network Membership for Children and Adolescents With Intellectual Disability or Autism and Their Peers

Kim Fisher, MEd, University of Illinois at Urbana-Champaign

Board 7

The Case for Community Membership: A Social-eEcological Approach to Social Interaction

Kim Fisher, MEd, University of Illinois at Urbana-Champaign

Board 8

Relationships Between Community Housing and Quality of Life Outcomes for Individuals With Intellectual and Developmental Disabilities: A Document Analysis

Grace Francis, MA, University of Kansas

Board 9

The Integration of Spiritual Supports into Individual Service Planning

David Morstad, MEd, Bethesda Institute

Betty McManus, MA, Bethesda Institute

Board 10

Creating Connections: Using Visual Mediating Strategies to Promote Communication

Yvette Evans, Illinois State University

Board 11

Co-Teaching and Inclusionary Models Leading to Successful Least Restrictive Environment

Tracey Lindroth, MEd, Oklahoma State Department of Education

QUALITY OF LIFE

Board 12

Person Centered Planning

Tracey Lindroth, MEd, Oklahoma State Department of Education

Board 13

Quality of Life in Persons With Profound and Multiple Disabilities in Spain

Miguel Verdugo, PhD, FAAIDD, Universidad de Salamanca

Laura Gómez, PhD, Universidad de Oviedo

Benito Arias, PhD, Universidad de Valladolid

Monica Santamaria, PhD, Universidad de Valladolid

Board 14

Quality of Life Among Adolescents With Significant Disabilities and Their Families: Predictive Factors

Thomas Boehm, MA, MDiv, Vanderbilt University

Erik Carter, PhD, Vanderbilt University

Board 15

Caregiver Burden and Health-Related Quality of Life in Adult Siblings of Adults With Autism and Down Syndrome

Teri Belkin, Indiana University-Purdue University Indianapolis

John McGrew, PhD, Indiana University-Purdue University Indianapolis

Board 16

Assessing Quality of Life in People With Intellectual Disability: Personal, Family, and Professional Perspectives

Maria Carbo-Carrete, Lull University

Joan Guardia-Olmos, Universitat de Barcelona

Board 17

Persons With Profound and Multiple Disabilities: Development and Validation of a Quality of Life Scale

Laura Gómez, PhD, Universidad de Oviedo

Benito Arias, PhD, Universidad de Valladolid

Miguel Verdugo, PhD, FAAIDD, Universidad de Salamanca

Monica Santamaria, PhD, Universidad de Salamanca

Board 18

Development of a Quality of Life Scale for Children With Profound and Multiple Disabilities

Laura Gómez, PhD, Universidad de Oviedo

María de los Ángeles Alcedo, PhD, Universidad de Oviedo

Benito Arias, PhD, Universidad de Valladolid

Miguel Verdugo, PhD, FAAIDD, Universidad de Salamanca

Board 19

Quality of Life Indicators for Children With Profound and Multiple Disabilities

Laura Gómez, PhD, Universidad de Oviedo
 Víctor Arias, PhD, Universidad de Valladolid
 Benito Arias, PhD, Universidad de Valladolid
 Miguel Verdugo, PhD, FAAIDD, Universidad de Salamanca

Board 20

Life-Centered Career Education (LCCE): A DD & ASD Life Skills Revised Curriculum

Robert Loyd, PhD, Armstrong Atlantic State University

Board 21

Midlife Crisis: Supports and Services to Enhance the Quality of Life

Jane Lurquin, Illinois State Board of Education

SUPPORTS INTENSITY SCALE

Board 22

The Reliability of the SIS-Children

Stephanie DeSpain, MA, Illinois State University
 Yuwadee Viriyangkura, MA, Illinois State University
 Veronica Guillen, MA, University of Salamanca
 James R. Thompson, PhD, FAAIDD, Illinois State University

Board 23

Comparison of the Inventory for Client and Agency Planning and the Supports Intensity Scale

William MacLean, PhD, University of Wyoming
 David Heath, MPA, University of Wyoming
 Christian Carter, University of Wyoming

Board 24

Personal Outcomes and Support Needs: A Correlational Study

Sofia Santos, PhD, Faculdade de Motricidade Humana
 Cristina Simões, MA, Faculdade de Motricidade Humana
 Pedro Morato, PhD, Faculdade de Motricidade Humana

POLICY

Board 25

Who is an Expert? Revisiting ID and Criminal Competency in the Courts Today

Mark Siegert, PhD, Mark Siegert and Associates, LLC

Board 26

Global Developmental Delay and Considerations Regarding its Announcement

Julie Maltais, Université du Québec
 Melina Rivard, PhD, Université du Québec
 Diane Morin, PhD, Université du Québec

Board 27

Perception of Service Users and Staff Members about Restraint and Seclusion

Julie Merineau-Cote, MPS, Université du Québec
 Diane Morin, PhD, FAAIDD, Université du Québec

PARTICIPATORY RESEARCH

Board 28

Partnering With People With Developmental Disabilities to Address Health and Violence: A Community-Based Participatory Research Project

Dora Raymaker, MS, Academic Autistic Spectrum Partnership in Research and Education
 Katherine McDonald, PhD, Syracuse University

Board 29

Incorporating Youth's Own Perspectives in the Measurement of Participation and the Environment

Kendra Liljenquist, Boston University
 Wendy Coster, PhD, Boston University

Board 30

Community-Based Participation of High School Students With Severe Disabilities

Matthew Brock, MA, Vanderbilt University
 Erik Carter, PhD, Vanderbilt University

PERSONNEL PREPARATION

Board 31

A State-Wide Needs Assessment of Training Needs Related to Serving Students With Autism

Matthew Brock, MA, Vanderbilt University
 Heartley Huber, MA, Vanderbilt University
 Erik Carter, PhD, Vanderbilt University

Board 32

Professional Development and Training: Policies, Practices and Alignment Across Organizational and State Systems

Caitlin Bailey, MS, University of Delaware
 Steven Eidelman, MSW, MBA, FAAIDD, University of Delaware
 Amanda Rich, PhD, York College of Pennsylvania

Board 33

Self-Determination in Professional Practices of Direct Support Professionals

Martin Caouette, Université du Québec à Trois-Rivières
 Yves Lachapelle, PhD, Université du Québec à Trois-Rivières
 Catherine Sparnaay, Université du Québec à Trois-Rivières

Board 34

Early Career Professionals and Students in NJ: Developing Innovative Methods to Increase the Skills of Direct Support Professionals

Colleen McLaughlin, MEd, Robert Wood Johnson Medical School

Board 35

Improving Community Living Outcomes through Comprehensive, Outcomes-Focused, Direct Support Training

Derek Nord, PhD, University of Minnesota
 Amy Hewitt, PhD, FAAIDD, University of Minnesota
 Renee Hepperlen, MSW, University of Minnesota
 Matt Bogenschutz, PhD, Adelphi University

Board 36

Analysis of 4 Situations Favoring Professional Skill

Julie Vincent, MA, Université de Sherbrooke

Board 37

Preparing Paraprofessionals to Work With Students' Disabilities: A Literature Review

Virginia Walker, MS, University of Virginia

Carol Smith, MEd, University of Virginia

Board 38

Bridge to Career in Human Services

Dalun Zhang, PhD, Texas A&M University

Cheryl Grenwelge, PhD, Texas A&M University

Board 39

Core Competencies for the Direct Service Workforce: A Synthesized and Expert-Validated Set Representing Long-Term Service and Support Sectors

Lori Sedlezky, MSW, University of Minnesota

Amy Hewitt, PhD, FAAIDD, University of Minnesota

Annie Johnson Sirek, MSW, University of Minnesota

EARLY INTERVENTION

Board 40

Early Childhood Adaptive Functioning for Children With Developmental Disabilities

Laura Murphy, EdD, FAAIDD, University of Tennessee

Sacha Bliss, PhD, University of Tennessee

Cindy Klubnik, PhD, University of Tennessee

Lauren Gardner, PhD, University of Tennessee

Board 41

Effect of Intensive Therapy on Gross Motor Function in Children With Developmental Delay

Bo Young Hong, MD, The Catholic University of Korea

Seong Hoon Lim, MD, The Catholic University of Korea

Jea Sung Yun, PhD, The Catholic University of Korea

Joon Sung Kim, PhD, The Catholic University of Korea

Ha Min Kim, PhD, The Catholic University of Korea

Joo Hye Park, PhD, The Catholic University of Korea

Board 42

Survey of State-level Promising Practices for Implementation of CDC's Act Early Campaign

Stephanie Weber, PsyD, Cincinnati Children's Hospital Medical Center

Karen Edwards, MD, Cincinnati Children's Hospital Medical Center

Jenny Lin, MS, Cincinnati Children's Hospital Medical Center

Kamesha Anderson, Cincinnati Children's Hospital Medical Center

AUTISM

Board 43

Social Skill, Behavioral, and Social-emotional Change in an Outpatient Children's Friendship Training Group for Children With Autism Spectrum Disorders

Leslie Markowitz, PsyD, The Ohio State University

Margaret Mehling, The Ohio State University

Andrea Witwer, PhD, The Ohio State University

Board 44

Factors Associated With Social Relationships and Community Inclusion in Adults With Autism

Margaret Mehling, The Ohio State University

Marc J. Tassé, PhD, FAAIDD, The Ohio State University

Board 45

Outcomes for Adults With Diagnosis of Autism Spectrum Disorder—An Update

Chas Moseley, EdD, National Association of State Directors of Developmental Disabilities Services

Julie Bershinsky, PhD, Human Services Research Institute

Board 46

ADOS and ADOS-G: A Literature Review, 1989–2010

Deirdre Muldoon, MS, University of New Mexico

Board 47

Gender, ASD Symptoms, and Social Relationships With Adults With High Functioning Autism Spectrum Disorders

Whitney Brooks, MA, The Ohio State University

Haleigh Scott, MA, The Ohio State University

Mary Moran, The Ohio State University

Betsey Benson, PhD, FAAIDD, The Ohio State University

Board 48

Disruptive Behavior Disorders Comorbid With Autism Spectrum Disorders

Aaron Kaat, MA, The Ohio State University

Luc Lecavalier, PhD, The Ohio State University

Board 49

Differentiating People With and Without Autism When They Have Intellectual and Sensory Disabilities

Gitta de Vaan, MSc, Radboud Universiteit Nijmegen

Mathijs Vervloed, PhD, Radboud Universiteit Nijmegen

Harry Knoors, PhD, Kentalis

Ludo Verhoeven, PhD, Radboud Universiteit Nijmegen

Board 50

Social-cognitive Functional Skills in Children and Youth With Autism Spectrum Disorders (ASD): Relation to Age, IQ, and Social Communication Impairment

Wendy Coster, PhD, Boston University

Megan Dooley, Boston University

Board 51

Functional Activity Performance, not IQ, Predicts Responsibility for Major Life Tasks for Children With ASD

Jessica Kramer, PhD, Boston University

Wendy Coster, PhD, Boston University

Board 52

Evaluating Outcomes for Children With Autism Spectrum Disorders Following One Year of Early Intensive Behavioral Intervention Services in a Bilingual Setting

Hayley Vininsky, MS, Gold Learning Centre

Nathalie Garcin, PhD, Gold Learning Centre

Ali Dussault, MEd, Gold Learning Centre

Alexandra Rothstein, MA, Gold Learning Centre

COMMUNICATIONS

Board 53

Team Perspectives of Supporting Students who use Augmentative and Alternative Communication

Yun-Ching Chung, PhD, Illinois State University
Julia Stoner, EdD, Illinois State University

Board 54

Effects of the Picture Exchange Communication System (PECS) on the Acquisition and Generalization of MANDS for Adults With Developmental Disability and Severe Communication Deficits

Mary von Witzleben, Northern Virginia Training Center
Pamela Sullivan, PhD, James Madison University
Matthew Osborne, MA, Northern Virginia Training Center
Katie Egan, MA, Northern Virginia Training Center

Board 55

Communication Access for People With Intellectual Disability in PA—Research, Policy and Practice

Celia Feinstein, MA, FAAIDD, Temple University
Amy Goldman, MS, Temple University
Jeanne Parisi, MPA, Pennsylvania Department of Public Welfare
Carrie Leonhart, MS, Temple University

Board 56

Effective Communication

Mirko Gerolin, Gorabide
Ismael Garzon, Gorabide
Valeria García-Landarte, Basque Federation of Associations for the benefit of the People with Intellectual Disabilities

TRANSITION

Board 57

No Confusion, No Frustration: Making Transition Smoother for Students With Autism

Supattra Andrade, MA, University of Northern Colorado

Board 58

Educational Considerations When Preparing for Transition

Adam Fuhrman, MA, Macomb-Oakland Regional Center

Board 59

Residential Transition Preparedness

Jennifer Bohne, MS, Macomb Oakland Regional Center

Board 60

Employment/Vocational Transition

Ryan Leininger, MS, Macomb-Oakland Regional Center

Board 61

Adherence to Program Standards and Student Outcomes at Transition and Postsecondary Programs for Students With Intellectual Disability

Debra Hart, MS, University of Massachusetts Boston
Frank Smith, MA, University of Massachusetts Boston

Board 62

Documenting LifePrep Students' Progress Toward Program Goals in a Post-Secondary Transitions Program: A Qualitative Case Study

Abigail Kroenig, MD, University of Rochester
Aubrey Klingensmith, University of Rochester
Judy Sallmen, University of Rochester
Karen Nolan, MS, University of Rochester

Board 63

Who's Future is it Anyway?: Enhancing Self-Determination and Student Involvement in the Transition Process

Meghan Ray, Rhode Island College

Board 64

Emerging Adulthood: A New Perspective on Planning for Transitions

Deborah Fisher, PsyD, Jewish Foundation for Group Homes
Gila Shusterman, PhD, Jewish Foundation for Group Homes

EMPLOYMENT

Board 65

The Effective Collaboration between Public Education and Local Business Supports Successful Employment

Marilee Boylan, MS, Poudre School District
Stacey Nichols, Colorado State University
Supattra Andrade, MA, University of Northern Colorado

Board 66

Venturing Forward: Social Entrepreneurs With Intellectual Disability

Kate Caldwell, MA, University of Illinois at Chicago

Board 67

Teaching Café Waiter Skills to Adults With Intellectual Disability Using Video Modeling

Atilla Cavkaytar, PhD, Anadolu Üniversitesi
Ayşe Tunc, MA, Anadolu Üniversitesi
Gulay Cesur, PhD, Anadolu Üniversitesi
Gizem Yildiz, PhD, Anadolu Üniversitesi

Board 68

The Project Eskisehir Rainbow: A Sample of Municipality Supported Vocational Education for Adults With Intellectual Disability

Atilla Cavkaytar, PhD, Anadolu Üniversitesi
Ahmet Acungil, PhD, Anadolu Üniversitesi
Gözde Tomris, MA, Anadolu Üniversitesi
Mustafa Uluyol, MA, Anadolu Üniversitesi

Board 69

An Ecological Systems Approach to Understanding Barriers to Competitive Employment

Grace Francis, MA, University of Kansas
Judith Gross, PhD, University of Kansas

Board 70

Barriers to Competitive Employment, as Reported by Families, Professionals and Individuals With Disabilities

Grace Francis, MA, University of Kansas
Judith Gross, PhD, University of Kansas
Mariela Pijem, MA, University of Kansas

Board 71

Family Employment Awareness Training (FEAT): Long-term Follow-up Study of Participants' Knowledge, Expectations, and Employment

Judith Gross, PhD, University of Kansas
Grace Francis, MA, University of Kansas
Mariela Pijem, MA, University of Kansas

Board 72

Racing to Catch Employment! Career & Community Studies (CCS) at Kent State University

Thomas Hoza, PhD, Kent State University
Suzanne Savickas, MEd, MFA, Kent State University

Board 73

The Relationship Between Employment Status of People With Intellectual and Developmental Disabilities and Perception on Quality of Life: Findings From a Panel Survey in South Korea

Hwan-hee Kim, MA, Inha University, South Korea
Jeong Yun Jang, Inha University, South Korea
Ik-dong Lee, Inha University, South Korea
Youngsun Lee, PhD, University of South Korea

Board 74

Designing of U-learning-Based, and Student Directed Vocational Training Program on Job Performances of Students With Intellectual Disability

Ik-Dong Lee, Inha University, South Korea
Hwan-hee Kim, MA, Inha University, South Korea
Jeong Yun Jang, Inha University, South Korea
Youngsun Lee, PhD, University of South Korea

BEHAVIORAL INTERVENTIONS

Board 75

Battery of Tasks for Training the Comparison and the Categorization Processes in Individuals With Intellectual Disability

Caroline Denaes, PhD, University of Colorado

Board 76

Eating, Drinking, and Swallowing Checklist: Predictive and Practical Validity

Melissa DiSipio, MSA, FAAIDD, Philadelphia Coordinated Health Care
Frank Bernt, PhD, Saint Joseph's University

Board 77

Enhancing Function Through Multisensory Activities and Environments

Cynthia Potter, DPT, Healthquest Community Services, Inc
Carol Erzen, MEd, Allegheny Valley School

HEALTH

Board 78

Evidence for Exercise for Individuals With I/DD

Cynthia Potter, DPT, Healthquest Community Services, Inc.
Christopher Hughes, North Hills Orthopedic and Sports Physical Therapy

Board 79

Questionnaire of Habits and Support Needs for Physical Activity Among People With Intellectual Disability

Maria Carbo-Carrete, Lull University
Joan Guardia-Olmos, Universitat de Barcelona

Board 80

Factors Influencing Breast Cancer Screening in Women With Intellectual Disability

Genevieve Breau, MA, University of British Columbia
Sally Thorne, PhD, RN, University of British Columbia
Jennifer Baumbusch, PhD, RN, University of British Columbia

Board 81

Older Women With Intellectual Disability's Experiences of Accessing Gynecological Care

Genevieve Breau, MA, University of British Columbia
Jennifer Baumbusch, PhD, RN, University of British Columbia

Board 82

Prenatal Testing Implications for Disabilities in the Future

Kurt Kondrich, MA, Early Intervention Specialists, Inc.

Board 83

Mortality and Morbidity Characteristics from US Death Certificates

Scott Landes, MDiv, University of Florida

Board 84

A Study on the Psychometric Properties of the Screening Tool of Feeding Problems (STEP)

Bekir Fatil Meral, PhD, University of Kansas
Ahmet Fidan, MS, University of Kansas

Board 85

The Cardinal Innovations Healthcare Model, A Sustainable Service System: Using the Tools of Managed Care to Advance Value Driven Policy and Practice in Intellectual and Developmental Disabilities Service Systems

Andrea Misenheimer, PBH Solutions

Board 86

Access to Health Care and Parenting Stress in Adolescents With Developmental Disabilities

Rose Nevill, MA, The Ohio State University
Susan Haverkamp, PhD, FAAIDD, The Ohio State University

Board 87

Patterns in Health Care Utilization Among Adults With Intellectual Disabilities

Haleigh Scott, MA, The Ohio State University
Susan Haverkamp, PhD, FAAIDD, The Ohio State University

Board 88

Reducing the Prescription of Psychotropics to People With ID

Jos van Loon, PhD, Ghent University
Peter de Doelder, MD, PhD, General Practitioner
Bert Henderikse, PhD, Centre for Consultation and Expertise
Maartje Leon, PhD, Stichting Arduin

LEADERSHIP

Board 89

SECP SIG Guide Program

Sarah Hall, PhD, Ashland University

Board 90

Collaboration in Advocacy: Learning Through Service and Experience

Jennifer Jones, PhD, Oklahoma State University
Amanda Cothorn, MS, TARC

Board 91

Activities of the AAIDD Student and Early Career Professional Special Interest Group

Judith Gross, PhD, University of Kansas

Board 92

AAIDD & AAIDD: Partnering Together for Systems Change

Kelly Bohlander, MSW, MPA, North Carolina Council on Developmental Disabilities

SELF DETERMINATION

Board 93

Impact of Individual and Class-wide Application of Self-Determined Learning Model of Instruction (SDLMI) on Academic and Transition Goals of Adolescents With Disabilities and Teacher Efficacy and Perception Toward Inclusive Education

Suk-Hyang Lee, PhD, University of Kansas

Board 94

Maximizing Independence and Self-Determination in Students With Intellectual Disability

Yvonne Michali, MS, Kent State University
Cynthia Kenyon, MEd, Kent State University
Lauren Avellone, MA, Kent State University

Board 95

Self-Advocacy Online

Jerry Smith, University of Minnesota
Lori Sedlezky, MSW, University of Minnesota
Mark Olson, University of Minnesota

Board 96

Standing Together and Finding a Voice Apart: The Process of Intellectual Disability Rights Advocacy

Amanda Rich, PhD, York College of Pennsylvania
Steven Eidelman, MSW, MBA, FAAIDD, University of Delaware
Caitlin Bailey, MS, University of Delaware

POSTSECONDARY EDUCATION

Board 97

A Holistic Approach to Post-Secondary Education for Students With Intellectual Disability

Titania Boddie, Temple University
Kathy Miller, Temple University

Board 98

Center on Secondary Education for Students With Autism Spectrum Disorders: Lessons Learned During Intervention Development

Erik Carter, PhD, Vanderbilt University
Ann Cox, PhD, University of North Carolina at Chapel Hill

Board 99

Outcomes of a Post-Secondary Program Serving Students With ID

Debra Leach, PhD, Winthrop University
Caroline Everington, PhD, Winthrop University

Board 100

Challenging Constructions of Choice and Autonomy in ID Support Settings

Jami Petner-Arrey, PhD, Queens University

INTERNATIONAL

Board 101

A Survey of Supports to Access for Students With IDD who are English Language Learners

Joshua Baker, PhD, University of Nevada, Las Vegas
Christopher Rivera, PhD, University of Texas at San Antonio

Board 102

AAIDD Delegation to Brazil: October 20-28, 2012

Vincent Chesney, MS, FAAIDD, Commonwealth of Pennsylvania

Board 103

The Assessment of Activity and Participation for Adults With Intellectual Disability and Other Disabilities

Tzu-Ying Chiu, MA, Institute of Medical Sciences, Tzu-Chi University
Chia-Feng Yen, PhD, Hua Foundation for Persons with Intellectual Disabilities

Board 104

The Mexican School of Down Art

Sylvia Escamilla, MA, School of Mexican Down Art

Board 105

Development and Evaluation of a Syllable-based Reading Intervention for Students With Intellectual Disability

Nils Euker, PhD, Justus Liebig University Giessen
Jan Kuhl, PhD, Justus Liebig University Giessen
Marco Ennemoser, PhD, Justus Liebig University Giessen

Board 106

Inclusive Education at APAE de Sao Paolo, Brazil—Report of the Transition From a Special School

Laura Guilhoto, MD, University of São Paulo

Roseli Olher, APAE de São Paulo

Esper Cavalheiro, MD, Center for Strategic Studies and Management in Science, Technology, and Innovation

Board 107

Escala Pessoal de Resultados: the Portuguese POS

Cristina Simões, MA, Faculdade de Motricidade Humana

Sofia Santos, PhD, Faculdade de Motricidade Humana

Pedro Morato, PhD, Faculdade de Motricidade Humana

Board 108

Portuguese POS vs. WHOQOL-Br

Cristina Simões, MA, Faculdade de Motricidade Humana

Sofia Santos, PhD, Faculdade de Motricidade Humana

Pedro Morato, PhD, Faculdade de Motricidade Humana

Board 109

Global Teaching, Learning, and Doing

William Kiernan, PhD, FAAIDD, University of Massachusetts at Boston

QUALITY

Board 110

Application of Standard Scores in the Evaluation of Home and Community Based Quality Initiatives

Christopher Baglio, EdD, Liberty Healthcare Corporation

Barbara Stachowiak, MS, Liberty Healthcare Corporation

Karen Peret, EdD, Liberty Healthcare Corporation

Board 111

Measuring Quality: Balancing Individual and System Priorities

Tina Campanella, MS, DC Quality Trust

Jimi Lethbridge, DC Quality Trust

Board 112

Eliciting Perceptions of Satisfaction With Services and Supports from Persons With Intellectual and Developmental Disabilities

Susan Copeland, PhD, University of New Mexico

Ruth Luckasson, JD, FAAIDD, University of New Mexico

Rob Shauger, MS, University of New Mexico

Board 113

An Evaluation of the Disability (Re-)Determination Process Through Service Coordinators and Families

John Keesler, MSW, University at Buffalo

Board 114

Trauma-Informed Care and Intellectual Disability Services: Does it Matter?

John Keesler, MSW, University at Buffalo

Cory Isham, MSW, University at Buffalo

Board 115

Age of Persons Supported and Factors Predicting Intended Staff Turnover: A Comparative Study

Carol Britton Laws, PhD, University of Georgia

Board 116

Making the Day Matter: Online Site for Persons With Significant Developmental Disabilities

Carl Toole, MEd, Algonquin College

Board 117

Self-Report in Measuring Personal Outcomes With People With Severe Intellectual Disability

Jos van Loon, PhD, Ghent University

Claudia Claes, PhD, Ghent University

Sascha Pfeiffer, Ghent University

Board 118

Development of a New Instrument to Assess the Support Needs for Children With Intellectual Disability

Miguel Verdugo, PhD, FAAIDD, Universidad de Salamanca

Veronica Guillen, MSc, Universitat Jaume i de Castellón

Benito Arias, PhD, Universidad de Valladolid

Eva Vicente, MSc, Universidad de Valladolid

K-12 EDUCATIONAL ENVIRONMENT

Board 119

Role of Staff, Parent And Learner Rapport in the Provision of School Based ASD Services

Day Butcher, MS, University of Rochester

Board 120

Development of Functional Skills: Comparing Youth With ASDs, Developmental Disabilities, and No Disabilities at 5, 10, and 15 Years using the PEDI-CAT

Jessica Kramer, PhD, OTR/L, Boston University

Board 121

Squeaky Wheels, Mothers From Hell, and CEO's of the IEP: Parents' Role in Special Education

Priya Lalvani, PhD, Montclair State University

Board 122

Computer Game-based Learning in Vocational Training for Secondary Students With IDD: Impact on Educational Effectiveness and Student Motivation

Youngsun Lee, PhD, University of South Korea

Hwan-Hee Kim, MA, Inha University, South Korea

Jeong Yun Jang, Inha University, South Korea

Jungmin Kwon, PhD, Ewha Womans University

Board 123

Class Wide Peer Tutoring in Inclusive Classrooms: A Review of the Literature

Jennifer Peña, MA, University of New Mexico

Susan Copeland, PhD, University of New Mexico

Board 124

PA Special Education Directors Views of CBVI

Julie Pickens, MPA, University of Illinois

Stacy Dymond, PhD, University of Illinois

Board 125

The Cibola Greenhouse and Composting Company: A Community-Based Mathematics Program for People With Developmental Disabilities]

Anthony Rodriguez, PhD, Providence College

Board 126

Self-Efficacy of Teachers Supporting Students With Autism Spectrum Disorders in General Education Classrooms

Katie Smith, MSED, Illinois State University

Stacey Bock, PhD, Illinois State University

Board 127

Teaching Children in Poverty: The Ruby Payne Controversy

Jennifer Thomison, MSED, Cedar Ridge Elementary

Board 128

Participation of High School Students With Severe Disabilities in Service-Learning

Michelle Bonati, MA, University of Illinois at Urbana-Champaign

Board 129

Environmental Barriers and Supports for Children and Youth With Disabilities Based on Reported Functional Limitations

Kendra Liljenquist, Boston University

Wendy Coster, PhD, Boston University

Board 130

Increasing the Capacity of Public School Districts to Meaningfully Include Students With Significant Intellectual Disability—Three Strategies

A. Anthony Antosh, EdD, Rhode Island College

Kristin Kaulas, MEd, Rhode Island College

FAMILIES

Board 131

Differences in Stress Levels Among Parents of Children With and Without Developmental Disabilities

Laurence De Mondehare, PhD, Université du Québec à Montréal

Diane Morin, PhD, Université du Québec à Montréal

Board 132

Sibs Looking Forward: Supporting Students With IDD and Their Siblings Through a Transition Retreat

Thomas Fish, PhD, FAAIDD, The Ohio State University

Sarah Hall, PhD, Ashland University

Board 133

Parenting Stress in Parents of Children At-Risk for Developmental Disabilities

Rebekah Hudock, PhD, Cincinnati Children's Hospital Medical Center

Laura Murphy, EdD, FAAIDD, University of Tennessee

J. Carolyn Graff, PhD, FAAIDD, University of Tennessee

Fred Palmer, MD, University of Tennessee

Board 134

Sibling Roles in Connecting to Community Employment for People With Disabilities

John Kramer, PhD, University of Massachusetts at Boston

Board 135

Family Assessment Portfolios: Parent and Educator Perceptions

Samantha Talbot, Illinois State University

Ashley Dolce, Illinois State University

Marlee Goldsworthy, Illinois State University

Felicia McGuinn, Illinois State University

James R. Thompson, Illinois State University

Board 136

Parent Perspectives on the Support Needs of Children With Special Health Care Needs: Implications for Supports Needs Assessment and Planning

Keri Edwards, MA, Illinois State University

James R. Thompson, PhD, FAAIDD, Illinois State University

Board 137

Sibling Leadership Network

Katie Arnold, MS, Sibling Leadership Network

Tamar Heller, PhD, University of Illinois at Chicago

MENTAL HEALTH

Board 138

Investigating Predictors of Depression for Individuals With Autism Spectrum Disorders (ASD): The Role of Caregiver Distress and Negative Life Events

Stephanie Fung, MA, York University

Jonathan Weiss, PhD, York University

Board 139

Outcomes for Adults With Dual Diagnosis of ID/DD and Mental Illness Compared to Those Without

Sarah Taub, MA, Human Services Research Institute

Julie Bershady, PhD, Human Services Research Institute

Chas Moseley, EdD, National Association of State Directors of Developmental Disabilities Services

Mary Lee Fay, National Association of State Directors of Developmental Disabilities Services

Board 140

Dual Diagnosis: Bridging the Gap Between Mental Health and ID

Allisha Young, MS, Ohio State University

Board 141

Holistic Perspective on Cognitive Age Trends Among Adults With ID Compared to Adults With TD

Moran Zemachm, MA, Bar-Ilan University

Hefziba Lifshitz-Vahav, Bar-Ilan University

Eli Vakil, Bar-Ilan University

Board 142

Validity of SIS for People With Psychiatric Disabilities

Tryggvvi Sigurdsson, PhD, State Diagnostic and Counseling Centre for the Disabled

Guomundur Arnkelsson, PhD, University of Iceland

Sunday, June 2

5:00 pm – 8:00 pm

Board of Directors

Presiding: Marc J. Tasse, PhD,
President, AAIDD Board of Directors

Monday, June 3

9:00 – 10:00 am

Annual Open Membership Meeting and Leadership Forum

Presiding: Marc J. Tassé, PhD, FAAIDD,
President, AAIDD Board of Directors

Room: Ballroom 3

10:15 – 11:30 am

The Assembly of Geographic Interests

Presiding: James R. Thompson, PhD, FAAIDD,
President-Elect, AAIDD Board of Directors

Room: Brigade

10:15 – 11:30 am

The Conference of Professional Interests

Presiding: Amy Hewitt, PhD, FAAIDD, Vice-President,
AAIDD Board of Directors

Room: Rivers

Tuesday, June 4

7:00 am – 9:00 am

Health and Wellness Action Group

Presiding: Joseph O'Grady, Jr, MD, FAAIDD

Room: Traders

8:00 am – 9:00 am

Gerontology Division

Presiding: Nancy Jokinen, MSW, PhD

Room: Boardroom

8:00 am – 9:00 am

Legal Process Division

Presiding: Caroline Everington, PhD

Room: Stanwix

8:00 am – 9:00 am

Mental Health Services Special Interest Group

Presiding: Vincent M. Chesney, MS, FAAIDD

Room: Chartiers

8:00 am – 9:00 am

Region V Meeting

Presiding: Ellis (Pat) Craig, PhD, FAAIDD

Room: Heinz

8:00 am – 9:00 am

Region IX/NJ Chapter

Presiding: Sidney Blanchard, FAAIDD

Room: Allegheny

12:15 – 1:45 pm

LUNCH MEETINGS

Ticket required (lunch fee \$20)

Education Division Lunch Meeting

Presiding: Amy Rosenstein, PhD

Psychology Division Lunch Meeting

Presiding: Deborah Fisher PsyD, and Rozemarijnn Staal, PsyM

International Special Interest Group

Presiding: Maria de les Salines Carbó and Marco Lombardi, MS

Room: Ballroom 3

Wednesday, June 5

7:00 – 8:00 am

Humanist Action Group

Presiding: James R. Mullin, MEd

Room: Traders

7:00 am – 8:00 am

Research Division

Presiding: Yona Lunsky, PhD, FAAIDD

Room: Chartiers

11:45 – 1:00 pm

Social Work Division Working Lunch

No cost for Social Work Division Members;
tickets required.

Room: Traders

11:45 – 1:00 pm

Past Presidents' Lunch

By invitation only

Room: Rivers

Exhibitors

We invite you to visit our exhibitors and connect with those whose products or services interest you. The exhibits are located in Ballroom Foyer.

21 AND ABLE, UNITED WAY OF ALLEGHENY COUNTY

TABLE 17

1250 Penn Ave, Pittsburgh, PA 15230
 Contact: Mary Anderson Hartley
 Phone: 412-298-4403
 Email: mhartley@uwac.org
 Web: www.21andable.org

21 and Able is a United Way of Allegheny County initiative to create a roadmap for youth with disabilities who are transitioning out of high school to continue their education, to work, live independently, and participate in their communities to the greatest extent possible.

ACHIEVA

TABLE 21

711 Bingham Street, Pittsburgh, PA 15203
 Contact: Nancy Murray
 Phone: 412-995-5000
 Email: nmurray@achieva.info
 Web: www.achieva.info

ACHIEVA is the largest nonprofit organization in southwestern Pennsylvania providing lifelong supports for individuals with disabilities and their families. Founded in 1951, *ACHIEVA* supports over 14,544 children and adults with disabilities each year through advocacy, community services, education, trust services, and family supports.

AMERICAN PHYSICAL THERAPY ASSOCIATION SECTION ON PEDIATRICS

TABLE 16

10069 Grubbs Road, Wexford, PA 15090
 Contact: Cindy Potter
 Phone: 724-312-7813
 Email: cnpotter@aol.com
 Web: www.pediatricapta.org

The Section of Pediatrics of the American Physical Therapy Association (APTA) promotes the highest quality of life for all children, people with developmental disabilities, and their families. The Section represents pediatric physical therapy and promotes its members as practitioners of choice for children (birth to 21 years) with or at risk for movement dysfunction. Children served range in age from pre-term infants to teenagers and those with developmental disabilities who are entering adulthood.

ASSOCIATION FOR PERSONS IN SUPPORTED EMPLOYMENT (APSE)

TABLE 18

416 Hungerford Drive, Suite 418, Rockville, MD 20850
 Contact: Marlyn Barrow
 Phone: 301-279-0060
 Email: marlyn@apse.org
 Web: www.apse.org

Since 1988, *APSE* has promoted and advocated for integrated employment and career advancement opportunities for individuals with disabilities. With 37 chapters around the country, *APSE* is moving the "Employment First" agenda forward. We believe that employment in the general workforce should be the first and preferred outcome for all working age citizens with disabilities.

ASSOCIATION OF UNIVERSITY CENTERS ON DISABILITY (AUCD)

TABLE 19

1100 Wayne Avenue, Suite 100, Silver Spring, MD 20910
 Contact: Laura Martin
 Phone: 301-588-8252
 E-mail: lmartin@aucd.org
 Web: www.aucd.org

AUCD's mission is to advance policies and practices that improve the health, education, social, and economic well-being of people with developmental and other disabilities, their families, and their communities by supporting our members in research, education, health, and service activities that achieve our vision.

BETHESDA INSTITUTE

TABLE 11

600 Hoffman Drive, Watertown, WI 53094
 Contact: Diane Hackbarth
 Phone: 877-878-6650
 Email: diane.hackbarth@mailblc.org
 Web: www.bethesda institute.org

The mission of the *Bethesda Institute* is to raise the level of excellence in the range of services available to people with intellectual and developmental disabilities. A recognized leader in the production of quality, cost-effective DVDs, the Institute's ultimate goal is to assist people with intellectual and developmental disabilities as they pursue greater independence.

BROOKES PUBLISHING CO.

TABLE 12

PO Box 10624, Baltimore, MD 21285
 Contact: Melanie Allred
 Phone: 410-337-9580
 Email: mallred@brookespublishing.com
 Web: www.brookespublishing.com

For 35 years, *Brookes Publishing* has been a leading provider of resources on disabilities, autism, education, child development, early intervention, communication, language, behavior, and mental health. An independent company, *Brookes Publishing* is headquartered in Baltimore, Maryland.

Exhibitors (Continued)

COLEMAN INSTITUTE FOR COGNITIVE DISABILITIES

TABLE 10

3825 Iris Avenue, Suite 200, Boulder, CO 80303
Contact: Enid Ablowitz
Phone: 303-492-0639
Email: enid.ablowitz@cu.edu
Web: www.colemaninstitute.org

The *Coleman Institute for Cognitive Disabilities* was founded in 2001 at the University of Colorado. Its mission is to catalyze and integrate advances in science, engineering and technology to improve the quality of life and independence for people with cognitive disabilities.

COMMUNITY HEALTH CONNECTIONS

TABLE 18

120 Hollywood Drive, Suite 201, Butler, PA 16001
Contact: Mary Nau
Phone: 724-283-0990
Email: mnau@hcqu.org
Website: www.hcqu.org

Community Health Connections is a training and technical assistance support service to providers who serve adults with developmental disabilities. Visit our table to view and purchase an array of training DVD's and other products.

DIRECTCOURSE

TABLE 5

245 Peachtree Center Avenue NE, 1900 Marquis One Tower, Atlanta, GA 30303
Contact: Deanna Liebert
Phone: 404-460-1831
Email: d.liebert@elsevier.com
Web: www.directcourseonline.com

DirectCourse online curricula are designed to help those who support older adults and people with disabilities build more rewarding careers. The interactive curricula are proven to increase job satisfaction and lower turnover—all while celebrating the role these professionals play in society, empowering them to perform at the highest level.

DOWN SYNDROME ASSOCIATION OF PITTSBURGH (DSAP)

TABLE 15

5513 William Flynn Highway #400, Gibsonia, PA 15044
Contact: Seth Droë
Phone: 412-512-0478
Email: smdroe@gmail.com
Web: www.dsapgh.org

DSAP is a group of parents and professionals dedicated to enriching the lives of people with Down syndrome. Our mission is to support families by providing "New Parent Packets" to families beginning their journey and financial support to the Down Syndrome Center at Children's Hospital of Pittsburgh UPMC and the adult center at UPMC Montefiore Hospital. These two clinical programs were established through the generosity of our members. We make contributions to community resources and national research endeavors that focus on improving the well-being of people with Down syndrome.

EMMAUS COMMUNITY OF PITTSBURGH

TABLE 31

2821 Sarah Street, Pittsburgh, PA 15203
Contact: Karen Jacobsen
Phone: 412-381-0277
Email: kdjacobsen@emmauspgh.org
Web: www.emmauspgh.org

For more than 20 years, *Emmaus* has been providing permanent homes, respite care, advocacy, and other supports for people with intellectual disability and autism. We are an ecumenical, non-profit organization built upon a vision of people with and without disabilities sharing their lives.

ESSENTIAL LEARNING, LLC, A RELIAS LEARNING COMPANY

TABLE 24

107 Edinborough Drive South, Suite 206, Cary, NC 27511
Contact: Carlos Russo
Phone: 914-655-1800
Email: crusso@reliaslearning.com
Web: www.essentiallearning.com

Essential Learning provides a comprehensive selection of web-based course through an integrated management system that saves time and money while increasing effectiveness of staff training. Libraries on Developmental Disabilities, Behavioral Health, Veterans and other human services offer high quality, interactive course designed for staff working in a variety of settings."

HEALTH RISK SCREENING, INC

TABLE 7

6437 Azalea Garden Road, Norfolk, VA 23518
Contact: Rob Refo
Phone: 770-490-7214
Email: rob@hrstonline.com
Web: www.hrstonline.com

The Health Risk Screening Tool (HRST) is a web-based instrument developed to detect health risks associated with intellectual and developmental disabilities, and provide prompts for special attention and prevention. The HRST helps meet CMS health and safety requirements, allows less restrictive settings for individuals, and assists with equitable resource allocation.

INSTITUTE ON DISABILITY & HUMAN DEVELOPMENT (IDHD), UNIVERSITY OF ILLINOIS-CHICAGO

TABLE 8

1640 W. Roosevelt Road, Chicago, IL 60608
Contact: Erika Magallanes
Phone: 312-413-1520
Email: remagall@uic.edu
Web: www.ahs.uic.edu/dhd/

The *IDHD* at the University of Illinois at Chicago is the University Center of Excellence in Developmental Disabilities for the state of Illinois. IDHD has internationally-renowned masters and doctoral programs in Disability Studies.

INSTITUTE ON DISABILITIES, TEMPLE UNIVERSITY

TABLE 13

1755 N. 13th Street, Student Center 411S, Philadelphia, PA 19122
 Contact: Celia Feinstein
 Phone: 215-204-1356
 Email: shoes100@temple.edu
 Web: www.disabilities.temple.edu

The *Institute on Disabilities* at Temple University, Pennsylvania's University Center for Excellence in Developmental Disabilities—one of 67 nationwide—has been serving people with disabilities, family members, educators, and more statewide since 1973. More than 20 programs address issues such as quality of life assessment, assistive technology, family and individual leadership training, full classroom inclusion, criminal justice, and emergency preparedness.

KEYSTONE HUMAN SERVICES

TABLE 14

124 Pine Street, Pittsburgh, PA 17101
 Contact: Ann Muffitt
 Phone: 717-232-7509
 Email: amoffitt@keystonehumanservices.org
 Web: www.keystonehumanservices.org

Keystone Human Services provides community-based services for children, young people, adults and families in Pennsylvania, Maryland, Delaware, and Connecticut, and parts of Russia and Moldova. We provide services in the areas of intellectual disability, autism, mental health, early intervention, and children and family services.

MEDISKED CONNECT

TABLE 9

860 University Avenue, Rochester, NY 14607
 Contact: Brian White
 Phone: 866-633-4753
 Email: brian_white@medisked.com
 Web: www.medisked.com

MediSked is the leader in agency management platforms with Connect. Connect is your entire agency online from service roles to billing to centralize and connect everyone you serve. Reduce cost, better support an audit, increase capacity, and improve quality at care.

MILESTONE CENTERS, INC

TABLE 6

600 Ross Avenue, Pittsburgh, PA 15221
 Contact: Eric Lindy
 Phone: 412-371-7391
 Email: elindy@milestonecentersinc.org
 Web: www.milestonecentersinc.org

Milestone's mission is to provide quality, life-enhancing services that promote wellness and the development of human potential.

NADD

TABLE 32

132 Fair Street, Kingston, NY 12401
 Contact: Robert Fletcher
 Phone: 845-331-4336
 Email: rfletcher@thenadd.org
 Web: www.thenadd.org

NADD is a nonprofit membership association established for professionals, care providers, and families to enhance the understanding of, and services for, individuals who have intellectual disability and mental health needs.

NHS HUMAN SERVICES

TABLE 23

906 Bethlehem Pike, Erdenheim, PA 19036
 Contact: Terrence McNelis
 Phone: 215-836-3108
 Email: tmcnelis@nhsonline.org
 Web: www.nhsonline.org

NHS Human Services is one of the nation's leading non-profit providers of community-based human services. NHS provides mental health, addictive diseases, autism, intellectual and developmental disabilities (I/DD), and other services. NHS provides residential homes, in-home support, and other vital services to nearly 2,000 individuals with I/DD and their families.

PASSAVANT MEMORIAL HOMES

TABLE 29

163 Thorn Hill Road, Warrendale, PA 15010
 Contact: Rich Howard
 Phone: 724-622-1266
 Email: rhoward@passavant.org
 Web: www.passavant.org

The mission of *Passavant Memorial Homes* family of services is to empower people with disabilities to live in the community. Promoting choice and independence, Passavant Memorial Homes, Accessible Dental Services, Life Enrichment Trust, InvivaSpan, PDC Pharmacy, and Passavant Memorial Homes Foundation offer options addressing the needs and desires of individuals they support.

PHILADELPHIA COORDINATED HEALTH CARE (PCHC)

TABLE 34

123 S. Broad Street, 22nd Floor, Philadelphia, PA 19109
 Contact: Dina McFalls
 Phone: 215-546-0300 ext 3674
 Email: dmcfalls@pmhcc.org
 Web: www.pchc.org

PCHC, the Southeastern Pennsylvania Health Care Quality Unit, is a unique and innovative program designed to provide health care support to individuals with intellectual and developmental disabilities living in the community in Philadelphia and the Southeastern Region of Pennsylvania. PCHC has, since its creation in 1989, been dedicated to increasing access to quality community health care services for people with intellectual and developmental disabilities.

PENNSYLVANIA LEND

TABLE 26

3550 Market St, 3rd Floor, Child Development, 3033B, Philadelphia, PA 19104
 Contact: Tatiana Mack
 Phone: 215-590-7466
 Email: mackts@email.chop.edu
 Web: www.chop.edu/professionals/educational-resources/leadership-education-in-neurodevelopmental-disabilities

LEND Programs provide graduate level interdisciplinary leadership training. LEND training's purpose is to improve the health of infants, children, and adolescents who have or are at risk for developmental disabilities and their families. Pennsylvania's LEND Programs are based at the *University of Pittsburgh and Children's Hospital of Philadelphia*.

Exhibitors (Continued)

PHARMACY ALTERNATIVES

TABLE 30

901 Forest Avenue, Oak Park, IL 60302
Contact: Nanette Wrobel
Phone: 847-712-6578
Email: nwrobel@palrx.com
Web: www.palrx.com

Pharmacy Alternatives is a comprehensive pharmacy dedicated to helping all people we serve nationally achieve their higher level of independence. We serve individuals living in ICF/MRs, group homes, skilled pediatric facilities, and foster care.

QBS, INC

TABLE 25

257 Turnpike Road, Suite 320, Southborough, MA 01772
Contact: Anne Gately
Phone: 508-281-0246
Email: agately@qbscompanies.com
Web: www.qbscompanies.com

QBS, Inc. provides quality behavior solutions to complex behavior problems using evidence-based procedures supported by scientific research in the field of applied behavior analysis. QBS offers behavioral training, consultation, and software for residential and day programs, psychiatric hospitals, schools, nursing facilities, families, and agencies that provide services to adults, children, or adolescents.

QUANTUM SOLUTIONS CORPORATION

TABLE 27

P. O. Box 500, Petersburg, IL 62675
Contact: Dora Ingle
Phone: 217-632-3066 ext. 140
Email: Dana@qscorpio.com
Web: www.qscorpio.com

Quantum Solutions creates information management tools for provider agencies of every size. Our vast modular offering ranges from service treatment plans, to fee for service billing to human resources and so much more. We deliver customizable solutions, not fixed software applications. Unencumbered enterprise license or cloud-based service-your choice.

STEP BY STEP, INC

TABLE 22

275 Curry Hollow Road, Building #3, Pittsburgh, PA 15236
Contact: Denise Cavanaugh
Phone: 412-655-8677 ext 208
Email: dcavanaugh@stepbystepusa.com
Web: www.stepbystepusa.com

Since 1977, *Step By Step, Inc.* has provided community support services to children and adults in Pennsylvania with mental illness, intellectual disability, and autism. We are a non-profit agency committed to enhancing the quality of life and personal growth of those we serve in 14 counties in the Commonwealth.

STRIDE, INC

TABLE 4

1021 Carlisle Boulevard, Albuquerque, NM 87106
Contact: Kerry Bertram
Phone: 505-232-3201
Email: Kerry@stridewrite.com
Web: www.stridewrite.com

Stride Inc. is a distributor of office products. Our office products are available through office products dealers throughout the US. Our mission is the employment of adults with intellectual and developmental disabilities.

THERAP SERVICES

TABLE 3

562 Watertown Avenue, Waterbury, CT 06708
Contact: Peter O'Meara
Phone: 203-232-3473
Email: peter.omeara@therapservices.net
Web: www.therapservices.net

Therap Services provides a full array of electronic documentation services and systems that are web-based and person centered. We can manage documentation workflow for states, counties, and providers as well as enhance communications.

UHEALTH SOLUTIONS

TABLE 20

100 Century Drive, Worcester, MA 01606
Contact: Maura Buckley
Phone: 508-421-5636
Email: mbuckley@uhealthsolutions.org
Web: www.udiscovering.org

Discovering Behavioral Intervention, A Parents Interactive Guide to ABA is an online interactive learning guide to applied behavior analysis. Created by University of Massachusetts Medical School child development experts, DBI features personal stories, it is self-paced and parent friendly!

WESTERN PSYCHIATRIC INSTITUTE AND CLINIC OF UPMC

TABLE 33

3811 O'Hara Street, Pittsburgh, PA 15213
Contact: Wilda DiPietro
Phone: 412-246-66-46
Email: dipietro@upmc.edu
Web: www.upmc.com

The *Center for Autism and Developmental Disorders of Western Psychiatric Institute and Clinic of UPMC* in Pittsburgh, PA, provides family-centered behavioral health care for children, adolescents, and adults with autism spectrum or developmental disorders.

Wyndham Grand Pittsburgh Downtown
 Exhibitors and Poster Sessions Floor Plan

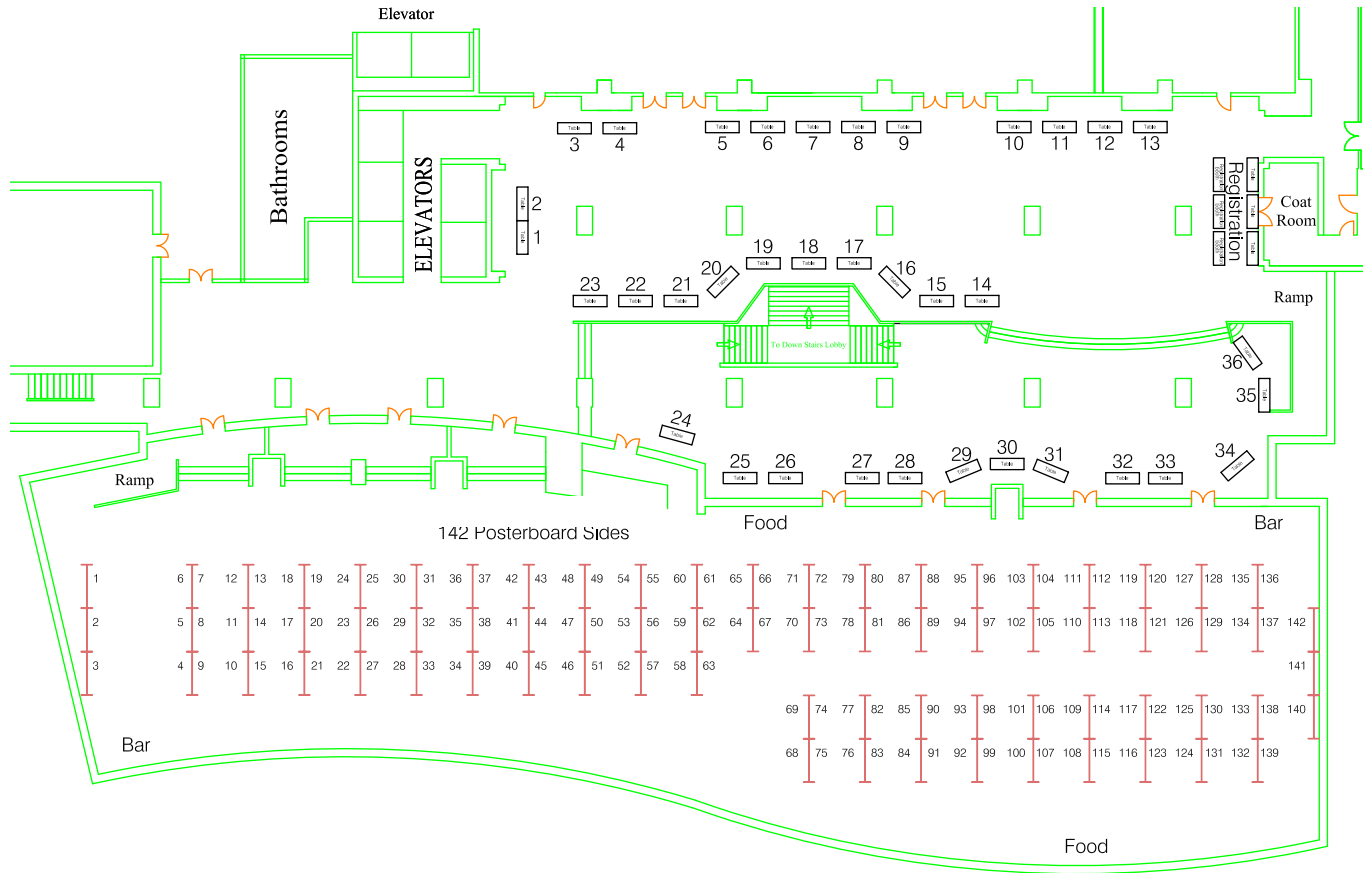

NEW 30-YEAR AAIDD MEMBERS

- | | | |
|-----------------------|------------------------------|------------------------|
| Fred P. Apers | Ronald C. Huff, PhD | Jill J. Niesen, PhD |
| Louis H. Bier | Bradley J. Kotula | Stephen A. Richardson |
| Michael S. Chapman | Edwin M. LaFramboise | David L. Roll, PhD |
| Virginia A. Connolly | Judith Levy, MSW, MA | Richard D. Tryon, MSW |
| Joseph R. Deacon, PhD | W. James McFalls, MA, FAAIDD | Linda C. Veldheer, PhD |
| Eric Emerson, PhD | Lynn J. McMunn PhD | Wanda Willis, MEd |
| | John F. Nicely, MSW | |

Wyndham Grand Pittsburgh Downtown

600 Commonwealth Place

Pittsburgh, PA 15222

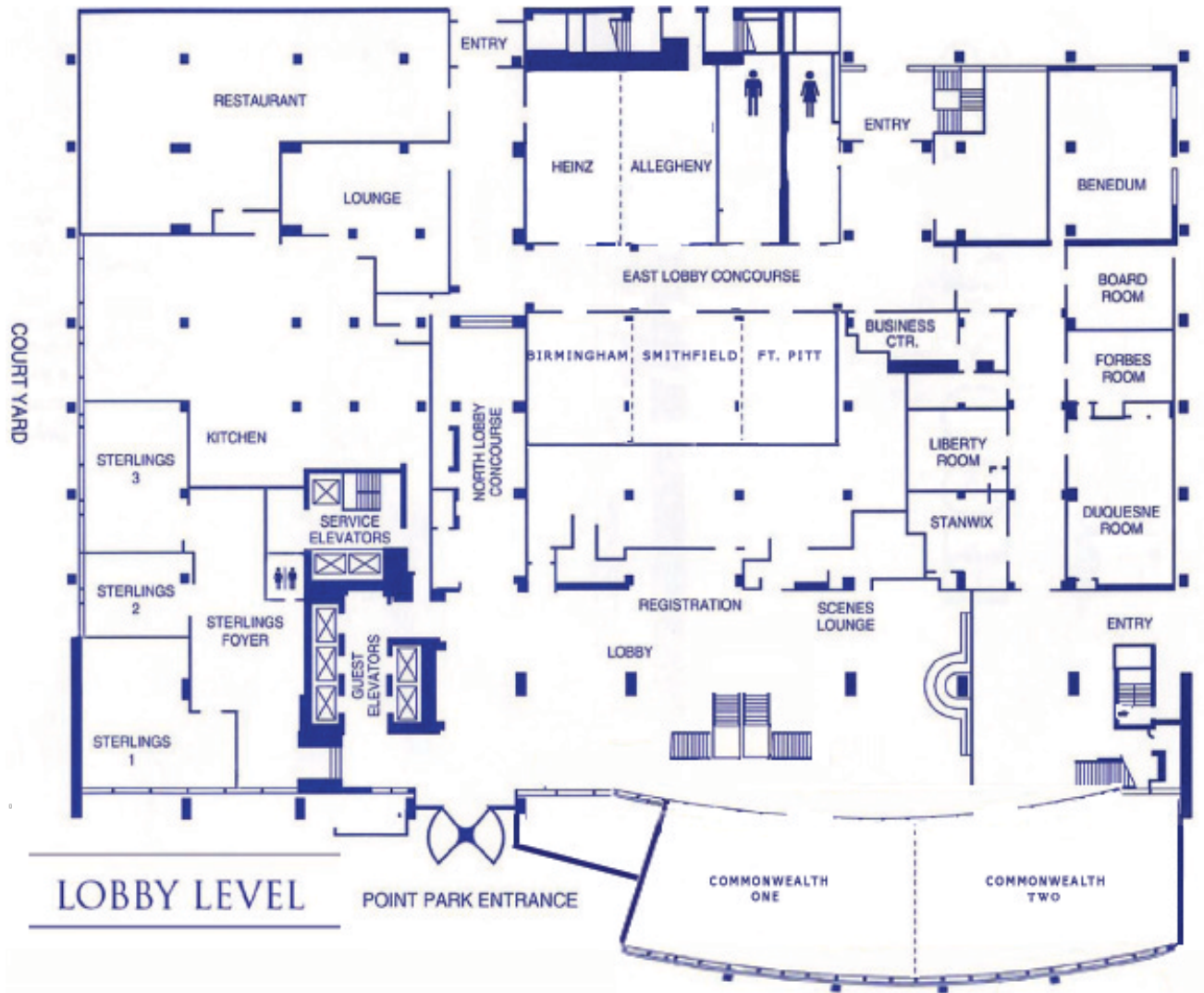

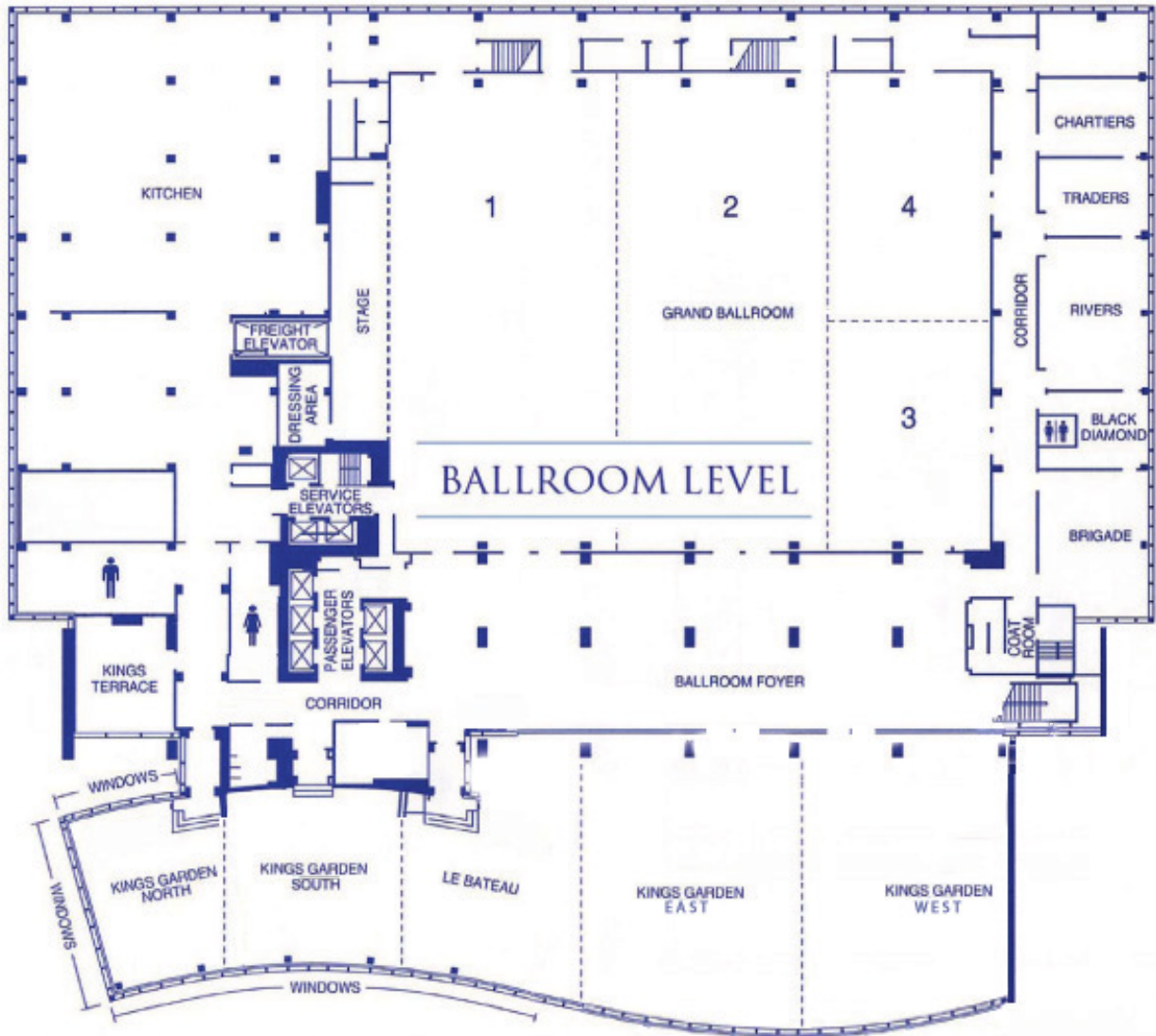



Knowledge | Support | Empowerment

BOARD OF DIRECTORS

Marc J. Tassé, PhD

President

James Thompson, PhD

President-Elect

Amy S. Hewitt, PhD

Vice President

Patti N. Martin, MEd

Secretary/Treasurer

Sharon C. Gomez

Immediate Past President

MEMBERS-AT-LARGE

Denis W. Keyes, PhD

Loui Lord Nelson, PhD

Elizabeth Perkins, PhD

Peter J. Smith, MD, MA

Margaret A. Nygren, EdD

Executive Director

EDITORS

Leonard J. Abbeduto, PhD

Glen T. Fujiura, PhD

Michael L. Wehmeyer, PhD

Karrie Shogren, PhD

AAIDD PERSONNEL

Paul D. Aitken, CPA

Maria A. Alfaro

Jason Epstein

Michelle Hart

Saihanjula He, MA

Natalie Holtz

Ravita Maharaj, PhD

Ajith Mathew

Lisa M. O'Hearn, MA

Danielle Webber, MSW

Michael Winfield

PROFESSIONAL GROUPS LEADERSHIP

Administration Division

Carole Smith

Creative Arts Therapies SIG

Howard J. Miller

Direct Support Professionals Division

Phil Garner

Education Division

Amy Rosenstein & Mary Pearson

Gerontology Division

Nancy Jokinen

Health & Wellness Action Network

Joseph O'Grady

Humanism Action Network

James R. Mullin

International SIG

Marco Lombardi

Legal Process & Advocacy

Caroline Everington

Mental Health Services SIG

Vincent M. Chesney

Psychology Division

Cynthia Klubnik & Deborah Fisher

Religion & Spirituality Division

Anne Masters

Research Division

Yona Lunsky

Social Work Division

Barbara Hanley

Sexual/Social Concerns SIG

Leslie Walker-Hirsch

Student & Early Career

Professionals SIG

Melissa DiSipio & Judith Gross

Technology SIG

Daniel K. Davies

CHAPTER AND REGIONAL LEADERSHIP

REGION II

California: Bonnie R. Kraemer

Nevada: Joan Cooper

Region Chair: Krysti DeZonia

REGION IV

Alberta: Kathleen Biersdorff

Colorado: David A. Ervin

New Mexico: Javier Aceves

Utah: Lorie Domina

Wyoming: Lee Allen

Region Chair: Cordelia C. Robinson

REGION V

Arkansas: Dwight Sowell

Kansas: Susan B. Palmer

Louisiana: Hilda L. Trahan

Missouri: Amanda George

Oklahoma: John F. Gajda

Texas: Dion White

Region Chair: Ellis Craig

REGION VI

Illinois: Donna C. Ennis

Indiana: Kimberly Jaroszewski

Michigan: David Pankotai

Ohio: James D. Dunne

Ontario: Ashleigh Molloy

Wisconsin: Jeff Vogt

Region Chair: Linda A. Draayers

REGION VII

Alabama: DeAnna Ferguson

Florida: Emma C. Guilarte

Georgia: Mickie B. Muroff

Mississippi: Jessey R. Higdon

North Carolina: Lynn A. Ahlgrim-Delzell

South Carolina: Nikki Bramlett

Tennessee: James Warchol

Region Chair: Eric A. Evans

REGION VIII

Iowa: Susan Koch-Seehase

Nebraska: Benjamin Patch Jr.

North Dakota: Paul D. Kolstoe

South Dakota: Carl K. Edwards

REGION IX

Bermuda: Ellen E. Douglas

Maryland: Jennifer Wagner

New Jersey: Sidney W. Blanchard

Pennsylvania: Michael L. Powanda

West Virginia: Gabriel A. Nardi

Region Chair: Paul F. Spangler

REGION X

Connecticut: Elisa F. Velardo

Maine: Richard L. Dorian

Massachusetts: Suzanne Freeze

New Hampshire: Terrence Macy

New York: Lester G. Parker Jr.

Nova Scotia, Prince Edward Island, & Quebec:

Yves Lachapelle

Rhode Island: Kathleen A. Ellis

Vermont: Terrence Macy

Region Chair: A. Michael Bloom



PAST PRESIDENTS

The history of the AAIDD is long and distinguished.
Our tradition, professional standing, and leadership in the area of intellectual and
Developmental disabilities are exemplified in the persons of our Presidents.

Our former Presidents are:

1876-1877	Edouard Sequin, MD	1922-1923	C. Banks McNairy, MD	1967-1968	Harvey F. Dingman, PhD
1877-1878	Hervey B. Wilbur, MD	1923-1924	Walter E. Fernald, MD	1968-1969	Richard Koch, MD
1878-1879	G. A. Doren, MD	1924-1925	Groves B. Smith, MD	1969-1970	Wesley D. White, EdD
1879-1880	H. M. Knight, MD	1925-1926	Arthur R.T. Wylie, MD	1970-1971	Horace Mann, PhD
1880-1881	Charles T. Wilbur, MD	1926-1927	Benjamin W. Baker, MD	1971-1972	Robert L. Erdman, EdD
1881-1882	George W. Brown, MD	1927-1928	Edward R. Johnstone	1972-1973	Michael J. Begab, PhD
1882-1884	J.Q.A. Stewart, MD	1928-1929	George E. McPherson, MD	1973-1974	David Rosen, MS
1884-1885	A.H. Beaton, MD	1929-1930	George L. Wallace, MD	1974-1975	James D. Clements, MD
1885-1886	F.M. Powell, MD	1930-1931	H.H. Ramsey, MD	1975-1976	Sue Allen Warren, PhD
1886-1887	William B. Fish, MD	1931-1932	Harvey M. Watkins, MD	1976-1977	Burton Blatt, EdD
1887-1888	George H. Knight, MD	1932-1933	Howard W. Potter, MD	1977-1978	Margaret J. Giannini, MD
1888-1889	J. C. Carson, MD	1933-1934	Ransom A. Greene, MD	1978-1979	Richard C. Scheerenberger, PhD
1889-1890	A.C. Rogers, MD	1934-1935	Mary M. Wolfe, MD	1979-1980	Marjorie H. Kirkland, MSSW
1890-1891	J. T. Armstrong, MD	1935-1936	Edgar A. Doll, PhD	1980-1981	H. Carl Haywood, PhD
1891-1892	Isaac N. Kerlin, MD	1936-1937	Benjamin O. Whitten, MD	1981-1982	Frank A. Borreca, EdD
1892-1893	Walter E. Fernald, MD	1937-1938	Harry C. Storrs, MD	1982-1983	A. Gail O'Connor, PhD
1893-1894	A.E. Osborne, MD	1938-1939	Neil A. Dayton, MD	1983-1984	Herbert J. Grossman, MD
1894-1895	A.W. Wilmarth, MD	1939-1940	Frederick Kuhlmann, PhD	1984-1985	B.R. (Bill) Walker, PhD
1895-1896	Samuel J. Fort, MD	1940-1941	Meta L. Anderson, PhD	1985-1986	H. Rutherford Turnbull III, LLB, LLM
1896-1897	Martin W. Barr, MD	1941-1942	Fred O. Butler, MD	1986-1987	Harold Michal-Smith, PhD
1897-1898	George A. Brown, MD	1942-1943	Horatio M. Pollock, PhD	1987-1988	Valaida S. Walker, EdD
1898-1899	Mary J. Dunlap, MD	1943-1944	C. Stanley Raymond, MD	1988-1989	Robert G. Griffith, EdD
1899-1900	Alexander Johnson	1944-1945	E. Arthur Witney, MD	1989-1990	James W. Ellis, JD
1900-1901	W.A. Polglase, MD	1945-1946	Mabel A. Matthews	1990-1991	Robert R. Bruininks, PhD
1901-1902	F.W. Keating, MD	1946-1947	Warren G. Murray, MD	1991-1992	Jack A. Stark, PhD
1902-1903	J.M. Murdoch, MD	1947-1948	Lloyd N. Yepsen, PhD	1992-1993	Michael R. Dillon, EdD
1903-1904	Edward R. Johnstone	1948-1949	Edward J. Humphreys, MD	1993-1994	David L. Braddock, PhD
1904-1905	A.H. Beaton, MD	1949-1950	Mildred Thomson	1994-1995	Karen L. Middendorf
1905-1906	George Mogridge, MD	1950-1951	Richard H. Hungerford	1995-1996	William E. Kiernan, PhD
1906-1907	W.H.C. Smith, MD	1951-1952	Edward J. Engberg, MD	1996-1997	Pamela C. Baker, PhD
1907-1908	Charles Bernstein, MD	1952-1953	Bertha M. Luckey, PhD	1997-1998	Robert L. Schalock, PhD
1908-1909	W.N. Bullard, MD	1953-1954	Arthur T. Hopwood, MD	1998-1999	Stanley S. Herr, J.D., DPhil
1909-1910	Miss Mattie Gundry	1954-1955	Gale H. Walker, MD	1999-2000	Bernard R. Wagner, PhD
1910-1911	Arthur R.T. Wylie, MD	1955-1956	Arthur E. Westwell, DMD	2000-2001	Cathy Ficker Terrill, MS
1911-1912	H.G. Hardt, MD	1956-1957	Thomas L. McCulloch, PhD	2001-2002	Steven F. Warren, PhD
1912-1913	Allan E. Carrol, MD	1957-1958	Chris J. DeProspro, EdD	2002-2003	Ruth A. Luckasson, JD
1913-1914	J.K. Kutnewsky, MD	1958-1959	George Tarjan, MD	2003-2004	Ann P. Turnbull, EdD
1914-1915	H.H. Goddard, PhD	1959-1960	Frances M. Coakley	2004-2005	David L. Coulter, MD
1915-1916	Charles Bernstein, MD	1960-1961	Edward L. Johnstone	2005-2006	Valerie J. Bradley, MA
1916-1917	E.J. Emerick, MD	1961-1962	Herschel W. Nisonger	2006-2007	Henry "Hank" Bersani, Jr, PhD
1917-1918	George L. Wallace, MD	1962-1963	William Sloan, PhD	2007-2008	David A. Rotholz, PhD
1918-1919	Charles S. Little, MD	1963-1964	George L. Wadsworth, MD	2008-2009	Steven M. Eidelman, MSW
1919-1920	George S. Bliss, MD	1964-1965	Harvey A. Stevens	2009-2010	Joanna L. Pierson, PhD
1920-1921	H. A. Haynes, MD	1965-1966	I. Ignacy Goldberg, EdD	2010-2011	Michael L. Wehmeyer, PhD
1921-1922	Joseph H. Ladd, MD	1966-1967	Marguerite J. Hastings	2011-2012	Sharon C. Gomez

FORTHCOMING PUBLICATIONS



Clinical Judgment
Second Edition

*Robert L. Schalock and
Ruth Luckasson*

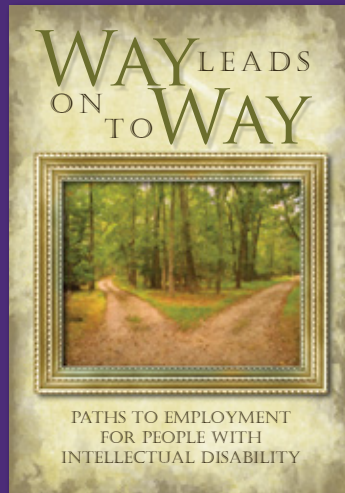

Way Leads on to Way
Paths to Employment
for People with
Intellectual Disability

AAIDD

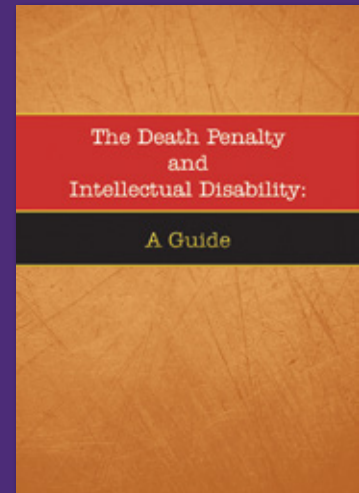

The Death Penalty and
Intellectual Disability:
A Guide

Edited by Ed Polloway

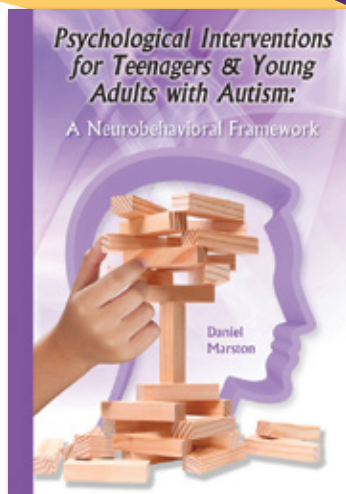

Psychological Interventions
for Teenagers & Young
Adults with Autism:
A Neurobehavioral Framework

Daniel Marston

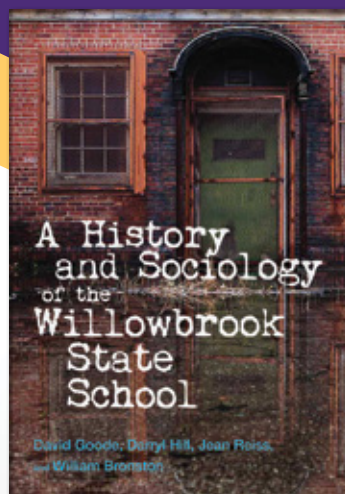

A History and Sociology of the
Willowbrook State School

*David Goode, Darryl Hill,
Jean Reiss, and William Bronston*

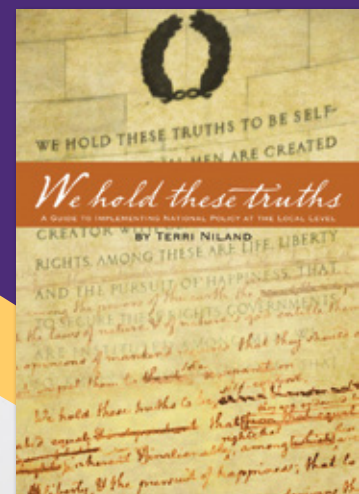

We Hold These Truths...
A Guide to Implementing
National Policy at the
Local Level

Terri Niland

AAIDD.ORG